

# 1900 Certified Sanborn Map

The certified Sanborn Library search results in this report can be authenticated by visiting [www.edrnet.com/sanborn](http://www.edrnet.com/sanborn) and entering the certification number. Only Environmental Data Resources Inc. (EDR) is authorized to grant rights for commercial reproduction of maps by The Sanborn Library LLC, the copyright holder for the collection.

Certification #

CD21-478A-A144

Site Name: Calumet \* Hecla Power Plant  
Address: 5371 M-26  
City, ST, ZIP: Lake Linden MI 49945  
Client: Weston Solutions, Inc.  
EDR Inquiry: 2735439-3  
Order Date: 4/2/2010 2:06:00 PM  
Certification # CD21-478A-A144

Copyright: 1900



This Certified Sanborn Map combines the following sheets (thumbnails on page 3).



Volume 1, Sheet 5  
Volume 1, Sheet 5

0 Feet 150 300 600



# 1893 Certified Sanborn Map

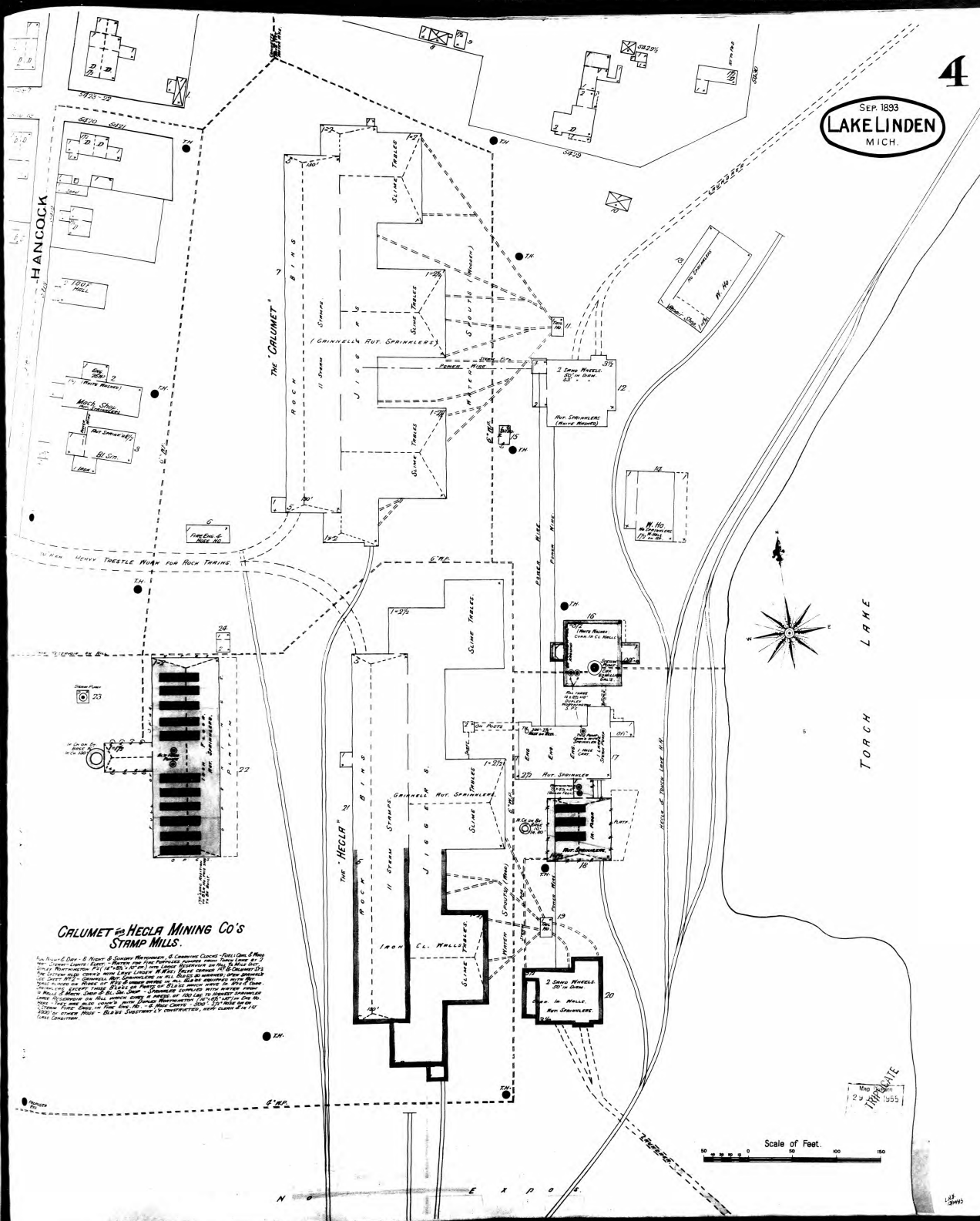

The certified Sanborn Library search results in this report can be authenticated by visiting [www.edrnet.com/sanborn](http://www.edrnet.com/sanborn) and entering the certification number. Only Environmental Data Resources Inc. (EDR) is authorized to grant rights for commercial reproduction of maps by The Sanborn Library LLC, the copyright holder for the collection.

CD21-478A-144

Certification #

© Sanborn Co., EDR Sanborn, Inc. 1893

Site Name: Calumet & Hecla Power Plant  
Address: 5371 M-26  
City, ST, ZIP: Lake Linden MI 49945  
Client: Weston Solutions, Inc.  
EDR Inquiry: 2735439.3  
Order Date: 4/2/2010 2:06:00 PM  
Certification #: CD21-478A-144

Copyright: 1893

2735439 - 3 page



# 1893 Certified Sanborn Map

The certified Sanborn Library search results in this report can be authenticated by visiting [www.edrnet.com/sanborn](http://www.edrnet.com/sanborn) and entering the certification number. Only Environmental Data Resources Inc. (EDR) is authorized to grant rights for commercial reproduction of maps by The Sanborn Library LLC, the copyright holder for the collection.

Certification #

CD21-478A-A144

Site Name: Calumet \* Hecla Power Plant  
Address: 5371 M-26  
City, ST, ZIP: Lake Linden MI 49945  
Client: Weston Solutions, Inc.  
EDR Inquiry: 2735439-3  
Order Date: 4/2/2010 2:06:00 PM  
Certification # CD21-478A-A144



Copyright: 1893

This Certified Sanborn Map combines the following sheets (thumbnails on page 3).

0 Feet 150 300 600

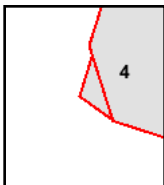

Volume 1, Sheet 4  
Volume 1, Sheet 4

