



June 14, 2011

Mr. Steve Spurlin  
On-Scene Coordinator (OSC)  
U.S. Environmental Protection Agency, Region 4  
Ed Jones Federal Building  
109 South Highland Avenue, B-13  
Jackson, TN 38301

**Subject: Final Removal Action Letter Report  
Kerr McGee Chemical (Columbus) Removal  
Columbus, Lowndes County, Mississippi  
Contract No.: EP-W-05-054  
TDD Nos.: TTEMI-05-001-0154 and TTEMI-05-003-0104**

Dear Mr. Spurlin:

The Tetra Tech EM Inc. (Tetra Tech) Superfund Technical Assessment and Response Team (START) is submitting this letter report summarizing the removal site evaluation and removal action activities conducted from October 26, 2010 to May 5, 2011 at the Kerr McGee Chemical site located in Columbus, Lowndes County, Mississippi (Kerr McGee Columbus) site. Enclosure 1 contains figures illustrating the site location and layout as well as areas of excavation. Enclosure 2 contains tables summarizing analytical results for samples collected during activities conducted at the site. Enclosure 3 contains a photographic log. Enclosure 4 contains a copy of the Tetra Tech START logbook notes. Enclosure 5 contains a table of witnesses. Enclosure 6 contains copies of the analytical data packages for samples collected during removal activities. Enclosure 7 contains the disposal manifests for the material removed from property parcels. Enclosure 8 contains two videos depicting pre-removal foundation conditions at 1009 Moss Street and pre-removal road conditions on Moss Street.

## **SITE BACKGROUND**

The Kerr McGee Columbus site is a former creosote wood preserving facility occupying approximately 90 acres, and is located at 2300 North 14<sup>th</sup> Avenue in Columbus, Mississippi (see Figure 1 in Enclosure 1). The facility operated from 1928 until 2003 and manufactured pressure-treated railroad products such as wooden cross ties, switch ties, and timbers using several preservatives, including pentachlorophenol (PCP), creosote, and creosote coal tar solutions. Hazardous substances are suspected to have been released from the site into surrounding drainage pathways that flow through residential and commercial areas. The drainage pathways are prone to flooding. The facility is closed and all structures located on the property have been decommissioned and dismantled, with the exception of one building used to house equipment for a groundwater treatment system currently being operated by a bankruptcy trustee. Previously, Tetra Tech performed work for the U.S. Environmental Protection Agency (EPA) for this site under TDD Nos. TTEMI-05-003-0096 and TTEMI-05-003-0104, which included the preparation of a Hazard Ranking System Documentation Record and the performance of a removal site evaluation.

## REMOVAL SITE EVALUATION

In October 2010, the U.S. EPA Emergency Response and Removal Branch (ERRB) initiated a Removal Site Evaluation (RSE) focused on evaluating properties along the drainage pathways and in close proximity to the site which may have been impacted by hazardous substances as a result of flooding or past facility operations.

During the week of October 25, 2010, representatives of the EPA Region 4 Science and Ecosystem Support Division (SESD) collected soil samples from residential and community properties adjacent to the Kerr McGee Columbus site. The objective of the sampling investigation was to provide supporting data to aid EPA Region 4 in determining if soil in the surrounding neighbourhoods had been impacted by operations at the former Kerr McGee Columbus facility. The sampling results have been reviewed by an EPA Region 4 human health risk assessor who compared detected chemical constituents with the applicable Regional Screening Levels (RSLs). RSLs are conservative, long-term risk-based screening values developed by EPA to help identify contaminants of potential concern. Constituents reported at levels above their respective RSLs for residential surface soil were then compared against their respective Removal Action Levels (RALs). RALs are risk-based screening values developed by EPA to determine whether sample concentrations are sufficiently elevated that they may warrant a removal action. Exceedance of an RAL by itself does not imply that adverse health effects will occur.

SESD collected 49 soil samples from 39 properties. Samples were collected from residential and public properties (churches, a cemetery, a school) adjacent to the Kerr McGee Columbus site. Forty-six composite surface soil samples were collected from 43 sampling stations. Several properties had multiple sample stations. The surface soil samples were collected from a depth of 0 – 3 inches. Subsurface soil samples were collected from three residential properties at a depth of 12 – 15 inches to monitor whether subsurface soil had been impacted by site activities. It should be noted that Station TN09 was a location previously sampled (surface soil only) by the EPA Resource Conservation and Recovery Act (RCRA) Division. Due to the variation in size of the properties, the samplers used an authoritative design to determine aliquot numbers and locations. The goal was to yield a sample representative of the potential contamination of each property. Generally, the samples consisted of five aliquots; however, at times, the number and locations of the soil aliquots were adjusted because investigators avoided collecting samples from areas that could be potentially impacted from residential activities such as rubbish burning. Samples were analyzed by a contract laboratory for semi-volatile organic compounds (SVOC) and dioxins.

SESD previously collected soil and sediment samples for SVOCs and dioxin analyses from residential properties and ditches adjacent to the site in April 2010 for the EPA Region 4 RCRA Division prior to EPA Superfund involvement.

The April 2010 RCRA data for the composite surface soil sample and its duplicate sample collected at a residential property (sample TN09) indicated benzo(a)pyrene results of 1.8 milligrams-per-kilogram (mg/kg) and 2.6 mg/kg, respectively. The RAL for benzo(a)pyrene is 1.5 mg/kg. A sample collected during the ERRB October 2010 sample at the Hunt Intermediate School property indicated a benzo(a)pyrene detection of 4.8 mg/kg. An EPA quality assurance review of the October 2010 data identified a potential data quality issue for one dioxin congener. To address this data issue, EPA decided to re-sample for dioxin at all properties sampled in October 2010. Additional sampling was also needed at the school to define the extent of the benzo(a)pyrene contamination.

On February 15, 2011, EPA returned to the Kerr McGee Columbus site to conduct the dioxin re-sampling and to determine the extent of potential contamination at the school. Additionally, samples were

collected at three locations identified by a community representative based on concerns about potential exposure to children at the locations. The locations included a residential property, an apartment, and an area of a public park. Final SVOC results for the February sampling indicated no additional areas exceeding SVOC RALs. EPA considered the data results from the April 2010, October 2010, and February 2011 sampling in determining the need to conduct a time critical removal action at the site. All final sample results can be found at [www.epaosc.org/KerrMcGeeChemical](http://www.epaosc.org/KerrMcGeeChemical).

## EMERGENCY RESPONSE

On February 14, 2011, the U.S. EPA was in Columbus, Mississippi to conduct dioxin re-sampling associated with the ongoing EPA Superfund Removal Program RSE related to the Kerr McGee Chemical Columbus Site. The first property to be sampled was a church located at 716 Waterworks Road, Columbus, Mississippi. Upon arriving at the property, OSC Spurlin met with a technical representative for the property owner. The representative escorted OSC Spurlin to a soil pile on the property. A large culvert, consisting of a modified rail car, formerly sat at the location of the pile. The culvert had been removed from the ditch that traverses the property in approximately 1998. This ditch has been impacted by past releases of creosote from the former Kerr McGee facility located at 2300 North 14<sup>th</sup> Avenue, Columbus, Mississippi. The pile contained a mix of soil and creosote material.

The pile was not covered, and the property is accessible to the public. On February 15, 2011, OSC Spurlin was informed by the property owner that he had cut up and sold the culvert as scrap metal several months earlier. The cutting and moving of the culvert resulted in the generation of the waste pile. Additional information regarding the emergency response can be found in the Emergency Response Action Memorandum dated February 28, 2011 located at [www.epaosc.org/KerrMcGeeChemical](http://www.epaosc.org/KerrMcGeeChemical).

Based on the presence of the creosote-contaminated soil pile at the Maranatha Faith Center, OSC Spurlin initiated an emergency response and mobilized the EPA's Emergency and Rapid Response Services (ERRS) contractor (WRScompass) to clean up the pile. On February 17, 2011, ERRS personnel excavated a total of approximately 30.93 tons of contaminated soil from the church property, which was placed in two roll off containers that were transported to the Kerr McGee Columbus facility for secure storage until disposal arrangements were finalized. Figure 2 of Enclosure 1 illustrates the area of excavation. Ultimately, the contaminated soil was transported to the Golden Triangle Waste Services Subtitle D (Golden Triangle) landfill in Columbus, Mississippi as part of the subsequent time-critical removal initiated April 11, 2011. The waste was designated as non-hazardous under RCRA. Disposal manifests are located in Enclosure 7.

## REMOVAL ACTION

Following an evaluation of the analytical results performed by EPA risk assessment personnel, EPA again mobilized to the site in April 2011 to conduct a removal action at the two properties where benzo(a)pyrene was identified at concentrations exceeding the RALs. Figures 3 and 4 of Enclosure 1 illustrate the areas of excavation. Tables 1 and 2 of Enclosure 2 provide a summary of the analytical results for confirmation soil samples collected during the removal action as well as calculations providing the toxicity equivalent for the SVOCs of carcinogenic benzo(a)pyrene. The following subsections provide a summary of the removal action activities.

## **Hunt Intermediate School**

On April 13, ERRS personnel began removal action activities at the Hunt Intermediate School by excavating an area measuring approximately 50 feet by 50 feet in the former football field to a depth of 1 foot below ground surface (bgs). A total of approximately 99.14 tons of soil were removed from this location and transported to the Golden Triangle landfill for disposal as non-hazardous waste under RCRA. Tetra Tech collected one five-point composite confirmation soil sample from the bottom of the excavation. The sample was shipped for laboratory analysis of PAHs, and the analytical results confirmed that no analytes were present at concentrations exceeding the RALs. Restoration activities conducted at this location included the placement of backfill (clay overlain by topsoil), and the spreading of grass seed and hay to promote growth of vegetation and provide erosion control. In addition, crushed stone that was placed at this location to provide a driving surface for vehicles to access the area of excavation was removed and stockpiled at the Kerr McGee Columbus facility for future use. Removal action activities at the Hunt Intermediate School were completed on April 14, 2011.

## **1009 Moss Street**

On April 15, ERRS personnel began removal action activities at the residential property located at 1009 Moss Street. The area of excavation primarily included the northeastern portion of the property, and extended to a depth of 1 foot bgs throughout the area, except within 2 feet of the house foundation and beneath the drip line of trees, where depths of excavation extended to only 6 inches bgs or shallower to avoid damaging the foundation or trees. A total of approximately 148.6 tons of soil were removed from this location and transported to the Golden Triangle landfill for disposal as non-hazardous waste under RCRA. Tetra Tech collected one five-point composite confirmation soil sample from the bottom of the excavation as well as one sample from the surface of the driveway, which were shipped for laboratory analysis of PAHs. The analytical results confirmed that no analytes were present at concentrations exceeding the RALs. Restoration activities conducted at this location included the placement of backfill and sod in the area of excavation as well as the spreading of grass seed and hay in areas that were not excavated but were disturbed by ERRS's equipment used during the removal action. In addition, an earthen berm that was present between the residence and nearby creek prior to removal action activities was repaired and lengthened, and a drain pipe leading from the low point of the yard to the creek was installed to help mitigate flood concerns at the property. A sprinkler and hose were provided to the resident for watering the sod. Removal action activities at 1009 Moss Street were completed on April 25, 2011.

## **Particulate Air Monitoring and Backfill Source Characterization Sampling**

During excavation activities, Tetra Tech conducted particulate air monitoring at each location to ensure the safety of the surrounding residents and site workers. No particulate levels of concern were observed at either the Hunt Intermediate School or the property at 1009 Moss Street.

Prior to the placement of backfill in areas of excavation, OSC Spurlin and Tetra Tech visited the Ronnie Jones Construction facility located in Caledonia, Mississippi to collect five-point composite samples from the proposed sources of backfill materials to be used at the impacted properties. Tetra Tech collected a total of two samples, including one collected from the clay material and one collected from the topsoil designated as Type 2 topsoil. Both samples were shipped for laboratory analysis of RCRA metals and PAHs. Analytical results confirmed that no analytes were present at concentrations exceeding the RALs.



## Maranatha Faith Center

During the removal action, the minister of the Maranatha Faith Center contacted OSC Spurlin and expressed concerns that children could potentially be playing in the open ditch on the church property. Although the nature and extent of contamination in the ditch had not yet been fully investigated, historical information indicated a likelihood of contamination. As a result, OSC Spurlin directed ERRS personnel to erect a fence along the portion of the ditch crossing the church's property to restrict access. Installation of the fence was completed on May 5, 2011, completing the site removal action activities.

## DATA VALIDATION

Tetra Tech START conducted data validation of the analytical results for five soil samples (including two backfill samples) that were collected at the former Kerr McGee Chemical (Columbus) site. The soil samples were submitted to Xenco Laboratories, Inc., of Norcross, Georgia. The soil samples were analyzed for RCRA metals by SW-846 Methods 6010C and 7471B, and PAHs by SW-846 Method 8270D. Only the backfill samples received RCRA metals analyses.

A Stage 2A review of the analytical data associated with the samples was performed in accordance with the EPA Contract Laboratory Program (CLP) National Functional Guidelines (NFG) for Superfund Organic Methods Data Review (June 2008) and the EPA CLP NFG for Inorganic Superfund Data Review (January 2010). The only quality control issue observed during the analysis of the soil samples was relative percent differences outside of the acceptance criteria for arsenic and chromium in the laboratory duplicate performed on sample KM-BF-041211-01. Therefore, the arsenic and chromium results for sample KM-BF-041211-01 were considered estimated with an unknown bias (flagged "J").

## CONCLUSION

In April 2010, October 2010, and February 2011, EPA conducted soil sampling at selected properties in the vicinity of the Kerr McGee Columbus site as part of ongoing investigation activities. Analytical results documented the presence of PAHs, particularly benzo(a)pyrene, at concentrations exceeding the RALs at two properties. In addition, a pile of creosote-contaminated soil that originated from a drainage culvert believed to have been impacted by operations from the former Kerr McGee facility was observed on a nearby church property. As a result, OSC Spurlin initiated emergency response and removal activities at the site on February 16, 2011. Activities included the excavation and disposal of a total of approximately 278 tons of contaminated soil as well as the restoration of excavated areas. Removal action activities were completed on May 5, 2011, with the final removal activity consisting of installation of a fence to prevent access to a portion of a drainage ditch suspected to contain contamination.

Mr. S. Spurlin  
June 14, 2011

Please contact me at (678) 775-3118 if you have any questions or need additional copies of this letter report.

Sincerely,



Eric Turner  
START III Site Manager



Andy Johnson  
START III Program Manager

Enclosures (8)

cc: Katrina Jones, U.S. EPA Project Officer  
Angel Reed, START III Document Control Coordinator

## **ENCLOSURE 1**

### **FIGURES**

(Four Pages)











## LEGEND

-  Property Boundary
-  Approximate Extent of Excavation

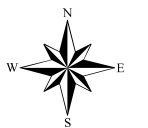

0 20 40 60 80  
Feet

Image Source: USDA NAIP, 2009.

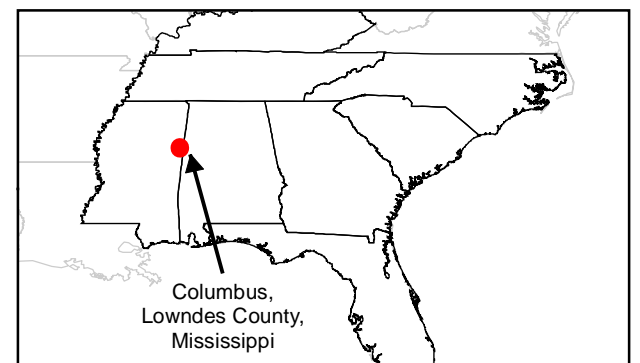

United States Environmental Protection Agency

Kerr McGee Chemical (Columbus) Removal  
Columbus,  
Lowndes County,  
Mississippi  
TDD: TTEMI-05-001-0154

**Figure 2**  
**Excavation Area**  
**Maranatha Church Property**







LEGEND

- Storm Sewer/Culvert
- Approximate Extent of Excavation
- Property Boundary

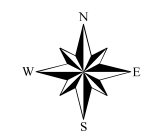

0 20 40 60 80 Feet

Image Source: Lowndes County, 2009.

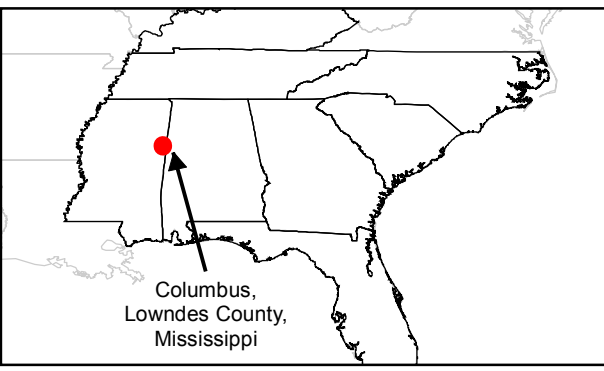



United States Environmental Protection Agency

Kerr McGee Chemical (Columbus) Removal  
Columbus,  
Lowndes County,  
Mississippi  
TDD: TTEMI-05-001-0154

**Figure 3**  
**Excavation Area**  
**Hunt School Property**





TETRA TECH





LEGEND

-  Property Boundary
-  Approximate Extent of Excavation
-  Creek



0 15 30 45 60 Feet

Image Source: USDA NAIP, 2009.

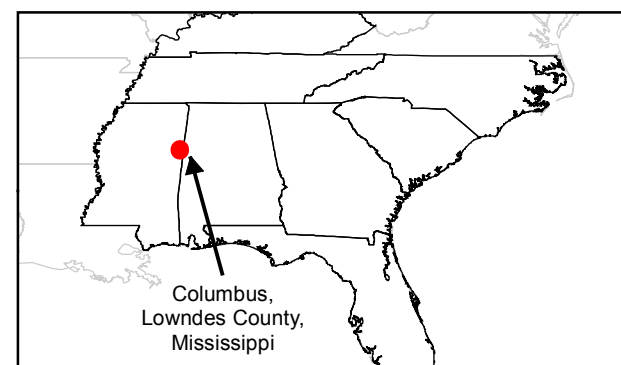



United States Environmental Protection Agency

Kerr McGee Chemical (Columbus) Removal  
Columbus,  
Lowndes County,  
Mississippi  
TDD: TTEMI-05-001-0154

**Figure 4**  
**Excavation Area**  
**1009 Moss Street**



TETRA TECH



## **ENCLOSURE 2**

### **TABLES**

(Two Pages)

**TABLE 1**  
**ANALYTICAL RESULTS**

Analyte	Residential RAL	KMWP02	KM-BF-041211-01	KM-BF-041211-02	KM-12462-B-CS-01	KM-12624-CS-01	KM-12624-DRIVEWAY
<b>Metals (mg/kg)</b>							
Arsenic	38.9	NA	4.06 J	2.68 J	NA	NA	NA
Barium	164,000	NA	49.5	41.6	NA	NA	NA
Cadmium	729	NA	0.761	0.657	NA	NA	NA
Chromium	27,600	NA	31.5 J	10.8	NA	NA	NA
Lead	400	NA	10.4	8.04	NA	NA	NA
Mercury	20.0	NA	2.83 J	2.22 J	NA	NA	NA
<b>Polynuclear Aromatic Hydrocarbons (µg/kg)</b>							
1-Methylnaphthalene	2,200,000	NA	7.5 U	7.4 U	7.9 U	3.4 J	2.1 J
2-Methylnaphthalene	3,290,000	18 U	7.5 U	7.4 U	7.9 U	7.6 J	3.8 J
Acenaphthene	34,900,000	18 U	7.5 U	7.4 U	7.9 U	8.0	6.9 U
Acenaphylene	NL	18 U	7.5 U	7.4 U	3.2 J	370	28
Anthracene	175,000,000	18 U	7.5 U	7.4 U	6.3 J	360	27
Benzo(a)anthracene	8,980	56	7.5 U	7.4 U	21	320	28
Benzo(a)pyrene	1,480	43	7.5 U	7.4 U	22	500	38
Benzo(b)fluoranthene	8,980	78 J+	7.5 U	7.4 U	27	610	75
Benzo(g,h,i)perylene	NL	24 U	7.5 U	7.4 U	22	380	41
Benzo(k)fluoranthene	8,980	73	7.5 U	7.4 U	17	460	43
Chrysene	89,800	68	7.5 U	7.4 U	21	390	47
Dibenzo(a,h)anthracene	2,630	13 J	7.5 U	7.4 U	4.7 J	110	9.7
Fluoranthene	23,300,000	140	7.5 U	7.4 U	36	390	54
Fluorene	23,300,000	18 U	7.5 U	7.4 U	2.8 J	18	2.8 J
Indeno(1,2,3-cd)pyrene	8,980	63 J+	7.5 U	7.4 U	14	400	34
Naphthalene	389,000	18 U	15	7.4 J	3.9 J	16	4.8 J
Phenanthrene	NL	42	7.5 U	7.4 U	21	46	18
Pyrene	17,500,000	84 J-	7.5 U	7.4 U	34	460	53
<b>cBAP</b>	8,980	76	0.0	0.0	33	750	62

Notes:

cBAP Carcinogenic benzo(a)pyrene

J The identification of the analyte is acceptable; the reported value is an estimate.

J+ The identification of the analyte is acceptable; the reported value is an estimate with a possible high bias.

J- The identification of the analyte is acceptable; the reported value is an estimate with a possible low bias.

µg/kg Micrograms per kilogram

mg/kg Milligrams per kilogram

NA Not analyzed

NL Not listed

RAL EPA Region 4 Residential Soil Removal Action Level

U The analyte was not detected at or above the reporting limit.

**TABLE 2**  
**FINAL cBAP CALCULATIONS**

Compound	TEF	KMWP02		KM-BF-041211-01		KM-BF-041211-02	
		Result	Calculation	Result	Calculation	Result	Calculation
SVOCs (µg/kg)							
Benzo(a)anthracene	0.1	56	5.6	0	0	0	0
Benzo(a)pyrene	1	43	43	0	0	0	0
Benzo(b)fluoranthene	0.1	78	7.8	0	0	0	0
Benzo(k)fluoranthene	0.01	73	0.73	0	0	0	0
Chrysene	0.001	68	0.068	0	0	0	0
Dibenzo(a,h)anthracene	1	13	13	0	0	0	0
Indeno(1,2,3-cd)pyrene	0.1	63	6.3	0	0	0	0
Total cBAP TEQ			76	0.0		0.0	

Compound	TEF	KM-12462-B-CS-01		KM-12624-CS-01		KM-12624-DRIVEWAY	
		Result	Calculation	Result	Calculation	Result	Calculation
SVOCs (µg/kg)							
Benzo(a)anthracene	0.1	21	2.1	320	32	28	2.8
Benzo(a)pyrene	1	22	22	500	500	38	38
Benzo(b)fluoranthene	0.1	27	2.7	610	61	75	7.5
Benzo(k)fluoranthene	0.01	17	0.17	460	4.6	43	0.43
Chrysene	0.001	21	0.021	390	0.39	47	0.047
Dibenzo(a,h)anthracene	1	4.7	4.7	110	110	9.7	9.7
Indeno(1,2,3-cd)pyrene	0.1	14	1.4	400	40	34	3.4
Total cBAP TEQ			33		748		62

Notes:

cBAP

µg/kg

TEF

TEQ

Carcinogenic benzo(a)pyrene

Micrograms per kilogram

Toxicity equivalency factor

Toxic equivalent

**ENCLOSURE 3**

**PHOTOGRAPHIC LOG**

(25 Pages)



**OFFICIAL PHOTOGRAPH NO. 1**  
**U.S. ENVIRONMENTAL PROTECTION AGENCY (EPA)**

**TDD Number:** TTEMI-05-003-0104

**Location:** Maranatha Faith Center  
Columbus, Mississippi

**Orientation:** South

**Date:** February 16, 2011

**Photographer:** Kyle Russell, Tetra Tech

**Witness:** None

**Subject:** Pile of creosote-contaminated soil that was left on the Maranatha Faith Center property from the removal of former ditch culvert.





**OFFICIAL PHOTOGRAPH NO. 2**  
**U.S. ENVIRONMENTAL PROTECTION AGENCY (EPA)**

**TDD Number:** TTEMI-05-003-0104

**Location:** Maranatha Faith Center  
Columbus, Mississippi

**Orientation:** North

**Date:** February 17, 2011

**Photographer:** Kyle Russell, Tetra Tech

**Witness:** WRScompass (WRS)

**Subject:** WRS personnel removing the creosote-contaminated soil pile. Roll off containers are visible in the background.



**OFFICIAL PHOTOGRAPH NO. 3  
U.S. ENVIRONMENTAL PROTECTION AGENCY (EPA)**

**TDD Number:** TTEMI-05-003-0104

**Location:** Maranatha Faith Center  
Columbus, Mississippi

**Orientation:** North

**Date:** February 17, 2011

**Photographer:** Kyle Russell, Tetra Tech

**Witness:** WRS

**Subject:** WRS personnel nearing completion of the removal of creosote-contaminated soil from the Maranatha Faith Center.





**OFFICIAL PHOTOGRAPH NO. 4  
U.S. ENVIRONMENTAL PROTECTION AGENCY (EPA)**

**TDD Number:** TTEMI-05-003-0104

**Location:** Maranatha Faith Center  
Columbus, Mississippi

**Orientation:** North

**Date:** February 17, 2011

**Photographer:** Kyle Russell, Tetra Tech

**Witness:** WRS

**Subject:** WRS personnel placing backfill to cover the excavated area at the Maranatha Faith Center.





**OFFICIAL PHOTOGRAPH NO. 5**  
**U.S. ENVIRONMENTAL PROTECTION AGENCY (EPA)**

**TDD Number:** TTEMI-05-003-0104

**Location:** Maranatha Faith Center  
Columbus, Mississippi

**Orientation:** South

**Date:** February 17, 2011

**Photographer:** Kyle Russell, Tetra Tech

**Witness:** WRS

**Subject:** WRS completed restoration activities with placement of grass seed on top of backfill where excavation occurred.





**OFFICIAL PHOTOGRAPH NO. 6**  
**U.S. ENVIRONMENTAL PROTECTION AGENCY (EPA)**

**TDD Number:** TTEMI-05-001-0154

**Location:** Maranatha Faith Center  
Columbus, Mississippi

**Orientation:** Southwest

**Date:** May 5, 2011

**Photographer:** Steve Spurlin, EPA

**Witness:** WRS

**Subject:** Fence installed by WRS at the Maranatha Faith Center after OSC was contacted by minister who expressed concerns for children playing in the ditch.



**OFFICIAL PHOTOGRAPH NO. 7**  
**U.S. ENVIRONMENTAL PROTECTION AGENCY (EPA)**

<b>TDD Number:</b>	TTEMI-05-003-0104	<b>Location:</b>	Former Kerr McGee Columbus Facility Columbus, Mississippi
<b>Orientation:</b>	East	<b>Date:</b>	February 17, 2011
<b>Photographer:</b>	Kyle Russell, Tetra Tech	<b>Witness:</b>	None
<b>Subject:</b>	WRS personnel staging roll off containers with contaminated soil from the Maranatha Faith Center at the former Kerr McGee Columbus facility.		





**OFFICIAL PHOTOGRAPH NO. 8  
U.S. ENVIRONMENTAL PROTECTION AGENCY (EPA)**

**TDD Number:** TTEMI-05-003-0104

**Location:** Former Kerr McGee Columbus  
Facility  
Columbus, Mississippi

**Orientation:** Northeast

**Date:** February 17, 2011

**Photographer:** Kyle Russell, Tetra Tech

**Witness:** None

**Subject:** OSC Spurlin directed WRS to replace the tarp covers of two green roll off containers previously staged by facility operator at the former Kerr McGee Columbus facility.



**OFFICIAL PHOTOGRAPH NO. 9**  
**U.S. ENVIRONMENTAL PROTECTION AGENCY (EPA)**

<b>TDD Number:</b>	TTEMI-05-003-0104	<b>Location:</b>	Former Kerr McGee Columbus Facility Columbus, Mississippi
<b>Orientation:</b>	East	<b>Date:</b>	February 17, 2011
<b>Photographer:</b>	Kyle Russell, Tetra Tech	<b>Witness:</b>	None
<b>Subject:</b>	New tarp covers in place on the green roll off containers staged at the former Kerr McGee Columbus facility. The brown roll off containers are from the excavation completed on February 17, 2011 at the Maranatha Faith Center.		





**OFFICIAL PHOTOGRAPH NO. 10**  
**U.S. ENVIRONMENTAL PROTECTION AGENCY (EPA)**

**TDD Number:** TTEMI-05-001-0154

**Location:** Hunt Intermediate School  
Columbus, Mississippi

**Orientation:** Northwest

**Date:** April 13, 2011

**Photographer:** Eric Turner, Tetra Tech

**Witness:** Steve Spurlin, EPA

**Subject:** WRS personnel excavated an area measuring 50 feet by 50 feet at the outdoor classroom at the Hunt Intermediate School to a depth of 1 foot below ground surface.



**OFFICIAL PHOTOGRAPH NO. 11  
U.S. ENVIRONMENTAL PROTECTION AGENCY (EPA)**

**TDD Number:** TTEMI-05-001-0154

**Location:** Hunt Intermediate School  
Columbus, Mississippi

**Orientation:** East

**Date:** April 14, 2011

**Photographer:** Eric Turner, Tetra Tech

**Witness:** Steve Spurlin, EPA

**Subject:** WRS completed excavation at the Hunt Intermediate School and began to backfill the bottom layer with clay fill. PVC irrigation lines were discovered and repaired if damaged. Irrigation lines were not known to exist to the crew prior to excavation.





**OFFICIAL PHOTOGRAPH NO. 12**  
**U.S. ENVIRONMENTAL PROTECTION AGENCY (EPA)**

**TDD Number:** TTEMI-05-001-0154

**Location:** Hunt Intermediate School  
Columbus, Mississippi

**Orientation:** Southeast

**Date:** April 14, 2011

**Photographer:** Eric Turner, Tetra Tech

**Witness:** Steve Spurlin, EPA

**Subject:** WRS personnel placing topsoil over a layer of clay fill in the area of excavation at the Hunt Intermediate School.



**OFFICIAL PHOTOGRAPH NO. 13**  
**U.S. ENVIRONMENTAL PROTECTION AGENCY (EPA)**

<b>TDD Number:</b>	TTEMI-05-001-0154	<b>Location:</b>	Former Kerr McGee Columbus Facility Columbus, Mississippi
<b>Orientation:</b>	Southeast	<b>Date:</b>	April 14, 2011
<b>Photographer:</b>	Eric Turner, Tetra Tech	<b>Witness:</b>	Steve Spurlin, EPA
<b>Subject:</b>	Crushed stone that was used as a driveway to provide access for vehicles to the excavation at the Hunt Intermediate School was removed and stockpiled for future use at the former Kerr McGee facility following site operations.		





**OFFICIAL PHOTOGRAPH NO. 14**  
**U.S. ENVIRONMENTAL PROTECTION AGENCY (EPA)**

**TDD Number:** TTEMI-05-001-0154

**Location:** Hunt Intermediate School  
Columbus, Mississippi

**Orientation:** Southeast

**Date:** April 14, 2011

**Photographer:** Eric Turner, Tetra Tech

**Witness:** Steve Spurlin, EPA

**Subject:** WRS spread grass seed and hay over the excavated area at the Hunt Intermediate School. Workers reinstalling fence are visible in the background of the picture.



**OFFICIAL PHOTOGRAPH NO. 15**  
**U.S. ENVIRONMENTAL PROTECTION AGENCY (EPA)**

<b>TDD Number:</b>	TTEMI-05-001-0154	<b>Location:</b>	Hunt Intermediate School Columbus, Mississippi
<b>Orientation:</b>	West	<b>Date:</b>	April 28, 2011
<b>Photographer:</b>	Steve Spurlin, EPA	<b>Witness:</b>	WRS
<b>Subject:</b>	Grass beginning to grow on backfilled area at the Hunt Intermediate School.		





**OFFICIAL PHOTOGRAPH NO. 16**  
**U.S. ENVIRONMENTAL PROTECTION AGENCY (EPA)**

**TDD Number:** TTEMI-05-001-0154

**Location:** 1009 Moss Street  
Columbus, Mississippi

**Orientation:** North

**Date:** April 13, 2011

**Photographer:** Eric Turner, Tetra Tech

**Witness:** Steve Spurlin, EPA

**Subject:** 1009 Moss Street prior to excavation. A video of a pre-removal site walkthrough was also created showing initial property and foundation conditions.



**OFFICIAL PHOTOGRAPH NO. 17**  
**U.S. ENVIRONMENTAL PROTECTION AGENCY (EPA)**

**TDD Number:** TTEMI-05-001-0154

**Location:** 1009 Moss Street  
Columbus, Mississippi

**Orientation:** Southwest

**Date:** April 13, 2011

**Photographer:** Eric Turner, Tetra Tech

**Witness:** Steve Spurlin, EPA

**Subject:** Moss Street road conditions prior to removal activities. A video was also made capturing the pre-removal road conditions starting from the property and ending where Moss Street meets the creek.





**OFFICIAL PHOTOGRAPH NO. 18**  
**U.S. ENVIRONMENTAL PROTECTION AGENCY (EPA)**

**TDD Number:** TTEMI-05-001-0154

**Location:** 1009 Moss Street  
Columbus, Mississippi

**Orientation:** Southeast

**Date:** April 16, 2011

**Photographer:** Eric Turner, Tetra Tech

**Witness:** Steve Spurlin, EPA

**Subject:** Excavation along the northern property boundary at 1009 Moss Street.



**OFFICIAL PHOTOGRAPH NO. 19**  
**U.S. ENVIRONMENTAL PROTECTION AGENCY (EPA)**

**TDD Number:** TTEMI-05-001-0154

**Location:** 1009 Moss Street  
Columbus, Mississippi

**Orientation:** West

**Date:** April 16, 2011

**Photographer:** Eric Turner, Tetra Tech

**Witness:** Steve Spurlin, EPA

**Subject:** Excavation in the front yard of the residence at 1009 Moss Street.





**OFFICIAL PHOTOGRAPH NO. 20**  
**U.S. ENVIRONMENTAL PROTECTION AGENCY (EPA)**

**TDD Number:** TTEMI-05-001-0154

**Location:** 1009 Moss Street  
Columbus, Mississippi

**Orientation:** East

**Date:** April 18, 2011

**Photographer:** Eric Turner, Tetra Tech

**Witness:** Steve Spurlin, EPA

**Subject:** Excavation in the backyard of 1009 Moss Street. Excavation at this location was conducted with oversight for clearance of the overhead utility lines. Also note the sheets of plywood warning the excavator operator of overhead lines.



**OFFICIAL PHOTOGRAPH NO. 21  
U.S. ENVIRONMENTAL PROTECTION AGENCY (EPA)**

**TDD Number:** TTEMI-05-001-0154

**Location:** 1009 Moss Street  
Columbus, Mississippi

**Orientation:** Northeast

**Date:** April 18, 2011

**Photographer:** Eric Turner, Tetra Tech

**Witness:** Steve Spurlin, EPA

**Subject:** WRS backfilling the residential property with a bottom layer of clay fill.





**OFFICIAL PHOTOGRAPH NO. 22**  
**U.S. ENVIRONMENTAL PROTECTION AGENCY (EPA)**

**TDD Number:** TTEMI-05-001-0154

**Location:** 1009 Moss Street  
Columbus, Mississippi

**Orientation:** Northeast

**Date:** April 21, 2011

**Photographer:** Eric Turner, Tetra Tech

**Witness:** Steve Spurlin, EPA

**Subject:** Heavy rains slowed removal activities at the property during excavation activities.



**OFFICIAL PHOTOGRAPH NO. 23**  
**U.S. ENVIRONMENTAL PROTECTION AGENCY (EPA)**

**TDD Number:** TTEMI-05-001-0154

**Location:** 1009 Moss Street  
Columbus, Mississippi

**Orientation:** Northeast

**Date:** April 23, 2011

**Photographer:** Eric Turner, Tetra Tech

**Witness:** Steve Spurlin, EPA

**Subject:** WRS extended the berm alongside the creek further south to help mitigate flooding in the residence's back yard.





**OFFICIAL PHOTOGRAPH NO. 24  
U.S. ENVIRONMENTAL PROTECTION AGENCY (EPA)**

**TDD Number:** TTEMI-05-001-0154

**Location:** 1009 Moss Street  
Columbus, Mississippi

**Orientation:** North

**Date:** April 28, 2011

**Photographer:** Steve Spurlin, EPA

**Witness:** WRS

**Subject:** Grass seed and hay were distributed in the staging area at 1009 Moss Street where excavation was not necessary. In areas that were excavated, sod was installed.



**OFFICIAL PHOTOGRAPH NO. 25  
U.S. ENVIRONMENTAL PROTECTION AGENCY (EPA)**

**TDD Number:** TTEMI-05-001-0154

**Location:** 1009 Moss Street  
Columbus, Mississippi

**Orientation:** North

**Date:** April 28, 2011

**Photographer:** Steve Spurlin, EPA

**Witness:** WRS

**Subject:** Sod placed at 1009 Moss street. The driveway did not require excavation based on analytical results, and remained intact with the original gravel.



**ENCLOSURE 4**

**LOGBOOK NOTES**

(19 Sheets)

2/14/11 Tronox 05-0003-0104

0800 - Start Matherne Moves To Tronox Site, Columbus, MS. — km

1310 - Start Matherne Arrives @ Winstate Hotel. Meet w/ EPA O&S Spaulin & SESD. — km

1430 - Start Matherne / SESD Masters and Start Russell / SESD Simpson and 3rd SESD Team Move To Field To Recollect Drains Samples. — km

1645 - Start Matherne / SESD Masters Recollect Samples @ Parcels 13744 13743, 13723. — km

1730 - Start Russell / SESD Simpson Recollect Samples @ Parcels

13767, 12629, 12630, 12624 (7209). Also Collect Sample @ 12624 for Telp Analysis / Waste Disposal. — km

2/15/11 Tronox 05-0003-0104

0800 - SESD Masters / Start Matherne Move To Field. — km

SESD Simpson / Start Russell Move To Field. — km

0830 - SESD Masters / SM Collect @ 13766 — km

0850 - Collect 13762 — km

0905 - Collect 13761 — km

0915 - Collect 13759 — km

0930 - Collect 13758 / Split @ 0932 — km

0950 - Collect 13756 — km

1000 - Collect 13755 — km

1040 - Collect 13753 — km

1055 - Collect 13750 — km

1105 - Collect 13746 — km

SESD Masters / SM Complete

Sample Collection @ Assigned

Parcels. Move To Hotel To

Offload Dirty Equip & Reconvene

w/ SESD Team Leader Simpson. — km

1230 - SESD Masters / Simpson

and Start Matherne / Russell

move To School Parcel #

12462. Establish Sample



2/15/11 Tremax 05-0003-0104

Grids Per OSB Sperlin's

DIRECTION. \_\_\_\_\_ Km

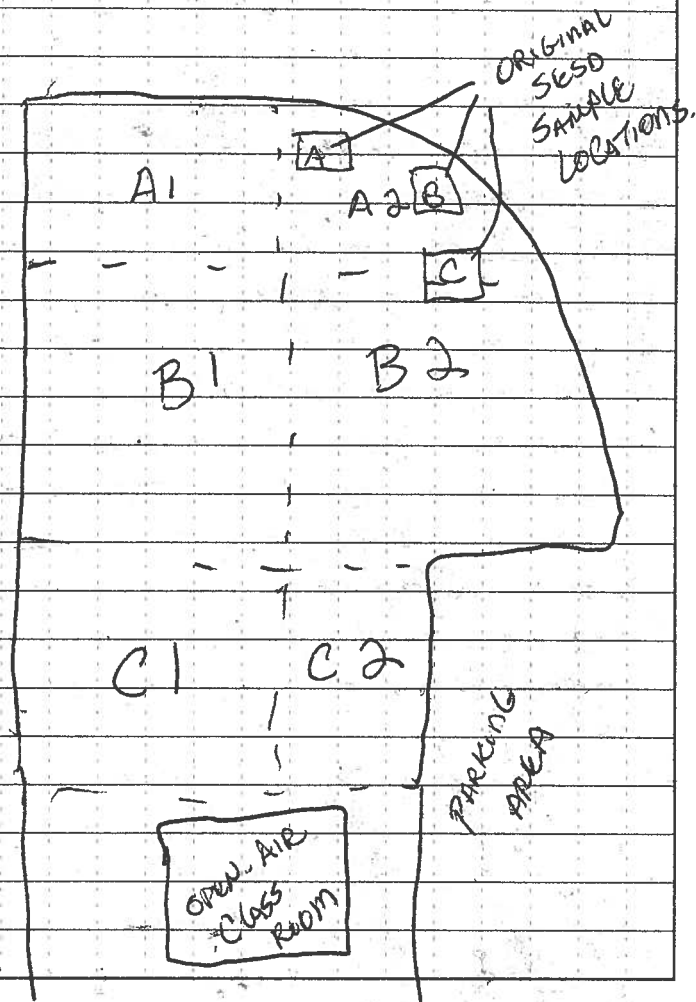

Scale: 1 square=\_\_\_\_\_

2/15/11 Tremax 05-0003-0104

1420- Collect 12462 Grid

A1 Sample. \_\_\_\_\_ Km

\* NOTE: SESD Simpson & START Russell Recollecting ORIGINAL GRIDS A, B, & C FROM NE AREA OF PARCEL. \_\_\_\_\_ Km

1435- Collect 12462 Grid B1- \_\_\_\_\_ Km

1450 Collect 12462 Grid C1- \_\_\_\_\_ Km

1505 Collect 12462 Grid C2- \_\_\_\_\_ Km

1525 Collect 12462 Grid B2- \_\_\_\_\_ Km

1550 Collect 13764 Sample- \_\_\_\_\_ Km

1700 - Collect Sample KUPP1

@ PROPT PARK #7 FRISBEE GOLF Hole. \_\_\_\_\_ Km

\* NOTE: Start Russell Collected Sample 12462 WP-01 on 2/13/11 @ 1458. Collected 12624 WP-01 @ 1530 on 2/14/11- \_\_\_\_\_ Km

Scale: 1 square=\_\_\_\_\_

2/16/11 Tronox K. Russell

0700 MEET WITH EPA SEDS TIM SIMPSON  
TO COLLECT TWO PANS, TWO SPOONS,  
TWO AUGER BUCKETS, AND ONE handle  
+ COOLER.

0830 START Russell + OSC SPURLIN  
HEAD TO Mananthea Fairly center  
G + 716 Water Works to collect  
Samples From Waste Dirt Pile. While  
on-site at the church on Monday the  
Hth recollecting samples with SEDS,  
OSC Spurlin noticed the pile of dirt on  
the church property. The minister  
apparently took the culvert that was  
covered with the contaminated soil.  
He left the soil pile behind. OSC  
Spurlin has decided to activate  
an ER to dig out soil Load in roll  
off & stage on Kerr mezz (Tronox)  
property then ultimately dispose of.  
0900 START Russell collects a 5 point  
composite From contaminated soil  
pile To run Full TCLP for disposal  
purposes & total SVOA's / Dioxins  
0920 START back at hotel to prep

Scale: 1 square=

K. Russell

2/16/11 Tronox K. Russell

Samples For Shipment. Sample  
collected this morning is KAMP-TCLP  
1050 Head to FedEx to ship off  
Samples

1100 back at hotel to get together  
Sampling info From OSC Spurlin  
for tomorrow's activities.

0430 WRS on site. OSC Spurlin takes  
them around to church lot, Tronox  
prop, & school. WRS will begin at  
0730 at church lot in the morning.

Scale: 1 square=



2/17/11

TOWNOK

K. Russell

0730 START AT CHURCH PROPERTY WITH WRS.

Mark Syracuse & Two laborers w/ WRS will work on loading out waste pile.

0750 OSC sportin on-site. WRS can't to wait on Hertz to deliver track hoe.

0900 RSC Brings Roll off & track hoe.

0920 WRS Begins loading out dirt pile into roll off.

1000 WRS is loading ~~the~~ <sup>the</sup> ~~to take~~ <sup>to take</sup> ~~to the Trough Maintenance Services Recycling Center.~~

WRS begin removing asphalt from 1 to 3 inches of soil below & around where dirt pile was located.

1030 OSC Sportin contacted Mike Pratt with Columbus Water Works of the City about a pipe that is located next to the dirt pile & excavation area. Mr Pratt said the City came out to check the pipe and its not associated with any sanitary drainage

Scale: 1 square=

2/17/11

TOWNOK

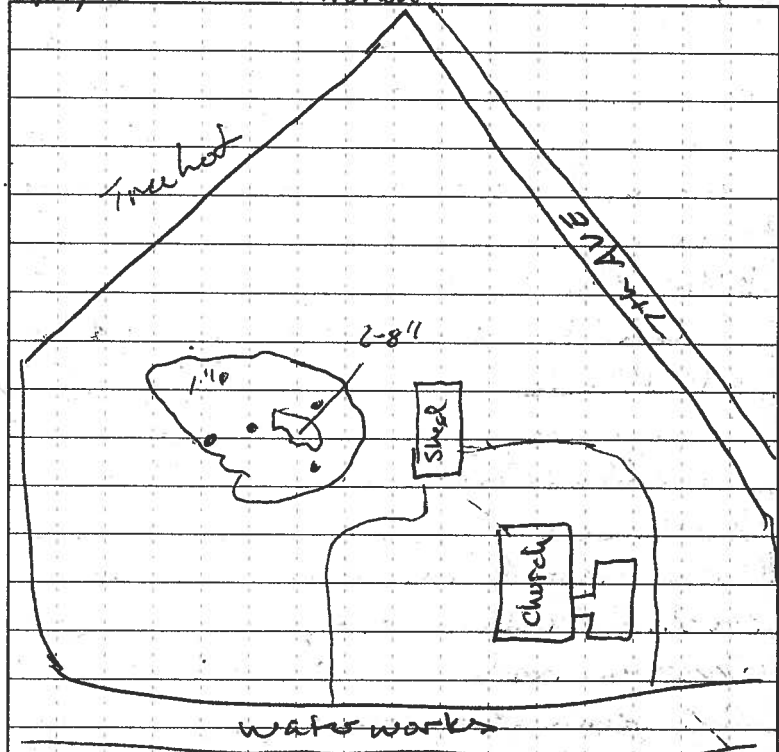

system and that it may be an old grease trap line. The City is not sure, but its no longer in service. 1100 Employee with Clorox Columbus light & water came to the site. Assured that the pipe was not anything with the City & it can be filled in. 1200 WRS Finishes excavating out

Scale: 1 square=

2/18/2011 Trowox K. Russell  
 START will collect a 5-foot aliquot from excavation area for confirmation chain.  
 Sample ID for Today's sample collected of Soil pile for TCLP was KMWP-TCLP  
 Sample for Total SVOA + Dioxin is KMWPO1  
 Sample for Total SVOA + Dioxin for confirm on chain is KMWPO2  
 \* WRS observed what appear to be two crushed buckets of hydraulic oil that was underneath the pile of dirt. Once they began excavating they had to dig down to 6-8 inches in the area where the crushed buckets were observed to remove any visible staining. The majority of the excavation area was 1 inch. Mark Syracuse said he anticipates each roll-off has about 16-17 yards of soil.  
 1230 Collected Sample KMWPOR  
 1240 Top fill unloaded at site.

2/17/11 Trowox K. Russell  
 1150 WRS begins spreading Top Fill down.  
 1330 Roll off N40505 dropped off on Kerr McGee site A&R Trowox  
 1400 Roll off RB16837 dropped off WRS also preparing to replace top covers on Roll-off 1029 & 1030 that have been staged on Kerr McGee property.  
 1420 OSC spurlin off site.  
 WRS begins replacing tarps on roll offs  
 1532 WRS finishes seeding top soil fill at church lot  
 1600 START off-site WRS done with ~~roll off~~ placing new liners on roll offs.  
 1610 Start at hotel prepping samples for shipment  
 1800 Dropped Samples at FedEx

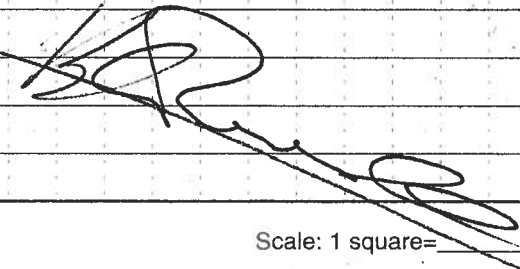





*"Rite in the Rain"*®

ALL-WEATHER

**JOURNAL**

No. 390N

Kerr McGee Chemical  
(Columbus) Removal  
TTEMI-05-001-0154



# CONTENTS

PAGE	REFERENCE	DATE
------	-----------	------

All samples were collected in accordance  
with the EPA Region 4 SESD  
Field Branches Quality Systems and  
Technical Procedures, October 2010.

"Rite in the Rain"  
ALL-WEATHER WRITING PAPER



## ALL-WEATHER HORIZONTAL LINE BOOK

Name \_\_\_\_\_

Address \_\_\_\_\_

Phone \_\_\_\_\_

Project 103DX9017.0001.0154  
Kerr McGee Tronox Removal  
Columbus, MS

This book is printed on "Rite in the Rain" All-Weather Writing Paper - A unique paper created to shed water and enhance the written image. It is widely used throughout the world for recording critical field data in all kinds of weather. For best results, use a pencil or an all-weather pen.

Specifications for this book:

Page Pattern		Cover Options	
Left Page	Right Page	Polydura Cover	Fabrikoid Cover
Lined	Lined	Item No. 390N	Item No. 390NF



4/12/11

Cin Tuesday

0800 CST. START Turner collects TSI SidePak AM510 from Pine Env, then transfers luggage and equipment into rental vehicle at Duluth Office.

1015 CST. Departs Duluth office for Columbus, MS.

1600 Arrive at Wingate Hotel (129 Brickerton St. Columbus, MS) to rendezvous with EPA OSC Steve Spurlin from Jackson, TN.

1612 START Turner and OSC Spurlin arrive at Kerr-McGee backfill source location to collect composite samples of backfill, Ronnie Jones Construction (1999 Cal Steens Rd)

1625 Collect KM-BF-041211-01. Premium top soil (#1) mixed with masonry sand and small amounts of pot ash. 5-pt. composite.

1630 Collect KM-BF-041211-02. 5-pt. composite, 2-pts collected from backfill pile of clay fill. 3-pts collected from #2 top soil (no additives) and homogenized.

\* KM-BF-041211-01, 02 analyzed for PAH's, % moisture, and RCRA metals. RCRA metals not originally listed to be sampled but added at OSC's request.

1900 START Turner ships samples via FedEx to Xenco in Norcross, GA.

4/13/11

Cin Wednesday

0700 1ft removal. Beware of benzo (G) pyrate

Beware of vehicular, foot traffic.

Particulate monitoring will take place throughout the site duration.

Weather: Sunny, 50°F.

20 cu. per truck in each load. (c.y. = cubic yards)

Activities today include excavating area within grassy fenced in area at Hunt Intermediate School, which is unopened and undergoing renovation.

WRS crew consists of Response Manager, Field Clerk, 2 operators, 2 laborers.

0720 WRS begins excavating grid at school

0745 Ronnie Jones Construction arrives on-site with 2 trucks of backfill for excavated material

0750 TSI Sidepak AM510 zero calibrated, installed on worker near excavation.

Readings at 0.040 mg/m<sup>3</sup> - 3.0 mg/m<sup>3</sup>

Area excavated is a 50'x50' grid in Northern region of school's old foot ball field (near southwestern corner of site)

0845 Mayor Robert Smith was updated on site by OSC Spurlin. No issues.

Discussed schedule and activities

0930 Sidepak reading 0.5 - 1.0 mg/m<sup>3</sup>.

4/13/11

Wednesday

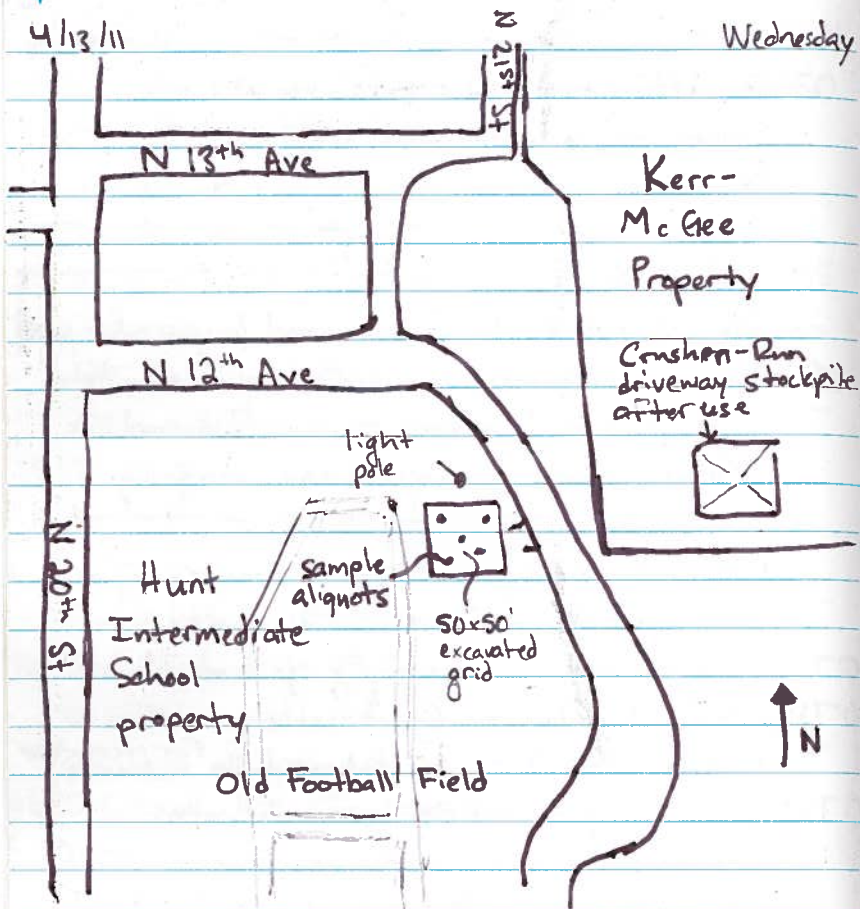

NW corner: 33.508089°N, 88.410417°W

SW corner: 33.507956°N, 88.410341°W

NE corner: 33.508081°N, 88.410283°W

SE corner: 33.507963°N, 88.410255°W

*in 2m*

4/13/11

E. Turner

Wednesday

1000 Ronnie Jones truck arrives to deliver ~5 c.y. of crusher-run to fill ruts created from front loader

1045 START Turner and OSC Spurlin visit 1009 Moss St to take pre-removal photos and video.

1130-1200 lunch

1210 1" PVC pipes unearthed within grid, nonfunctional. Previous discussion between OSC and school indicated no known or operational water lines. Possibly old irrigation lines. Two lines unearthed

1230 Sidepak reading 0.6 mg/m<sup>3</sup>-3.9 mg/m<sup>3</sup>

1243 Porto-John delivered by R.D.I.

1300 3<sup>rd</sup> truck arrives, 18 c.y. bed total ~ 58 c.y. hauled off now. First two trucks 20 c.y. capacity. Smaller truck used to remove large front loader from operation as its weight was creating heavy ruts.

1320 Tetra Tech Roland Hill, ~~from~~ property manager for former Kerr McGee met with OSC Spurlin regarding where excavated material was to be placed.

1430 4<sup>th</sup> truck arrives (18 c.y. capacity)



4/13/11 E. Turner Wednesday  
 1445 KM-12462-~~CS~~<sup>BT</sup>-B-CS-01 collected..  
 5-pt. composite from bottom of 1'  
 excavation. Confirmation sample.  
 1520 5<sup>th</sup> truck off-site (18 c.y. capacity)  
 1545 6<sup>th</sup> truck on-site (18 c.y.)  
 TSI Sidepak shut off 1453. Avg. value  
 0.952 mg/m<sup>3</sup>. Material collected in inlet; cleaned out.  
 1630 6<sup>th</sup> truck off-site. 50'x50' grid excavation  
 completed to 1' depth. PVC pipe previously  
 damaged was replaced, glued into system.  
 1635 Dropped off 1<sup>st</sup> load of fill. (18 c.y.)  
 1640 START Turner off-site to process and  
 pack samples. Cooler and ice purchased. Notified  
 that WRS will be off-site after 1<sup>st</sup> load  
 spread over excavation (off-site ~ 1730)  
 1815 START. Turner returns to hotel after  
 shipping sample via FedEx.  
 2000 START uploads pictures of day's activities to  
 EPA OSC website.

*E. Turner*

4/14/11 E. Turner Thursday  
 0700 Daily tailgate meeting with WRS, EPA,  
 Tetra Tech. Discussed slips/trips, moving  
 equip to 1009 Moss St. Loader planned to  
 be returned by COR as it is bigger than  
 necessary for residential property.  
 0730 Ronnie Jones constr. drops off 18 c.y. of backfill.  
 Waste soil excavated yesterday being sent to  
 Golden Triangle Waste Services,  
 1311 Industrial Park Road  
 Columbus, MS 39701-8646  
 (662) 327-6660  
 0755 Roland Hill on-site to unlock gate  
 to allow storage of non-contaminated  
 crusher-run for driveway.  
 0820 Ronnie Jones Constr. drops off 3<sup>rd</sup> 18 c.y. load  
 of backfill. This load and previous loads have  
 been ~~Type 2 topsoil (no additives)~~ <sup>BT</sup> Clay Fill.  
 0916 4<sup>th</sup> 18 c.y. load of ~~Type 2 topsoil~~ <sup>BT</sup> Clay Fill dropped off.  
 0935 WRS laborers fill potholes along Tuffy Ln.  
 using Crusher-Run clay fill <sup>BT</sup>  
 1005 5<sup>th</sup> 18 c.y. load of ~~Type 2 topsoil~~ <sup>BT</sup> dropped off.  
 1100 1<sup>st</sup> load 18 c.y. of Type 2 topsoil delivered.  
 1200 Hunt Intermediate School grid grading  
 complete. 18 c.y. Type 2 topsoil delivered,  
 taken to 1009 Moss St.

4/14/11 E. Turner Thursday

1215-1245 lunch

1245 WRS continues compacting soil on grid.

1300 2<sup>nd</sup> load Type 2 topsoil delivered to Hunt Intermediate School grid.

1345 Topsoil compacted.

1350 Ronnie Jones Constr. dropped 20 c.y. clay fill off at 1009 Moss St

1420 Begin removing driveway Crusher-run, placing inside Kerr McGee property (see p. 4 for sketch). Grass seed and hay distributed over grid.

1700 Driveway removed, grass seed and hay distributed over entire grid and driveway. Fence reinstalled.

### Hunt Intermediate School Excavation Summary

Total amount of disposed soil: 99 tons

• Disposed at Golden Triangle Regional Landfill in 6 loads.

### Material Delivered:

12 c.y. Crusher Run \* 1 c.y.  $\approx$  1.45 tons.

40 ft. fabric filter

90 c.y. Clay Fill Dirt

30 c.y. #2 Top Soil

1740 WRS, EPA, TT off-site, 2 piles at Moss St covered, photos + videos taken of Moss St prior to removal work.

4/15/11 E. Turner Friday

0700 WRS, TT on-site at 1009 Moss St

Weather: Overcast, windy. 65°F. Expected to rain around noon.

Health and safety meeting, discussed site activities.

0710 WRS begins setting up exclusion zone around house.

0800 Exclusion zone set up, picking up Porto-John from Hunt School, performing equipment maintenance.

0820 Crew off-site to pick up fencing and stakes for fence.

0915 Crew returns, begins installing more fence

0930 Fence installed. Crew off-site due to frequent thunder. If weather clears at noon work may resume.

1030 Severe weather falls, work stopped. Will resume work 0700 tomorrow.

1200 START Turner reviews logbook, creates summary of work completed thus far.

*E. Turner*



Saturday

0700 WRS, TT on-site. Daily tailgate meeting includes being wary of slick terrain, watching for traffic.

0710 ERRS crew (WRS) begins clearing material in front yard. Drainage ditch in back yard deepened to remove standing water.

0711 Weather: Sunny, 60's, winds W 10 mph. Ground still moist/soft from yesterday's precipitation.

0730 Crew begins scraping yard in front and side yard between adjacent property. Water standing along fence line drained into creek.

0905 Equipment operator begins using skid steer to build up containment berm for placing excavated soil.

0935 Containment berm completed, lined with visqueen. Crew continues excavating front yard and side yard with shovels.

1200-1230- lunch

1230 Equipment operator begins using excavator in areas accessible in front yard.

1345 Excavation complete. Skid steer moves soil  
to containment area.

1400 Begin backfilling with clay fill. —

1500 Begin back fill with top soil #2.

1600 Finish backfill, Begin fencing off perimeter

4/16/11

E. Turner

Saturday

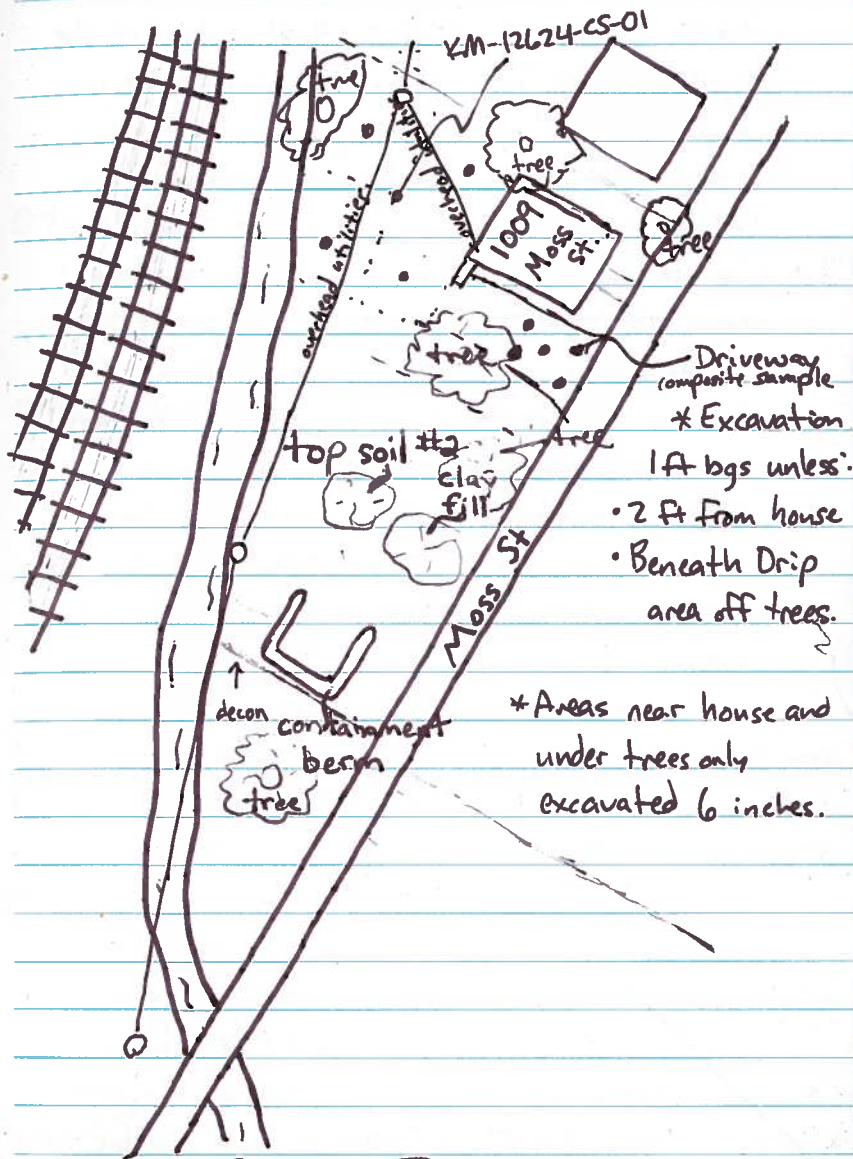

4/16/11

E. Turner

Saturday

1633 WRS Field clerk Chris Chizmar contacts START Turner to discuss Hunt Intermediate School Football Field Excavation summary totals (added to p.8 of logbook) and to discuss remaining excavation estimate for 1009 Moss St. Chizmar and Turner return to site to estimate excavation volumes based on area.

- Conservatively estimate 8 50'x50' ft grids
- Based on excavation at Hunt, estimate 800 tons of excavated soil from 1009 Moss.
- Chizmar estimates this cost at \$20,000 for soil disposal alone.

Chris

4/18/11

E. Turner

Monday

0700 Weather: Overcast 50°F, high of 77°F with clear skies.

Daily tailgate meeting: Caution working under power lines, two spotters in place at all times while operating excavator. Beware of vehicular traffic.

0710 Begin preparing for excavation. Ditch alongside fence between 1009 Moss St and adjacent house has dried. Equipment operator scrapes this area first where accessible. Laborers scrape rest of ditch.

0750 TSI Sidepak calibrated, begin logging data.

Instrument not run Thursday, Friday, Saturday due to damp conditions, hence no dust.

Initial reading: 0.050 mg/m<sup>3</sup>.

\* Extender tube placed on TSI inlet with inlet of tube facing downward to prevent dust from accumulating in instrument and create false readings. Located on corner of back porch

1000 Sidepak reading: 0.033 mg/m<sup>3</sup>

1020 OSC Spurlin on-site.

1045 OSC Spurlin requests 5-pt composite sample of driveway surface prior to excavation of driveway.

1105 Sample KM-12624-DRIVEWAY collected. Analyzed for PAH's + % moisture. Depth 3"

1140 Sidepak reading: 0.032 mg/m<sup>3</sup>.



4/18/11

E. Turner

Monday

1145 Sidepak shut off in preparation for lunch.

Max: 0.531 mg/m<sup>3</sup>Avg: 0.042 mg/m<sup>3</sup>TWA: 0.020 mg/m<sup>3</sup>

1205-1235 lunch

1300 Sidepak set up. Initial reading: 0.020 mg/m<sup>3</sup>

1347 T300 Robert skid steer, Ronnie Jones 18

c.y. truck arrives.

1425 Truck leaves to disposal facility.

1545 Collect sample KM-12624-CS-01

from back yard.

Aliquot 1: 33.50882°N, 88.402665°W<sup>(ET)</sup>  
 88.402665°W (6" depth)

Aliquot 2: 33.508348°N (6" depth)  
 88.402636°W

Aliquot 3: 33.508351°N (1' depth)  
 88.402633°W

Aliquot 4: 33.508320°N (1' depth)  
 88.402656°W

Aliquot 5: 33.508302°N (1' depth)  
 88.402690°W

1605 Excavation for today complete - begin backfilling with clay fill.

1630 START Turner off-site to process and ship samples.

4/18/11

E. Turner

Monday

1815 START Turner returns to hotel after shipping packages via FedEx.

E. Turner  
 4/18/11

4/19/11

E. Turner

Tuesday

0700 Weather 67°F, high of 87°F, clear skies

Daily tailgate meeting: Beware of traffic, keep site secure, keep hydrated.

0705 Ronnie Jones Construction arrives with load of <sup>clay</sup> backfill and to take load of soil for disposal.

ERRS crew backfills while placing load in truck.

0743 18 c.y. truck off site. WRS begins assessment of where next excavation will begin; start excavating front yard

0833 TSI sidepak set up at divider fence, at extent of excavation, Initial reading: 0.048 mg/m<sup>3</sup>

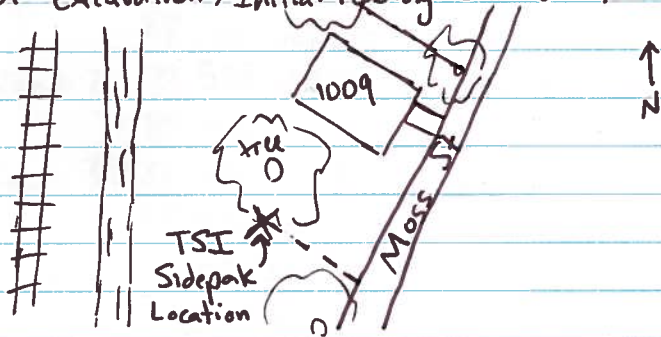

0850 Ronnie Jones Constr. truck arrives to collect disposal load, 18 c.y.

0916 Truck off site.

0946 Compactor arrives on site, WRS begin compacting front yard.

0948 WRS RM and field clerk lay seed and hay in

4/19/11

E. Turner

Tuesday

Area excavated 4/18/11 + 4/16/11

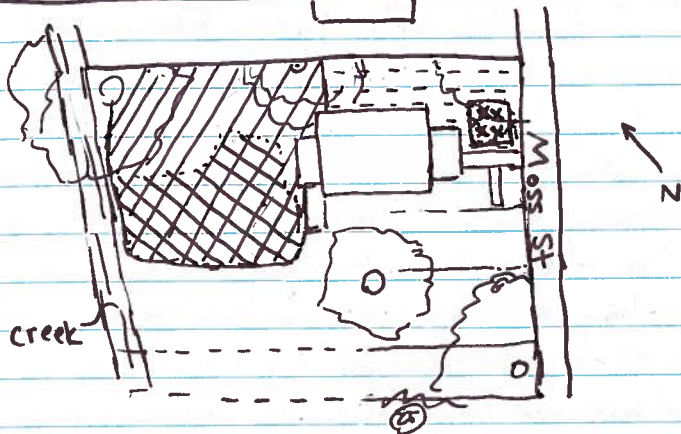

▨ Area excavated 6" due to tree dripline or close to boundary

▩ Area excavated to 1'

▤ Area excavated 6" 4/16/11

▥ Area excavated 1' 4/16/11

Area excavated 4/19/11



■ Driveway not excavated

▨ Area excavated to 6"

▩ Area excavated to 1'



4/19/11

E. Turner

Tuesday

areas washed away at Hunt Intermediate School

1020 Met with Pete Papas, Environmental Manager for Sanderson Plumbing Products at 2218 Tuffy Ln. Mr. Papas showed START Turner and OSC Spurlin outfall locations from production. Two lines were shown, one in Northeast corner of property and one along the southeast boundary from wooden toilet seat manufacturing. Outfall in northeast corner resembles outfall into creek adjacent to 1009 Moss St; they both have a sheen on the surface.

Outfall into creek ~~not~~ adjacent to 1009 Moss St also has yellowish foamy solid accumulating on the water surface as well.

1120 Sidepak reading:  $0.176 \text{ mg/m}^3$

1153 Truck arrives to collect disposal load.

1214 Truck off-site.

1220-1250 lunch.

1250 WRS continues excavating southeast portion of front yard excavation. Silt fence arrived for installation between berm and creek as rain is expected Wednesday and Thursday.

1310 Sidepak reading:  $0.104 \text{ mg/m}^3$

1319 Truck arrives to collect disposal load.

4/19/11

E. Turner

Tuesday

1350 Truck leaves (4<sup>th</sup> truck)

1432 Sidepak reading:  $0.072 \text{ mg/m}^3$

1446 Backfill truck arrives to dump load.

1450 Off-site ~~truck~~ after dumping clay fill load

1510 WRS acquires hose and begins dampening equipment path and piles.

1545 3<sup>rd</sup> truck of backfill arrives (clay fill)

1722 Ronnie Jones Constr. delivers 2 loads of top soil (#2)

1736 Ronnie Jones Constr. delivers 3<sup>rd</sup> load of #2 top soil.

1840 ERPS begins installing silt fence between reconstructed berm and creek.

1930 Crew off-site.

*E. Turner*

4/20/11

E. Turner

Wednesday

0900 No work to be completed today as heavy thunderstorms expected throughout the day.

4/21/11

E. Turner

Thursday

0700 ERPS and START onsite after inspection revealed silt fence had been compromised and sediment from the site had washed onto the street. From heavy flooding and winds last night. Street cleaned and silt fence adjacent to street installed. Silt fence bordering creek left somewhat compromised as ground was extremely soft.

0800 Off-site.

4/22/11

E. Turner

Friday

0700 START, ERRS on-site for site assessment.

Weather: 50's, foggy. Forecast: 85°F sunny, 25 mph wind coming mid-morning as fog lifts.

Plan today is to drain site from yesterday's and Wed. precipitation by trenching. Repair silt fence along creek, possibly install drain.

Safety concerns: slip/trip from soft/muddy terrain, quickly moving traffic.

0800 Silt fence repaired, trenches dug. Drain not installed. START, ERRS off-site.

1100 John Lee and Chris Chizmar (WRS) to 416 Waterworks ~~Drill~~ to Reverend Steve Jameson's property. Measured distance along ditch between property (~315') for fence to be installed later next week (scheduled for Monday)

1600 START Turner works on photo log, begins creating report.



4/23/11

E. Turner

Saturday

0700 ERRS, START onsite

Weather: 50's clear, partially cloudy. Site still damp.

Conduct daily safety tailgate meeting, emphasis on slick terrain.

0730 Ronnie Jones Constr. on-site with load of clay fill, collects disposal load.

0807 Ronnie Jones truck off-site (~5 min off-load time).

0905 Ronnie Jones Constr. arrives with load of #2 Top Soil.

0908 Ronnie Jones Constr. arrives with <sup>(ET)</sup> another load of ~~#2 Top Soil~~ to collect another disposal load. Operator collects all disposal soil in burned staging area, then collects visqueen barrier and scrapes grass from beneath visqueen. 3 Workers have been re-grading front yard with #2 Top Soil via wheel barrel as ground is still soft for heavy equipment.

1016 Ronnie Jones Constr truck offsite to disposal facility.

1103 Crew removes old burns surrounding staging area <sup>(ET)</sup> moves to extend burn alongside creek.

1135 START Turner at Hunt Intermediate School to take completed picture. Grass beginning to grow.



4/23/11

E. Turner

Saturday

1145 Ronnie Jones Constr. delivers load of #2

Top Soil

1200-1230 lunch

1230 Crew continues compacting berm alongside creek.

1330 Water moccasin observed in creek. berm from drainage area on south covered with top soil and compacted. Laborers have been wheel barreling topsoil to northern area of back yard.

Operator tills up muddy areas with excavator in an attempt to help dry the site.

1400 Operator begins using skid steer to backfill back yard; as ground is more solid. Laborers leveling loads.

1500 Crew begin removing silt fence adjacent to creek.

1515 Begin building berm up from drainage area north.

1600 START Turner off-site, demobing to Duluth, GA office.

Items Left to Complete

1. Complete backfill of 1009 Moss St
2. Install drain in low area of backyard
3. Topsoil on northern portion of berm.
4. Compact ground
5. Lay sod over excavated area (contractor)

4/23/11

E. Turner

Saturday

6. Spread hay and grass seed over staging area

7. Install fence on Reverend Steve Jameson's property alongside ditch (contractor.)

ERRS crew will continue work tonight and on Monday. Sod scheduled to arrive &amp; be installed Tuesday, fence should be installed Wednesday.

E. Turner

4/27/11 S. Spurlin Wednesday  
 1300 OSC Spurlin visits site  
 to meet with WRS Compass Response  
 Manager, John Lee, to view site  
 conditions after completion of  
 removal action at Mass St. property.  
 Per RM Lee, backfilling and  
 sodding of Mass St property  
 was completed on 4/25/11 and  
 4/26/11. OSC concurred that  
 actions were complete at the  
 Mass St property. Areas were  
 backfilled, a drain was installed  
 to assist with drainage of  
 low area, and sod installed.

A sprinkler and hose was  
 provided to tenant with  
 suggestion to periodically  
 water new sod so sod will  
 establish. EPA conveyed to  
 tenant and owner that EPA  
 will not maintain sod after  
 demobilization. OSC and RM  
 Lee met with fence contractor  
 at Moravetha Faith Center  
 property at 116 Watermark Road.

4/27/11 S. Spurlin Wednesday  
 Location of fence was discussed  
 and subcontractor indicated  
 fence would be installed the  
 next week, weather permitting.  
 OSC Spurlin verified with  
 WRS Compass that fence was  
 completed on 5/5/11. This  
 completes the removal actions  
 currently planned for the site.

Steve Spurlin/OSC



**ENCLOSURE 5**

**TABLE OF WITNESSES**

(One Page)

## TABLE OF WITNESSES

### KERR MCGEE CHEMICAL (COLUMBUS) REMOVAL COLUMBUS, LOWNDES COUNTY, MISSISSIPPI

Mr. Steve Spurlin  
On-Scene Coordinator (OSC)  
U.S. Environmental Protection Agency (EPA),  
Region 4  
Ed Jones Federal Building  
109 South Highland Avenue, B-13  
Jackson, Tennessee 38301  
Telephone No.: (731) 394-8996  
[spurlin.steve@epamail.epa.gov](mailto:spurlin.steve@epamail.epa.gov)

Mr. Eric Turner  
Site Manager  
Tetra Tech Superfund Technical Assessment and  
Response Team (START)  
1955 Evergreen Boulevard  
Building 200, Suite 300  
Duluth, Georgia 30096  
Telephone No.: (678) 775-3118  
[eric.turner@tetrattech.com](mailto:eric.turner@tetrattech.com)

Mr. John Lee  
Response Manager  
WRScompass (WRS) Emergency and Rapid  
Response Services (ERRS)  
221 Hobbs Street, Suite 108  
Tampa, Florida 33619  
Telephone No.: (813) 918-7030  
[jlee@wrscompass.com](mailto:jlee@wrscompass.com)

Mr. Chris Chizmar  
Field Cost Accountant  
WRS ERRS  
221 Hobbs Street, Suite 108  
Tampa, Florida 33619  
Telephone No.: (561) 847-0011  
[cchizmar@wrscompass.com](mailto:cchizmar@wrscompass.com)



**ENCLOSURE 6**

**ANALYTICAL DATA PACKAGES**

(Electronic Copy Only)

**ENCLOSURE 7**

**DISPOSAL MANIFESTS**

(16 Pages)



**GOLDEN TRIANGLE  
REGIONAL SOLID WASTE MANAGEMENT AUTHORITY**

P. O. Box 1619  
2525 Old West Point Road  
Starkville, Mississippi 39760

10251

**NON-HAZARDOUS MANIFEST**

**GENERATOR**

**Generator** USEPA REGION 4  
**Address** ED JONES FEDERAL BLDG.  
109 SOUTH HIGHLAND, B-13  
**Phone** JACKSON, TN 38301  
731-394-8996

**US EPA ID#** MSD990866329  
**Shipping Location** 2300 NORTH 14TH AVE  
**Address** COLUMBUS, MS 39704  
**Phone** 813-918-7030 (WRS SITE CELL)

Description of Waste Materials	Profile Number	Total Quantity	Unit of Measure	Container Type
BENZO (a) PYRENE CONTAMINATED SOIL	GT-11-005	~ 21	TON	DT

I hereby certify that the above-described materials are not hazardous wastes as defined by 40 CFR, Part 261 or any applicable state law, have been fully and accurately described, classified and packaged, and are in proper condition for transportation according to applicable regulations.

Steve Spurlin  
Generator Authorized Agent Name (Print)

Steve Spurlin 4-13-11  
Signature Delivery Date

**TRANSPORTER**

**Transporter Name** RONNIE JONES CONSTRUCTION  
**US EPA ID#** \_\_\_\_\_  
**Address** 1999 CALEDONIA-STEENS ROAD  
CALEDONIA, MS 39740  
**Phone** 662-356-6222

**Driver Name (Print)** DENNIS MING  
**Truck Number** 2052  
**Truck Type** DUMP TRUCK

I hereby acknowledge that the above described materials were received from the generator site and were transported without incident to the destination listed below.

I hereby acknowledge receipt of the above-described materials for transport from the generator site listed above.

Dennis Ming  
Driver Signature Shipment Date

Dennis Ming  
Driver Signature Delivery Date

**DESTINATION**

**Site Name** GOLDEN TRIANGLE REGIONAL LANDFILL (662) 324-7566  
**Address** 2525 Old West Point Road, Starkville, Mississippi 39760  
**Disposal Location Grid:** A115L5 # 122659

I hereby acknowledge receipt of the above-described materials.

Sandra Gust  
Name of Authorized Agent (Print)

Sandra Gust 4/15/11  
Signature Receipt Date



**GOLDEN TRIANGLE**  
**REGIONAL SOLID WASTE MANAGEMENT AUTHORITY**  
P. O. Box 1619  
2525 Old West Point Road  
Starkville, Mississippi 39760

10252

**NON-HAZARDOUS MANIFEST**

**GENERATOR**

**Generator** US EPA REGION 4  
**Address** ED JONES FEDERAL BLDG  
109 SOUTH HIGHLAND B-13  
**Phone** JACKSON, TN 38301  
731-394-8996

**US EPA ID#** MSD990866329  
**Shipping Location** 2300 NORTH 14<sup>th</sup> AVE  
**Address** COLUMBUS, MS 39704  
**Phone** 813-918-7030 WRS SITE CELL

Description of Waste Materials	Profile Number	Total Quantity	Unit of Measure	Container Type
BENZO(a)PYRENE CONTAMINATED SOIL	GT-11-005	~21	TON	DT

I hereby certify that the above-described materials are not hazardous wastes as defined by 40 CFR, Part 261 or any applicable state law, have been fully and accurately described, classified and packaged, and are in proper condition for transportation according to applicable regulations.

Steve Spurlin  
Generator Authorized Agent Name (Print)

Steve Spurlin 4-13-11  
Signature Delivery Date

**TRANSPORTER**

**Transporter Name** RONNIE JONES CONSTRUCTION  
**US EPA ID#**    
**Address** 1999 CALEDONIA-STEENS ROAD  
CALEDONIA, MS 39740  
**Phone** 662-356-6222

**Driver Name (Print)** John Roney  
**Truck Number** 028  
**Truck Type** MAK DUMP TRUCK

I hereby acknowledge that the above described materials were received from the generator site and were transported without incident to the destination listed below.

I hereby acknowledge receipt of the above-described materials for transport from the generator site listed above.

John Roney 4-13-11  
Driver Signature Shipment Date

John Roney 4-13-11  
Driver Signature Delivery Date

**DESTINATION**

**Site Name** GOLDEN TRIANGLE REGIONAL LANDFILL (662) 324-7566  
**Address** 2525 Old West Point Road, Starkville, Mississippi 39760  
**Disposal Location Grid:** A31565 # 07366

I hereby acknowledge receipt of the above-described materials.

Seidra G. West  
Name of Authorized Agent (Print)

Seidra G. West 4/13/11  
Signature Receipt Date



**GOLDEN TRIANGLE**  
**REGIONAL SOLID WASTE MANAGEMENT AUTHORITY**  
P. O. Box 1619  
2525 Old West Point Road  
Starkville, Mississippi 39760

10253

**NON-HAZARDOUS MANIFEST**

**GENERATOR**

**Generator** US EPA REGION 4  
**Address** ED JONES FEDERAL BLDG  
109 SOUTH HIGHLAND B-13  
**Phone** JACKSON, TN 38301  
731-394-8996

**US EPA ID#** MSD990866329  
**Shipping Location** 2300 N 14<sup>th</sup> AVE  
**Address** Columbus, MS 39704  
**Phone** 813-918-7030 WAS SITE CELL

Description of Waste Materials	Profile Number	Total Quantity	Unit of Measure	Container Type
BENZ(a) PYRENE CONTAMINATED SOIL	GT-11-005	~278	TON	DT

I hereby certify that the above-described materials are not hazardous wastes as defined by 40 CFR, Part 261 or any applicable state law, have been fully and accurately described, classified and packaged, and are in proper condition for transportation according to applicable regulations.

Steve Spurlin  
Generator Authorized Agent Name (Print)

Steve Spurlin 4-13-11  
Signature Delivery Date

**TRANSPORTER**

**Transporter Name** RONNIE JONES CONS  
**US EPA ID#** \_\_\_\_\_  
**Address** 1999 CALEDONIA STEENS RD  
CALEDONIA MS 39740  
**Phone** (662) 356-6222

**Driver Name (Print)** DENNIS Ming  
**Truck Number** 23  
**Truck Type** WHEELER DumpTRUCK

I hereby acknowledge that the above described materials were received from the generator site and were transported without incident to the destination listed below.

I hereby acknowledge receipt of the above-described materials for transport from the generator site listed above.

Dennis Ming  
Driver Signature Shipment Date

Dennis Ming  
Driver Signature Delivery Date

**DESTINATION**

**Site Name** GOLDEN TRIANGLE REGIONAL LANDFILL (662) 324-7566  
**Address** 2525 Old West Point Road, Starkville, Mississippi 39760  
**Disposal Location Grid:** A17515 # 022713

I hereby acknowledge receipt of the above-described materials.

Sandra Garsst  
Name of Authorized Agent (Print)

Sandra Garsst 4/13/11  
Signature Receipt Date



**GOLDEN TRIANGLE**  
**REGIONAL SOLID WASTE MANAGEMENT AUTHORITY**  
P. O. Box 1619  
2525 Old West Point Road  
Starkville, Mississippi 39760

10254

**NON-HAZARDOUS MANIFEST**

**GENERATOR**

**Generator** US EPA REGION 4  
**Address** ED JONES FEDERAL BLDG  
109 SOUTH HIGHLAND B-13  
**Phone** JACKSON, TN 38301  
731-394-8996

**US EPA ID#** MSD990866329  
**Shipping Location** 2300 N 14<sup>th</sup> AVE  
**Address** Columbus, MS 39704  
**Phone** 813-918-7030 WRS SITE CELL

Description of Waste Materials	Profile Number	Total Quantity	Unit of Measure	Container Type
BENZO(A)PYRENE CONTAMINATED SOIL	GT-11-005	~ 21	TON	DT

I hereby certify that the above-described materials are not hazardous wastes as defined by 40 CFR, Part 261 or any applicable state law, have been fully and accurately described, classified and packaged, and are in proper condition for transportation according to applicable regulations.

Steve Spurlin  
Generator Authorized Agent Name (Print)

Steve Spurlin for EPA 4-13-11  
Signature Delivery Date

**TRANSPORTER**

**Transporter Name** Ronnell Jones  
**US EPA ID#** \_\_\_\_\_  
**Address** 1999 CALICOONIA MS  
39740  
**Phone** 662-356-6222

**Driver Name (Print)** DENNIS MING  
**Truck Number** 22  
**Truck Type** 10 WHEELER TRUCK

I hereby acknowledge that the above described materials were received from the generator site and were transported without incident to the destination listed below.

I hereby acknowledge receipt of the above-described materials for transport from the generator site listed above.

Dennis Ming  
Driver Signature Shipment Date

Dennis Ming  
Driver Signature Delivery Date

**DESTINATION**

**Site Name** GOLDEN TRIANGLE REGIONAL LANDFILL (662) 324-7566  
**Address** 2525 Old West Point Road, Starkville, Mississippi 39760

**Disposal Location Grid:** AT15L4 #072220 PO#30-001166

I hereby acknowledge receipt of the above-described materials.

Sandra Gust  
Name of Authorized Agent (Print)

Sandra Gust 4/13/11  
Signature Receipt Date



**GOLDEN TRIANGLE  
REGIONAL SOLID WASTE MANAGEMENT AUTHORITY**

P. O. Box 1619  
2525 Old West Point Road  
Starkville, Mississippi 39760

10255

**NON-HAZARDOUS MANIFEST**

**GENERATOR**

Generator USEPA Region 4  
Address ED Jones FEDERAL BLDG.  
Jackson, TN. 38301  
Phone 731-394-8996

US EPA ID# MS D990 B66 329  
Shipping Location 2300 N 14TH AVE  
Address Columbus MS 39704  
Phone 813 918 7030 WRS cell

Description of Waste Materials	Profile Number	Total Quantity	Unit of Measure	Container Type
<u>BenzO (A) PYRENE Contaminated Soil</u>	<u>GT-11-005</u>	<u>18</u>	<u>TON</u>	<u>D.T.</u>

I hereby certify that the above-described materials are not hazardous wastes as defined by 40 CFR, Part 261 or any applicable state law, have been fully and accurately described, classified and packaged, and are in proper condition for transportation according to applicable regulations.

Steve Spurlin  
Generator Authorized Agent Name (Print)

Steve Spurlin 4-13-11  
Signature Delivery Date

**TRANSPORTER**

Transporter Name RONNIE JONES  
US EPA ID#                       
Address 1999 Caledonia MS  
39740  
Phone 662-356-6222

Driver Name (Print) Hank Vaughn  
Truck Number 050  
Truck Type 10 W

I hereby acknowledge receipt of the above-described materials for transport from the generator site listed above.

I hereby acknowledge that the above described materials were received from the generator site and were transported without incident to the destination listed below.

Hank Vaughn 4/13/11  
Driver Signature Shipment Date

Hank Vaughn 4/13/11  
Driver Signature Delivery Date

**DESTINATION**

Site Name GOLDEN TRIANGLE REGIONAL LANDFILL (662) 324-7566  
Address 2525 Old West Point Road, Starkville, Mississippi 39760  
Disposal Location Grid: A7515 #102231 PO 30-00166

I hereby acknowledge receipt of the above-described materials.

Sandra Gost  
Name of Authorized Agent (Print)

Sandra Gost 4/13/11  
Signature Receipt Date



**GOLDEN TRIANGLE**  
**REGIONAL SOLID WASTE MANAGEMENT AUTHORITY**  
P. O. Box 1619  
2525 Old West Point Road  
Starkville, Mississippi 39760

10256

**NON-HAZARDOUS MANIFEST**

**GENERATOR**

Generator US EPA Region 4  
Address EO Jones Federal Bldg  
109 South Highland B-13  
Phone Jackson TN 38301  
731-394-8996

US EPA ID# MS0990866329  
Shipping Location 2300 North 14th Ave.  
Address Columbus MS 39704  
Phone 813 918 7030 Wes Site Cell

Description of Waste Materials	Profile Number	Total Quantity	Unit of Measure	Container Type
<u>Benzene (A) pyrene contaminated soil</u>	<u>GT-11-005</u>	<u>18</u>	<u>Ton</u>	<u>DT</u>

I hereby certify that the above-described materials are not hazardous wastes as defined by 40 CFR, Part 261 or any applicable state law, have been fully and accurately described, classified and packaged, and are in proper condition for transportation according to applicable regulations.

Steve Spurlin  
Generator Authorized Agent Name (Print)

Steve Spurlin 4-13-11  
Signature Delivery Date

**TRANSPORTER**

Transporter Name Everett Jones Construction  
US EPA ID#    
Address 1999 Calcedonia - Stennis Rd  
Calcedonia MS  
Phone 662-356-6222

Driver Name (Print) DENNIS MING  
Truck Number #22  
Truck Type 10W Dump Truck

I hereby acknowledge that the above described materials were received from the generator site and were transported without incident to the destination listed below.

I hereby acknowledge receipt of the above-described materials for transport from the generator site listed above.

Dennis Ming  
Driver Signature Shipment Date

Dennis Ming 4-14-11  
Driver Signature Delivery Date

**DESTINATION**

Site Name GOLDEN TRIANGLE REGIONAL LANDFILL (662) 324-7566  
Address 2525 Old West Point Road, Starkville, Mississippi 39760

Disposal Location Grid: AI15L5 TKT. 072735 PO. 30-001166

I hereby acknowledge receipt of the above-described materials.

Kitty Johnson  
Name of Authorized Agent (Print)

Kitty Johnson 4-14-11  
Signature Receipt Date



**GOLDEN TRIANGLE**  
**REGIONAL SOLID WASTE MANAGEMENT AUTHORITY**  
P. O. Box 1619  
2525 Old West Point Road  
Starkville, Mississippi 39760

10257

**NON-HAZARDOUS MANIFEST**

**GENERATOR**

Generator US EPA Region 4  
Address ED Jones Federal Bldg.  
109 SOUTH Highland, B-13  
Phone Jackson TN 38301  
731-394-8996

US EPA ID# MS0990866329  
Shipping Location 2300 NORTH 14TH AVE.  
Address Columbus MS 39704  
Phone 813-918-7030 WRS Site Phone

Description of Waste Materials	Profile Number	Total Quantity	Unit of Measure	Container Type
<u>Benzo (a) Pyrene contaminated Soil</u>	<u>6T-11-005</u>	<u>18</u>	<u>TON</u>	<u>DT</u>

I hereby certify that the above-described materials are not hazardous wastes as defined by 40 CFR, Part 261 or any applicable state law, have been fully and accurately described, classified and packaged, and are in proper condition for transportation according to applicable regulations.

Steve Spurlin  
Generator Authorized Agent Name (Print)

Steve Spurlin 4-18-11  
Signature Delivery Date

**TRANSPORTER**

Transporter Name Ronnie Jones Const.  
US EPA ID# \_\_\_\_\_  
Address 1999 Caledonia-Steep RD  
Caledonia MS 39740  
Phone 662-356-6222

Driver Name (Print) Ronnie Jones  
Truck Number 022  
Truck Type STERLING

I hereby acknowledge that the above described materials were received from the generator site and were transported without incident to the destination listed below.

I hereby acknowledge receipt of the above-described materials for transport from the generator site listed above.  
Ronnie Jones 4-18-11  
Driver Signature Shipment Date

Ronnie Jones  
Driver Signature Delivery Date

**DESTINATION**

Site Name GOLDEN TRIANGLE REGIONAL LANDFILL (662) 324-7566  
Address 2525 Old West Point Road, Starkville, Mississippi 39760  
Disposal Location Grid: A115L5 TRF.07296.5 PO.30-001166

I hereby acknowledge receipt of the above-described materials.

Kitty Johnson  
Name of Authorized Agent (Print)

Kitty Johnson 4-18-11  
Signature Receipt Date



**GOLDEN TRIANGLE**  
**REGIONAL SOLID WASTE MANAGEMENT AUTHORITY**  
P. O. Box 1619  
2525 Old West Point Road  
Starkville, Mississippi 39760

10258

**NON-HAZARDOUS MANIFEST**

**GENERATOR**

Generator US EPA Region 4  
Address ED Jones Federal Bldg.  
109 SOUTH HIGHLAND, B-13  
Phone Jackson, TN. 38301  
731-394-3996

US EPA ID# MSD 990866329  
Shipping Location 2300 NORTH 14TH AVE  
Address Columbus MS 39704  
Phone 813-918-7030 WES Site Phone

Description of Waste Materials	Profile Number	Total Quantity	Unit of Measure	Container Type
<u>Benz (a) Pyrene Contaminated Soil</u>	<u>6T-11-005</u>	<u>18</u>	<u>Ton</u>	<u>DT</u>

I hereby certify that the above-described materials are not hazardous wastes as defined by 40 CFR, Part 261 or any applicable state law, have been fully and accurately described, classified and packaged, and are in proper condition for transportation according to applicable regulations.

Steve Spurlin  
Generator Authorized Agent Name (Print)

Steve Spurlin  
Signature

4-19-11  
Delivery Date

**TRANSPORTER**

Transporter Name Ronnie Jones Const  
US EPA ID#                       
Address 1999 Calcedonia Stearns RD  
Calcedonia MS 39740  
Phone 662-356-6222

Driver Name (Print) Hank Vaughn  
Truck Number 22  
Truck Type Sterlin

I hereby acknowledge that the above described materials were received from the generator site and were transported without incident to the destination listed below.

I hereby acknowledge receipt of the above-described materials for transport from the generator site listed above.

Hank Vaughn 4/19/11  
Driver Signature Shipment Date

Hank Vaughn 4/19/11  
Driver Signature Delivery Date

**DESTINATION**

Site Name GOLDEN TRIANGLE REGIONAL LANDFILL (662) 324-7566

Address 2525 Old West Point Road, Starkville, Mississippi 39760

Disposal Location Grid: A11515 Trk. 072994 PO. 30-001166

I hereby acknowledge receipt of the above-described materials.

Kitty Johnson  
Name of Authorized Agent (Print)

Kitty Johnson 4/19/11  
Signature Receipt Date



**GOLDEN TRIANGLE**  
**REGIONAL SOLID WASTE MANAGEMENT AUTHORITY**  
P.O. Box 1619  
2525 Old West Point Road  
Starkville, Mississippi 39760

10259

**NON-HAZARDOUS MANIFEST**

**GENERATOR**

Generator USEPA Region 4  
Address EO Jones Federal Bldg  
109 SOUTH HIGHWAY - B-13  
Phone Jackson, TN 38301  
771-394-8996

US EPA ID# MSD990866329  
Shipping Location 2300 NORTH 14TH AVE.  
Address Columbus, MS 39704  
Phone 813 918 7030 WRS S. To Cell Home

Description of Waste Materials	Profile Number	Total Quantity	Unit of Measure	Container Type
<u>Benz (a) pyrene Contaminated Soil</u>	<u>6T-11-005</u>	<u>18</u>	<u>TON</u>	<u>OT</u>

I hereby certify that the above-described materials are not hazardous wastes as defined by 40 CFR, Part 261 or any applicable state law, have been fully and accurately described, classified and packaged, and are in proper condition for transportation according to applicable regulations.

Steve Spurlin  
Generator Authorized Agent Name (Print)

Steve Spurlin 4-19-11  
Signature Delivery Date

**TRANSPORTER**

Transporter Name Ronnie Jones Const  
US EPA ID#    
Address 1999 Caledonia Starks Rd  
Caledonia MS 39740  
Phone 662-356-6222

Driver Name (Print) Hank Vaughn  
Truck Number 22  
Truck Type Sterlin

I hereby acknowledge that the above described materials were received from the generator site and were transported without incident to the destination listed below.

I hereby acknowledge receipt of the above-described materials for transport from the generator site listed above.

Hank Vaughn 4/19/11  
Driver Signature Shipment Date

Hank Vaughn 4/19/11  
Driver Signature Delivery Date

**DESTINATION**

Site Name GOLDEN TRIANGLE REGIONAL LANDFILL (662) 324-7566  
Address 2525 Old West Point Road, Starkville, Mississippi 39760  
Disposal Location Grid: A71515 TK7.073008 PO. 30-001166

I hereby acknowledge receipt of the above-described materials.

Kitty Johnson  
Name of Authorized Agent (Print)

Kitty Johnson 4-19-11  
Signature Receipt Date



**GOLDEN TRIANGLE  
REGIONAL SOLID WASTE MANAGEMENT AUTHORITY**

P. O. Box 1619  
2525 Old West Point Road  
Starkville, Mississippi 39760

10260

**NON-HAZARDOUS MANIFEST**

**GENERATOR**

Generator USEPA REGION 4  
Address ED JONES FEDERAL BLDG  
109 SOUTH HIGHLAND B-13  
Phone JACKSON, TN 38301  
771-394-8996

US EPA ID# MSD 990866329  
Shipping Location 2300 NORTH 14<sup>TH</sup> AVE  
Address COLUMBUS, MS 39704  
Phone 813-918-7030 WRS SITE CELL

Description of Waste Materials	Profile Number	Total Quantity	Unit of Measure	Container Type
<u>REAZO (C) PYRENE CONTAMINATED SOIL</u>	<u>GT-11-005</u>	<u>~18</u>	<u>TON</u>	<u>DT</u>

I hereby certify that the above-described materials are not hazardous wastes as defined by 40 CFR, Part 261 or any applicable state law, have been fully and accurately described, classified and packaged, and are in proper condition for transportation according to applicable regulations.

Steve Spurlin  
Generator Authorized Agent Name (Print)

Steve Spurlin 4-19-11  
Signature Delivery Date

**TRANSPORTER**

Transporter Name Ronnie Jones Construction  
US EPA ID#    
Address 1999 Calapania Stearns RD  
Calapania MS 39740  
Phone 662-356-6222

Driver Name (Print) Hank Vaughn  
Truck Number 22  
Truck Type sterion

I hereby acknowledge that the above described materials were received from the generator site and were transported without incident to the destination listed below.

I hereby acknowledge receipt of the above-described materials for transport from the generator site listed above.

Hank Vaughn 4/19/11  
Driver Signature Shipment Date

Hank Vaughn 4/19/11  
Driver Signature Delivery Date

**DESTINATION**

Site Name GOLDEN TRIANGLE REGIONAL LANDFILL (662) 324-7566  
Address 2525 Old West Point Road, Starkville, Mississippi 39760  
Disposal Location Grid: AI1515 TH.073023 PO-30-01166

I hereby acknowledge receipt of the above-described materials.

Kitty Johnson  
Name of Authorized Agent (Print)

Kitty Johnson 4/19/11  
Signature Receipt Date



**GOLDEN TRIANGLE**  
**REGIONAL SOLID WASTE MANAGEMENT AUTHORITY**  
P. O. Box 1619  
2525 Old West Point Road  
Starkville, Mississippi 39760

10261

**NON-HAZARDOUS MANIFEST**

**GENERATOR**

Generator USEPA REGION 4  
Address ED JONES FEDERAL BLDG  
109 SOUTH HIGHLANDS, B-13  
Phone JACKSON, TN 38301  
771-394-8996

US EPA ID# MSD 990866329  
Shipping Location 2300 NORTH 14<sup>th</sup> AVE  
Address COLUMBUS, MS 39704  
Phone 813-918-7030 WRS SITE CELL

Description of Waste Materials	Profile Number	Total Quantity	Unit of Measure	Container Type
<u>BENZO (a) PYRENE CONTAMINATED SOIL</u>	<u>GT-11-005</u>	<u>~18</u>	<u>TON</u>	<u>DT</u>

I hereby certify that the above-described materials are not hazardous wastes as defined by 40 CFR, Part 261 or any applicable state law, have been fully and accurately described, classified and packaged, and are in proper condition for transportation according to applicable regulations.

Steve Spurlin  
Generator Authorized Agent Name (Print)

Steve Spurlin  
Signature

4-19-11  
Delivery Date

**TRANSPORTER**

Transporter Name Ronnie Jones Construction  
US EPA ID# \_\_\_\_\_  
Address 1999 Caledonia (Main) RD  
Caledonia MS 39740  
Phone 662-356-6222

Driver Name (Print) Hank Vaughn  
Truck Number 22  
Truck Type Storage

I hereby acknowledge that the above described materials were received from the generator site and were transported without incident to the destination listed below.

I hereby acknowledge receipt of the above-described materials for transport from the generator site listed above.

Hank Vaughn 4/19/11  
Driver Signature Shipment Date

Hank Vaughn 4/19/11  
Driver Signature Delivery Date

**DESTINATION**

Site Name GOLDEN TRIANGLE REGIONAL LANDFILL (662) 324-7566

Address 2525 Old West Point Road, Starkville, Mississippi 39760

Disposal Location Grid: AI151.5 TK1.073037 PO-30-001166

I hereby acknowledge receipt of the above-described materials.

Kitty Johnson  
Name of Authorized Agent (Print)

Kitty Johnson 4-19-11  
Signature Receipt Date



**GOLDEN TRIANGLE**  
**REGIONAL SOLID WASTE MANAGEMENT AUTHORITY**  
P. O. Box 1619  
2525 Old West Point Road  
Starkville, Mississippi 39760

10262

**NON-HAZARDOUS MANIFEST**

**GENERATOR**

**Generator** USEPA REGION 4  
**Address** ED TONES FEDERAL BLDG  
109 SOUTH HIGHLANDS, B-13  
**Phone** JACKSON, TN 38301  
771-394-8996

**US EPA ID#** MSD990866329  
**Shipping Location** 2300 NORTH 14<sup>th</sup> AVE  
**Address** COLUMBUS, MS. 39704  
**Phone** 813-918-7030 WRS SITE CELL

Description of Waste Materials	Profile Number	Total Quantity	Unit of Measure	Container Type
BENZ(a)PYRENE CONTAMINATED SOIL	GT-11-005	~18	TON	DT

I hereby certify that the above-described materials are not hazardous wastes as defined by 40 CFR, Part 261 or any applicable state law, have been fully and accurately described, classified and packaged, and are in proper condition for transportation according to applicable regulations.

Steve Spurlin  
Generator Authorized Agent Name (Print)

Steve Spurlin 4-19-11  
Signature Delivery Date

**TRANSPORTER**

**Transporter Name** Ronnie Jarvis Const.  
**US EPA ID#** \_\_\_\_\_  
**Address** 1999 Caledonia-Stein RD  
Caledonia MS 39740  
**Phone** 662-356-6222

**Driver Name (Print)** Hank Vaughn  
**Truck Number** 22  
**Truck Type** Sterlin

I hereby acknowledge that the above described materials were received from the generator site and were transported without incident to the destination listed below.

I hereby acknowledge receipt of the above-described materials for transport from the generator site listed above.  
Hank Vaughn 4/19/11  
Driver Signature Shipment Date

Hank Vaughn 4/19/11  
Driver Signature Delivery Date

**DESTINATION**

**Site Name** GOLDEN TRIANGLE REGIONAL LANDFILL (662) 324-7566  
**Address** 2525 Old West Point Road, Starkville, Mississippi 39760  
**Disposal Location Grid:** A11515 # 073060

I hereby acknowledge receipt of the above-described materials.

Sandra Gust  
Name of Authorized Agent (Print)

Sandra Gust 4/19/11  
Signature Receipt Date



**GOLDEN TRIANGLE**  
**REGIONAL SOLID WASTE MANAGEMENT AUTHORITY**  
P. O. Box 1619  
2525 Old West Point Road  
Starkville, Mississippi 39760

10263

**NON-HAZARDOUS MANIFEST**

**GENERATOR**

Generator US EPA Region 4  
Address EO Jones Federal Bldg  
109 South Highland B-13  
Phone Jackson, TN 38301  
731-394-8996

US EPA ID# MSD990866329  
Shipping Location 2300 North 14th Ave  
Address Columbus, MS 39704  
Phone 613-918-7030 WAS SITE CELL PHONE

Description of Waste Materials	Profile Number	Total Quantity	Unit of Measure	Container Type
<u>Benz (a) Pyrene Contaminated Soil</u>	<u>GT-11-005</u>	<u>18</u>	<u>Ton</u>	<u>DT</u>

I hereby certify that the above-described materials are not hazardous wastes as defined by 40 CFR, Part 261 or any applicable state law, have been fully and accurately described, classified and packaged, and are in proper condition for transportation according to applicable regulations.

Steve Spurlin  
Generator Authorized Agent Name (Print)

Stan Zula  
Signature  
Delivery Date

**TRANSPORTER**

Transporter Name Rennette Jones Const.  
US EPA ID#                       
Address 1999 Caledonia - Steen RD  
Caledonia, MS 39704  
Phone 662-356-6222

Driver Name (Print) Jeff Smith  
Truck Number 051  
Truck Type Dump

I hereby acknowledge that the above described materials were received from the generator site and were transported without incident to the destination listed below.

I hereby acknowledge receipt of the above-described materials for transport from the generator site listed above.  
J. Smith 4-23-2011  
Driver Signature Shipment Date

J. Smith 4-23-2011  
Driver Signature Delivery Date

**DESTINATION**

Site Name GOLDEN TRIANGLE REGIONAL LANDFILL (662) 324-7566  
Address 2525 Old West Point Road, Starkville, Mississippi 39760  
Disposal Location Grid: A115L5 # 73275

I hereby acknowledge receipt of the above-described materials.

Sandra Gust  
Name of Authorized Agent (Print)

Sandra Gust 4/23/11  
Signature Receipt Date



9:15 Am - 10:15 A.M.

10264

**GOLDEN TRIANGLE**  
**REGIONAL SOLID WASTE MANAGEMENT AUTHORITY**  
P.O. Box 1619  
2525 Old West Point Road  
Starkville, Mississippi 39760

**NON-HAZARDOUS MANIFEST**

**GENERATOR**

**Generator** US EPA Region 4  
**Address** ED Jones Federal Bldg  
109 South Highland, B-13  
**Phone** Jackson, TN. 38301

**US EPA ID#** MSD 990866329  
**Shipping Location** 2300 NORTH 14TH AVE  
**Address** Columbus MS 39704  
**Phone** 813-918 7030 hrs site cell 11 PM

Description of Waste Materials	Profile Number	Total Quantity	Unit of Measure	Container Type
BenzO (n) Petroleum contaminated soil	GT-11-005	18	TON	DT

I hereby certify that the above-described materials are not hazardous wastes as defined by 40 CFR, Part 261 or any applicable state law, have been fully and accurately described, classified and packaged, and are in proper condition for transportation according to applicable regulations.

Steve Spurlin  
Generator Authorized Agent Name (Print)

Steve Spurlin  
Signature

4-23-11  
Delivery Date

**TRANSPORTER**

**Transporter Name** RONNIE JONES CONST.  
**US EPA ID#** \_\_\_\_\_  
**Address** 1999 Caledonia-Stevens RD.  
Caledonia, MS 39740  
**Phone** 662-356-6222

**Driver Name (Print)** J. Smith  
**Truck Number** 51  
**Truck Type** Dump

I hereby acknowledge that the above described materials were received from the generator site and were transported without incident to the destination listed below.

I hereby acknowledge receipt of the above-described materials for transport from the generator site listed above.

J. Smith  
Driver Signature

4-23-2011  
Shipment Date

J. Smith  
Driver Signature

4-23-2011  
Delivery Date

**DESTINATION**

**Site Name** GOLDEN TRIANGLE REGIONAL LANDFILL (662) 324-7566

**Address** 2525 Old West Point Road, Starkville, Mississippi 39760

**Disposal Location Grid:** A115L15 # 73282

I hereby acknowledge receipt of the above-described materials.

Sandra Crisp  
Name of Authorized Agent (Print)

Sandra Crisp  
Signature

4/23/11  
Receipt Date



**GOLDEN TRIANGLE**  
**REGIONAL SOLID WASTE MANAGEMENT AUTHORITY**  
P. O. Box 1619  
2525 Old West Point Road  
Starkville, Mississippi 39760

10266

**NON-HAZARDOUS MANIFEST**

**GENERATOR**

Generator US EPA Region 4  
Address EO Jones federal Bldg.  
109 South Highland B-13  
Phone Jackson, TN. 38301  
731-394-8996

US EPA ID# MSD 990866 329  
Shipping Location 2300 N. 14TH AVE  
Address Columbus MS 39704  
Phone 813 918 7030 WRS Site Phone

Description of Waste Materials	Profile Number	Total Quantity	Unit of Measure	Container Type
<u>BENZO (a) pyrene Contaminated Soil</u>	<u>GT-11-005</u>	<u>18</u>	<u>Ton</u>	<u>Roll off</u>

I hereby certify that the above-described materials are not hazardous wastes as defined by 40 CFR, Part 261 or any applicable state law, have been fully and accurately described, classified and packaged, and are in proper condition for transportation according to applicable regulations.

Steve Spurlin  
Generator Authorized Agent Name (Print)

Steve Spurlin  
Signature

Delivery Date

**TRANSPORTER**

Transporter Name MIWD  
US EPA ID#    
Address PO Box 801  
Columbus MS 39703  
Phone 328-5528

Driver Name (Print) Bob Clarke  
Truck Number 56  
Truck Type Roll off

I hereby acknowledge that the above described materials were received from the generator site and were transported without incident to the destination listed below.

I hereby acknowledge receipt of the above-described materials for transport from the generator site listed above.

[Signature] 4-20-11  
Driver Signature Shipment Date

[Signature] 4-20-11  
Driver Signature Delivery Date

**DESTINATION**

Site Name GOLDEN TRIANGLE REGIONAL LANDFILL (662) 324-7566

Address 2525 Old West Point Road, Starkville, Mississippi 39760

Disposal Location Grid: AI1515 TRT. 073119 PO-30-001166

I hereby acknowledge receipt of the above-described materials.

Kitty Johnson  
Name of Authorized Agent (Print)

Kitty Johnson 4-20-11  
Signature Receipt Date



**GOLDEN TRIANGLE**  
**REGIONAL SOLID WASTE MANAGEMENT AUTHORITY**  
P. O. Box 1619  
2525 Old West Point Road  
Starkville, Mississippi 39760

10267

**NON-HAZARDOUS MANIFEST**

**GENERATOR**

Generator US EPA Region 4  
Address ED JONES Federal Bldg  
109 SOUTH Highland B-13  
Phone Jackson, TN 38301  
731-394-8996

US EPA ID# MSD 990866329  
Shipping Location 2300 NORTH 14TH AVE.  
Address Columbus MS 39704  
Phone WRB Site Phone 313 913 7030

Description of Waste Materials	Profile Number	Total Quantity	Unit of Measure	Container Type
<u>Benzo (a) pyrene Contaminated soil</u>	<u>GT-11-005</u>	<u>18</u>	<u>TON</u>	<u>Roll off</u>

I hereby certify that the above-described materials are not hazardous wastes as defined by 40 CFR, Part 261 or any applicable state law, have been fully and accurately described, classified and packaged, and are in proper condition for transportation according to applicable regulations.

Steve Spurlin  
Generator Authorized Agent Name (Print)

Steve Spurlin  
Signature  
Delivery Date

**TRANSPORTER**

Transporter Name MTWD  
US EPA ID#    
Address PoBox 801  
Columbus MS 39703  
Phone 328-5528

Driver Name (Print) Bob CLARKE  
Truck Number 56  
Truck Type Roll off

I hereby acknowledge that the above described materials were received from the generator site and were transported without incident to the destination listed below.

I hereby acknowledge receipt of the above-described materials for transport from the generator site listed above.

[Signature] 4-20-11  
Driver Signature Shipment Date

[Signature] 4-20-11  
Driver Signature Delivery Date

**DESTINATION**

Site Name GOLDEN TRIANGLE REGIONAL LANDFILL (662) 324-7566

Address 2525 Old West Point Road, Starkville, Mississippi 39760

Disposal Location Grid: A I 15 L 5

TKT. 073137 PD-30-001166

I hereby acknowledge receipt of the above-described materials.

Kitty Johnson  
Name of Authorized Agent (Print)

Kitty Johnson 4/24/11  
Signature Receipt Date



**ENCLOSURE 8**

**SITE VIDEOS**

(Two Videos)  
(Electronic Copy Only)