



February 16, 2011

Ms. Karen Buerki
On-Scene Coordinator
U.S. Environmental Protection Agency Region 4
Sam Nunn Atlanta Federal Center
61 Forsyth Street NW
Atlanta, Georgia 30303

**Subject: Incident Response Letter Report, Revision 1
LaFayette High School Mercury Release
LaFayette, Walker County, Georgia
TDD No.: TNA-05-001-0120
Contract No.: EP-W-05-053**

Dear Ms. Buerki:

The Oneida Total Integrated Enterprises (OTIE) Superfund Technical Assessment and Response Team (START) has prepared this Incident Response Letter Report detailing activities conducted in support of the U.S. Environmental Protection Agency (EPA) during the LaFayette High School Mercury Release (site) emergency response in LaFayette, Walker County, Georgia. The scope of activities performed by START during this incident response were to provide technical and administrative support to the EPA On-Scene Coordinator (OSC), conduct air monitoring for mercury vapor concentrations, document site activities with photographs and written logbook notes, and prepare an Incident Response Letter Report.

This Incident Response Letter Report summarizes the response activities conducted to mitigate the mercury release, and provides photographic documentation of the emergency response removal activities. Figures, including a topographical map, aerial map, and floor layout diagrams, are located in Attachment A. Attachment B includes the screening results tables and the witnesses table. The photographic log of site activities is provided in Attachment C. A copy of the logbook notes collected though the duration of the incident is provided in Attachment D.

Physical Location

The physical address of the school site is 5178 Round Pond Road, LaFayette, Walker County, Georgia. The geographic coordinates of the site are Latitude 34.718630° North and Longitude 85.261353° West. Figures 1 and 2 illustrate the location of the site and the surrounding areas.

The main school building is approximately 178,728 square feet in size and is comprised of four classroom wings (300, 400, 600, and 700 wings); a two level gymnasium; a cafeteria, and auditorium. In addition to the main school building there are five double-wide trailer mobile units that are used as classrooms. Figure 3 provided in Attachment A illustrate the school floor plan.

Background

On November 12, 2010, the EPA Phone Duty Officer notified START of the incident and requested the deployment of three START personnel to assist the responding EPA OSC. START generated a Health and Safety Plan (HASP), loaded mercury vapor air monitoring equipment and personal protective equipment (PPE), and deployed the following morning to LaFayette, Georgia where START personnel met with OSC Huyser. School officials, START and OSC Huyser then met to discuss the need to initiate remediation activities at the school including classrooms and school buses; and at off-site residences where the students allegedly stored the mercury removed from the science classroom.

The site was referred to the EPA by the LaFayette High School Assistant Principal and by the Walker County Public Schools Superintendent, which had received medical tests documenting high levels of mercury exposure of one child living at an affected residence. Residents of the affected house were notified of the unsafe mercury vapor concentrations documented within their residence. The EPA OSC recommended that the family temporarily relocate with relatives until the remediation activities were completed.

According to the school administration, the released mercury was removed without permission from the main science classroom (Room No. 604) chemical storage closet. Based on school administration reports, the incident may have occurred at the beginning of October 2010 after the school administration performed monthly inventory and noticed that metal mercury bottles were missing. The school administrative personnel performed cleanup procedures according to the EPA guidelines relating to spilled elemental mercury. School officials informed the EPA and conducted interviews of approximately 200 students. This information directed the investigation to the students who allegedly removed the mercury from the storage closet, and prompted the screening of their residences. The decision to create a

separate TDD for the 909 McLemore Street residence was due to the high levels of mercury in the blood and urine of the student who transported some of the mercury from the school to his residence (909 McLemore Street). In addition, the screening results at the residence showed high levels of mercury vapors in various areas of the house. These screening results were submitted under a separate letter report.

Initial Assessment

Mercury vapor screening was conducted using a Lumex[®] 915 Plus Mercury Vapor Analyzer (MVA), a Lumex RA-915 Light MVA or a Jerome 431 MVA (for higher concentrations). The screening results listed on the tables and figures are reported in nanograms per cubic meter (ng/m³) as documented from the Lumex[®] MVA. The concentrations in this report were converted to micrograms per cubic meter (µg/m³) to adhere to the EPA report structure. START documented screening results in the field logbook (Attachment D) and the tabulated screening results are included in Attachment B.

After meeting with school administrators and OSC Huyser on the morning of November 13, 2010 it was determined that the following areas at the school needed to be screened thoroughly: Room No. 707; the boys' and girls' bathrooms in the 700 Wing; Room No. 604 (science classroom and chemical storage room); Room No. 605; and Mobile Unit No. 2. Screening the aforementioned areas confirmed mercury vapor concentrations of 19 µg/m³ in Room No. 707 at the floor level in the back corner of the classroom. In Mobile Unit No. 2, mercury vapor concentrations were confirmed >100 µg/m³ at floor level under the chalk board. Mercury vapor concentrations in multiple areas throughout the school building were in excess of the 1.0 µg/m³, the EPA mercury clean-up level for schools. Figures 3 through 32 in Attachment A illustrate the school layout and locations where mercury vapor monitoring was conducted by START. No visible elemental mercury was observed anywhere in the main school building or in Mobile Unit No. 2 while screening activities were conducted. Additional areas screened during the response included the following: Room No. 400, Room No. 502, Room No. 505, Room No. 607, Room No. 708, Room No. 709, Room No. 710, the gymnasium (upper and lower areas), the auditorium, Room No. 805, the janitor's closet in the administrative office, the janitor's closet in the 300 wing, and the janitor's closet in the 700 wing.

START screened 12 bags of contaminated items collected and removed from the main school building. These items included a vacuum cleaner hose; trash collected during the initial clean-up that school administration performed prior to the EPA's involvement; a student's backpack; mops; and, shoes and sandals. The headspace readings collected from screening these bags ranged from $5.0 \mu\text{g}/\text{m}^3$ to $>50 \mu\text{g}/\text{m}^3$. All 12 of the bags were sealed with duct tape and placed inside Mobile Unit No. 2 which served as a temporary staging area for mercury contaminated items.

Further Assessment

Based on the initial assessment, it was decided that START would screen every classroom and other areas of the main school building. START screened each room of the main school building documenting vapor readings from multiple locations at one foot (ft) from the floor and at the breathing zone (approximately three feet above the floor). See tables in Attachment B for the screening results.

On November 14, 2010, START continued screening the classrooms, common areas and janitor closets of the school. In the janitor's closet located in the Cafeteria (see Figure 24), all items were screened and readings of $13 \mu\text{g}/\text{m}^3$ were detected in the dust pan and $6.3 \mu\text{g}/\text{m}^3$ in the sink drain. At the back corner of Room No. 610, the floor drain showed readings of $2.6 \mu\text{g}/\text{m}^3$.

Room No. 509 was screened and readings of $5.8 \mu\text{g}/\text{m}^3$ were detected in the sink. The girls' bathroom in the 400 wing of the school indicated mercury vapor readings of $1.2 \mu\text{g}/\text{m}^3$ in the toilet partition areas at the floor level. The boys' bathroom in the 300 wing indicated mercury vapor readings of $2.5 \mu\text{g}/\text{m}^3$ at the floor drain.

The girls' bathroom in the 200 wing indicated instrument readings of $1.1 \mu\text{g}/\text{m}^3$ in the floor drain area. In Room No. 207, the trash can indicated mercury vapor readings of $2.2 \mu\text{g}/\text{m}^3$ and the vacuum $3.0 \mu\text{g}/\text{m}^3$; START and EPA recommended that school officials dispose of and replace those items.

At Room No. 802, the main janitor's area and storage room, the readings from the instrument screening indicated mercury vapor concentrations of $1.2 \mu\text{g}/\text{m}^3$ in the bathroom area and $13.9 \mu\text{g}/\text{m}^3$ inside the washing machine with mop heads (see Figure 25). START and EPA removed the mop heads and conducted a second screening at the washer. The second screening yielded a mercury vapor concentration of $5.6 \mu\text{g}/\text{m}^3$. START also found a trash can with mop heads in the storage area of Room No. 802; the readings from the screening indicated mercury vapor concentrations $>50 \mu\text{g}/\text{m}^3$. START placed all mop heads in the trash can and bagged all items for disposal.

At the janitor's closet in the 600 wing of the school (see Figure 26), the screening of the mop bucket indicated a mercury vapor concentration of $24.5 \mu\text{g}/\text{m}^3$. The item was bagged and removed for disposal. At the janitor's closet in the 400 wing (see Figure 27), a concentration of $5.2 \mu\text{g}/\text{m}^3$ was detected at the sink floor drainage.

At Room No. 207 (the band room), START detected mercury vapor readings of $2.0 \mu\text{g}/\text{m}^3$ at the entrance door and concentrations $>50 \mu\text{g}/\text{m}^3$ at the rug by the back door which leads to the yard. The rug was bagged and placed with other items for disposal. The boys' locker room in the 200 wing was screened and the highest reading was detected in the shower area at $4.2 \mu\text{g}/\text{m}^3$.

On November 15, 2010, START continued the mercury vapor screening at the janitor's closets and locker rooms at the gymnasium area. The janitor's closet at the gymnasium showed ambient readings of $1.5 \mu\text{g}/\text{m}^3$, the mop bucket was $22.9 \mu\text{g}/\text{m}^3$, and the sink floor drainage was $6.5 \mu\text{g}/\text{m}^3$. The mop bucket was bagged and placed with the other items for disposal. The boys' locker room (see Figure 28) and the weight room (see Figure 29) in the gym were also screened. The highest reading was detected in the shower at $12 \mu\text{g}/\text{m}^3$ in the boys' locker room and $0.2 \mu\text{g}/\text{m}^3$ in the weight room.

START also screened school buses as requested by the LaFayette High School administration. EPA and START screened school buses No. 33 (Figure 30), No. 49 (Figure 31) and No. 88 (Figure 32). Only school bus No. 49 presented readings above $1 \mu\text{g}/\text{m}^3$. The highest mercury vapor reading detected was $6.5 \mu\text{g}/\text{m}^3$ and it was on a trash can near the front door. START bagged and removed and placed the item in the staging area for disposal. After the item was removed, START continued with screening activities inside the bus and obtained readings of $3.0 \mu\text{g}/\text{m}^3$ at the front door and $> 50 \mu\text{g}/\text{m}^3$ near the emergency flares located at the front of the bus. START advised school administration officials to have the school's environmental contractor to clean the bus. In addition START returned to the school and re-screened the band room. Mercury vapor readings ranged from 1.2 to $1.6 \mu\text{g}/\text{m}^3$ at the breathing zone; the school administration was informed of the re-screening results.

START screened two additional student residences, 4577 Hwy 337 and 2280 Hwy 27 in LaFayette, Georgia. All readings were $0.282 \mu\text{g}/\text{m}^3$ or below, well below the clean up level of $1 \mu\text{g}/\text{m}^3$. As a result, no further actions were conducted at these residences.

Clean Harbors was contracted by LaFayette High School to remediate areas with elevated mercury vapor readings and were responsible for addressing final cleanup activities at the school and handling the disposal of all mercury-contaminated items.

On November 16, 2010, upon completion of the mercury screening activities, START was released from the site by EPA and demobilized at approximately 1245 hours Eastern Standard Time (EST).

If you have any questions or comments regarding this Letter Report or require any additional information, please contact myself or Mr. Greg Kowalski, START Program Manager, at 678-355-5550.

Sincerely,

A handwritten signature in blue ink, appearing to read "Ryan Stubbs". The signature is stylized with a large, looped "R" and a cursive "Stubbs".

Ryan Stubbs
OTIE START Project Manager

CC: Katrina Jones, EPA Project Officer
Darryl Walker, EPA Project Officer
Matthew Huyser, EPA OSC
Greg Kowalski, OTIE START Program Manager
Russell Henderson, OTIE START Assistant Program Manager

Enclosures

ATTACHMENT A
FIGURES

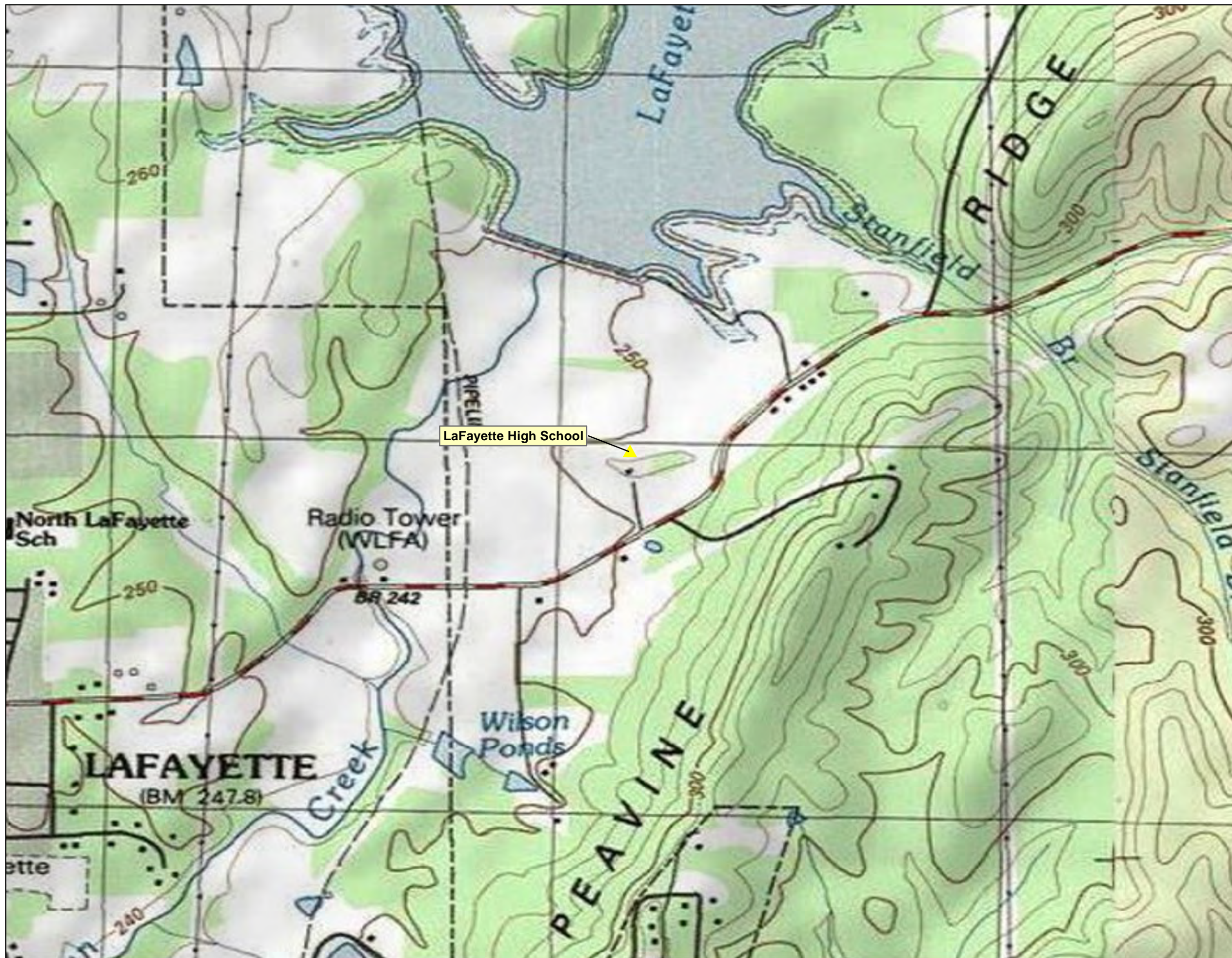

Legend

▲ LaFayette High School

Feet
0 750 1,500

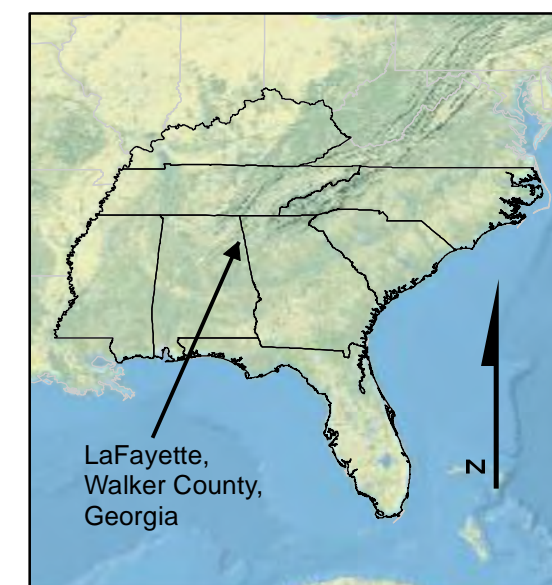

United States Environmental Protection Agency
EPA

**LAFAYETTE HIGH SCHOOL
MERCURY RELEASE
LAFAYETTE, WALKER
COUNTY, GEORGIA
TDD No. TNA-05-001-0120**

**FIGURE 1
TOPOGRAPHICAL MAP**





Legend

▲ LaFayette High School

Feet
0 500 1,000

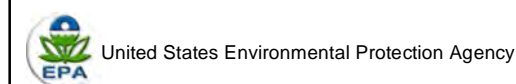
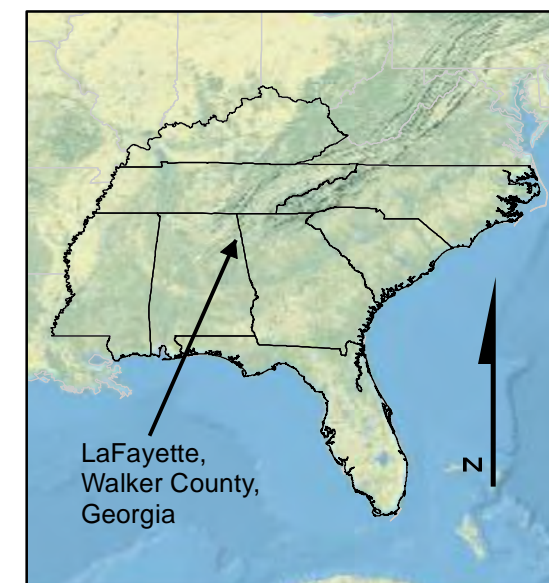

**LAFAYETTE HIGH SCHOOL
MERCURY RELEASE
LAFAYETTE, WALKER
COUNTY, GEORGIA
TDD No. TNA-05-001-0120**

**FIGURE 2
AERIAL MAP**



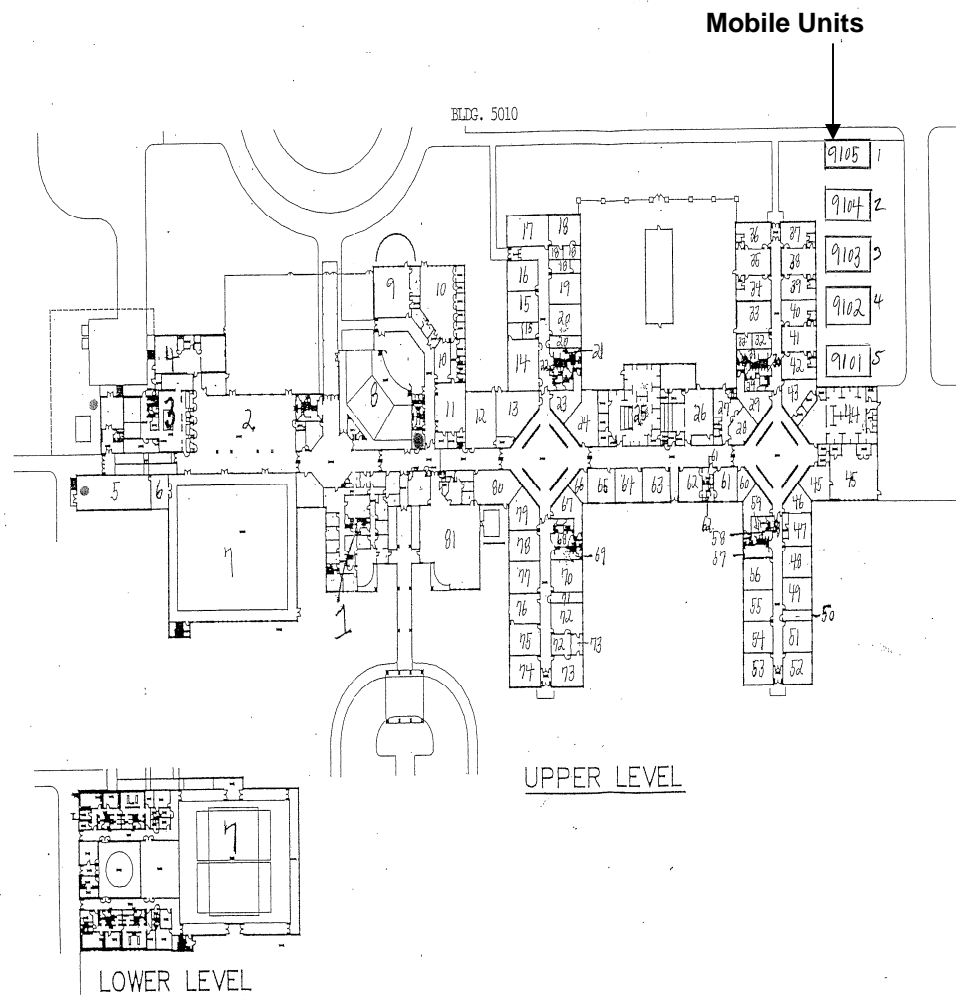

OVERALL FLOOR PLAN — LAFAYETTE HIGH SCHOOL
1" = 100'-0"



Legend

School Floor Plan
Not To Scale

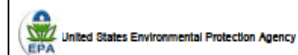
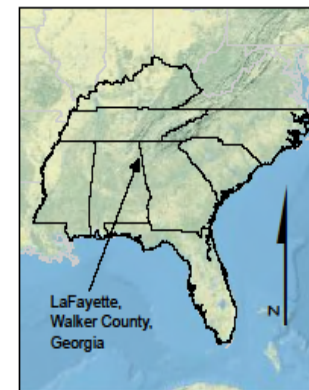

LAFAYETTE HIGH SCHOOL
MERCURY RELEASE
LAFAYETTE, WALKER
COUNTY, GEORGIA
TDD No. TNA-05-001-0120

FIGURE 3
SCHOOL FLOOR
PLAN



Room 707 Layout

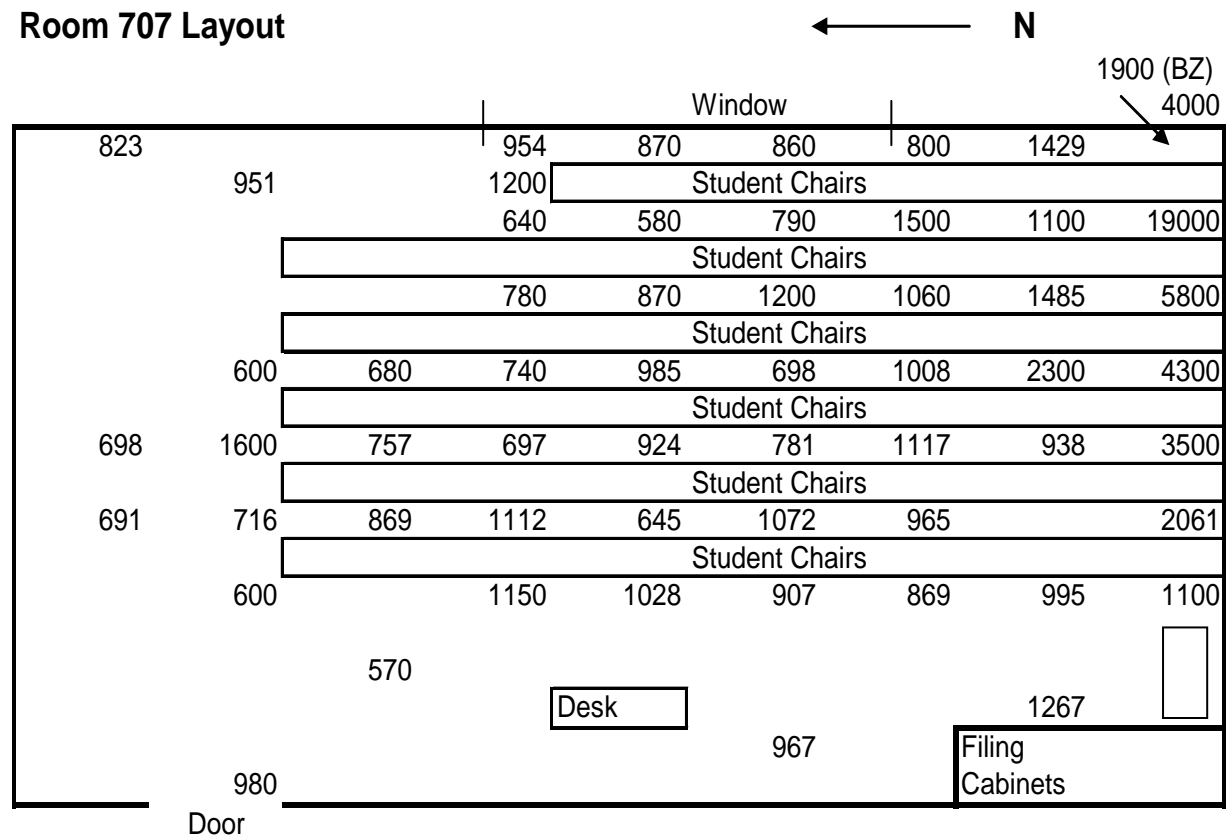

Legend

Concentrations
measured in
nanograms per
cubic meter

Concentrations
measured at floor
level

BZ – Breathing Zone

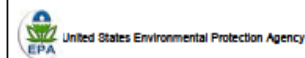
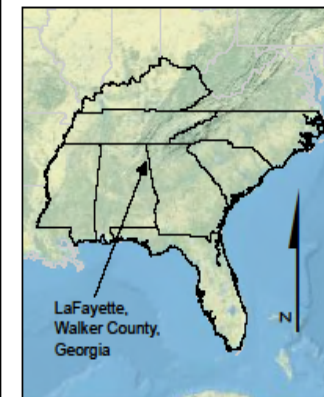

LAFAYETTE HIGH SCHOOL
MERCURY RELEASE
LAFAYETTE, WALKER
COUNTY, GEORGIA
TDD No. TNA-05-001-0120

FIGURE 4
ROOM 707 LAYOUT



Boys Bathroom Layout - 700 Wing

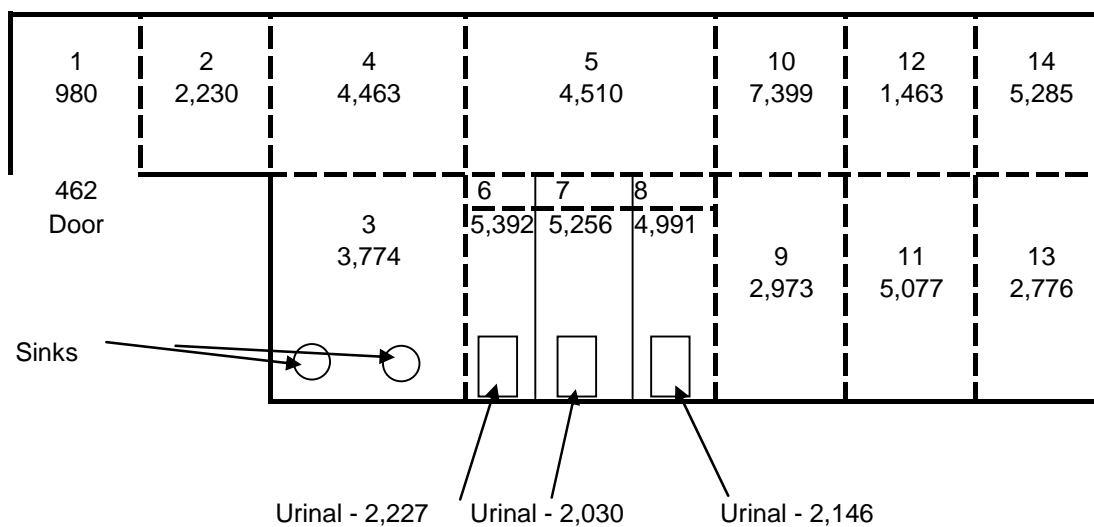

Legend

Concentrations measured in nanograms per cubic meter

Concentrations measured at floor level

The station number is listed above the concentration value

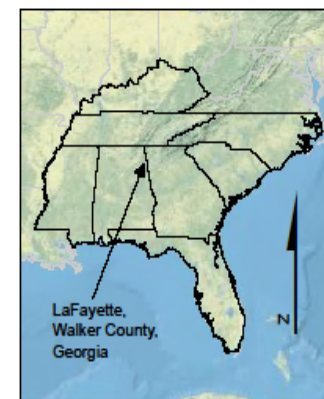

**LAFAYETTE HIGH SCHOOL
MERCURY RELEASE
LAFAYETTE, WALKER
COUNTY, GEORGIA
TDD No. TNA-05-001-0120**

**FIGURE 5
BOYS BATHROOM
700 WING LAYOUT**



Room 604 Layout

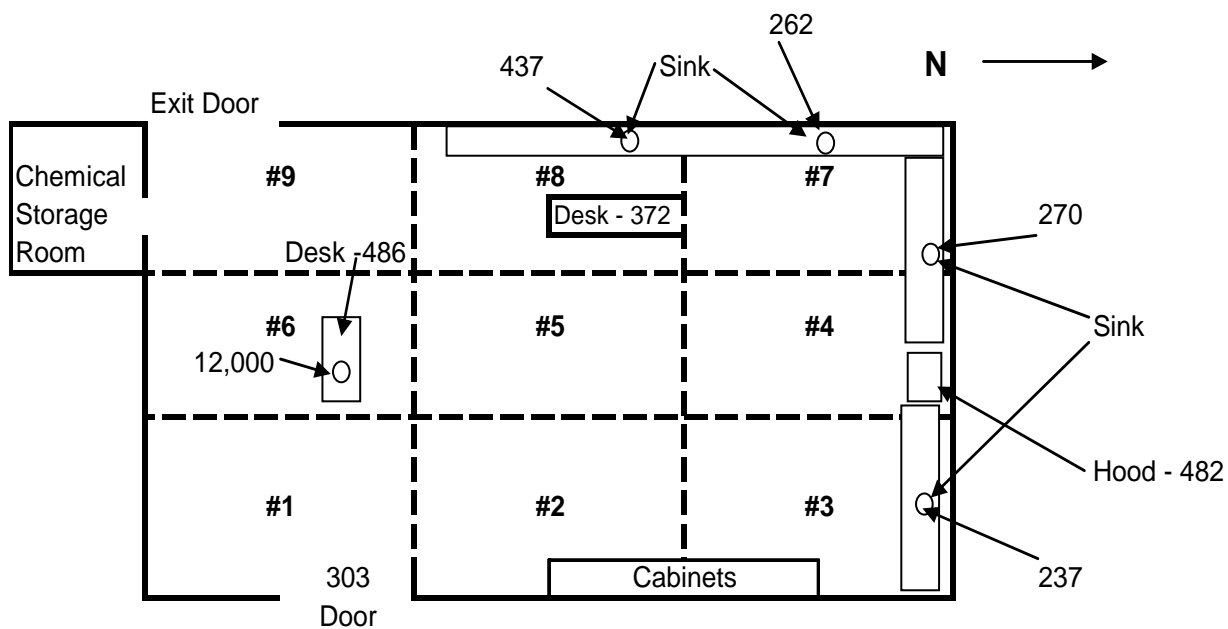

Grids

#1	311	#5	602
#2	308	#6	766
#3	252	#7	475
#4	574	#8	284
		#9	341

Legend

Concentrations
measured in
nanograms per
cubic meter

Concentrations
measured at floor
level

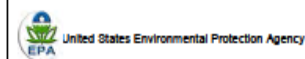
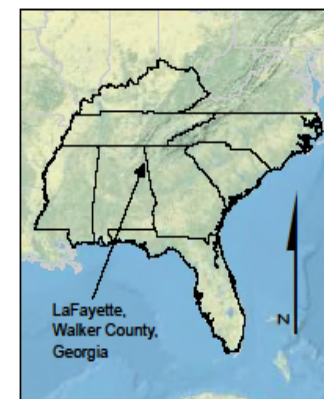

LAFAYETTE HIGH SCHOOL
MERCURY RELEASE
LAFAYETTE, WALKER
COUNTY, GEORGIA
TDD No. TNA-05-001-0120

**FIGURE 6
ROOM 604 LAYOUT**



Room 604 - Chemical Storage Room Layout

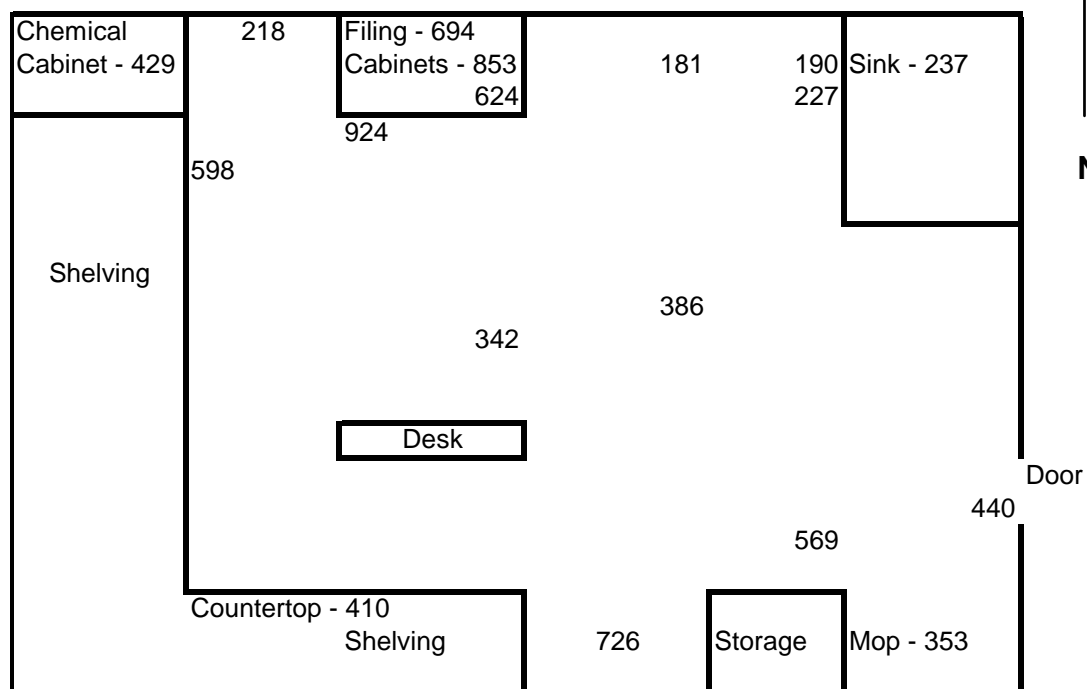

Legend

Concentrations
measured in
nanograms per
cubic meter

Concentrations
measured at floor
level

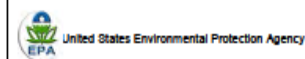
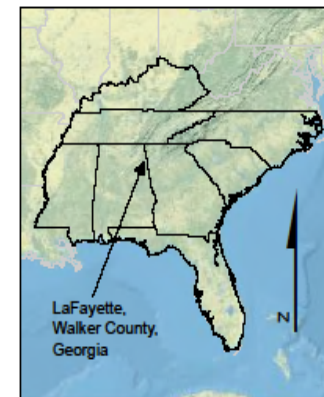

**LAFAYETTE HIGH SCHOOL
MERCURY RELEASE
LAFAYETTE, WALKER
COUNTY, GEORGIA
TDD No. TNA-05-001-0120**

**FIGURE 7
ROOM 604 – CHEMICAL
STORAGE ROOM
LAYOUT**



Room 605 Layout

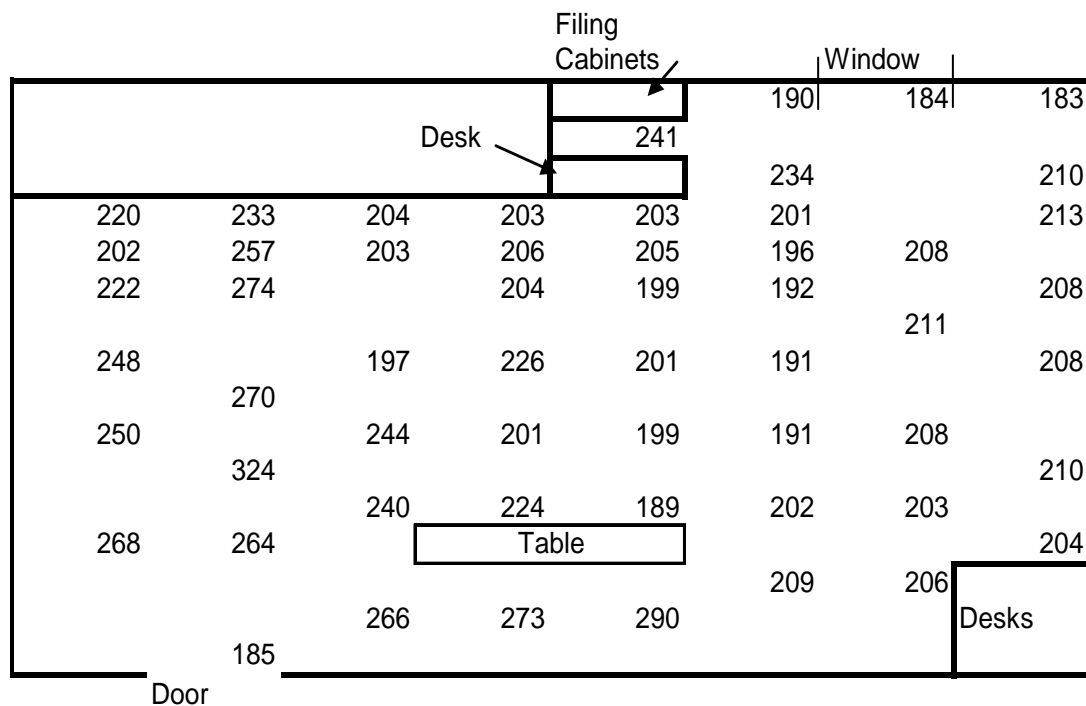

Legend

Concentrations
measured in
nanograms per
cubic meter

Concentrations
measured at floor
level

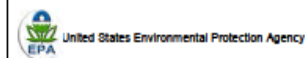
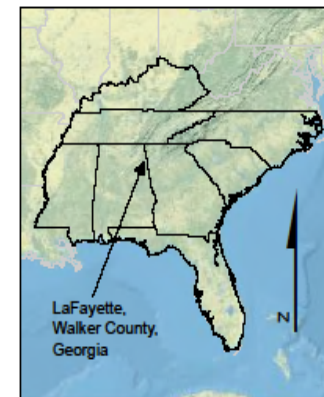

LAFAYETTE HIGH SCHOOL
MERCURY RELEASE
LAFAYETTE, WALKER
COUNTY, GEORGIA
TDD No. TNA-05-001-0120

FIGURE 8
ROOM 605 LAYOUT



Mobile Unit #2 Layout

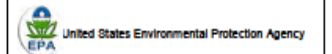
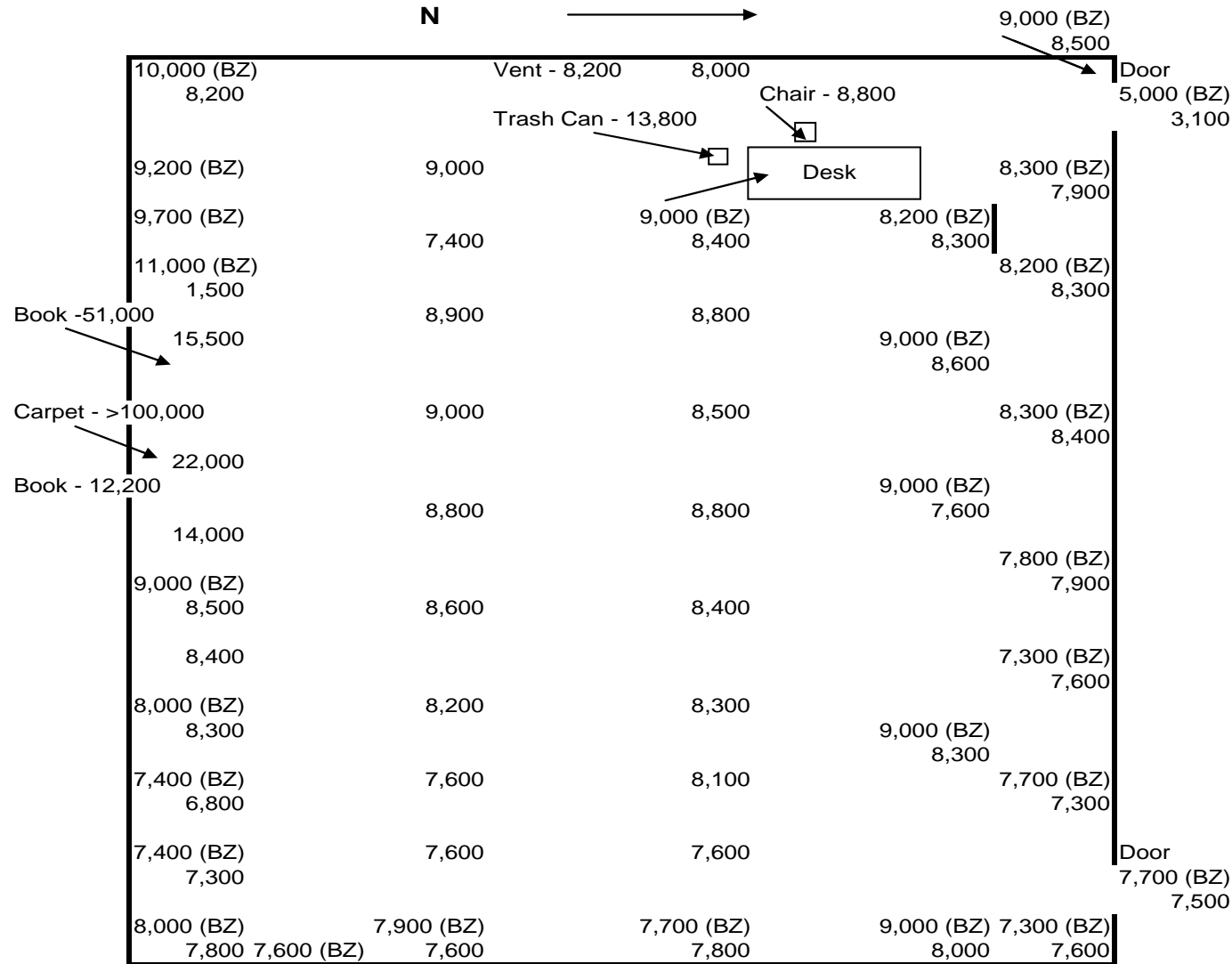

LAFAYETTE HIGH SCHOOL
MERCURY RELEASE
LAFAYETTE, WALKER
COUNTY, GEORGIA
TDD No. TNA-05-001-0120

FIGURE 9
MOBILE UNIT #2
LAYOUT



Room 400 Layout

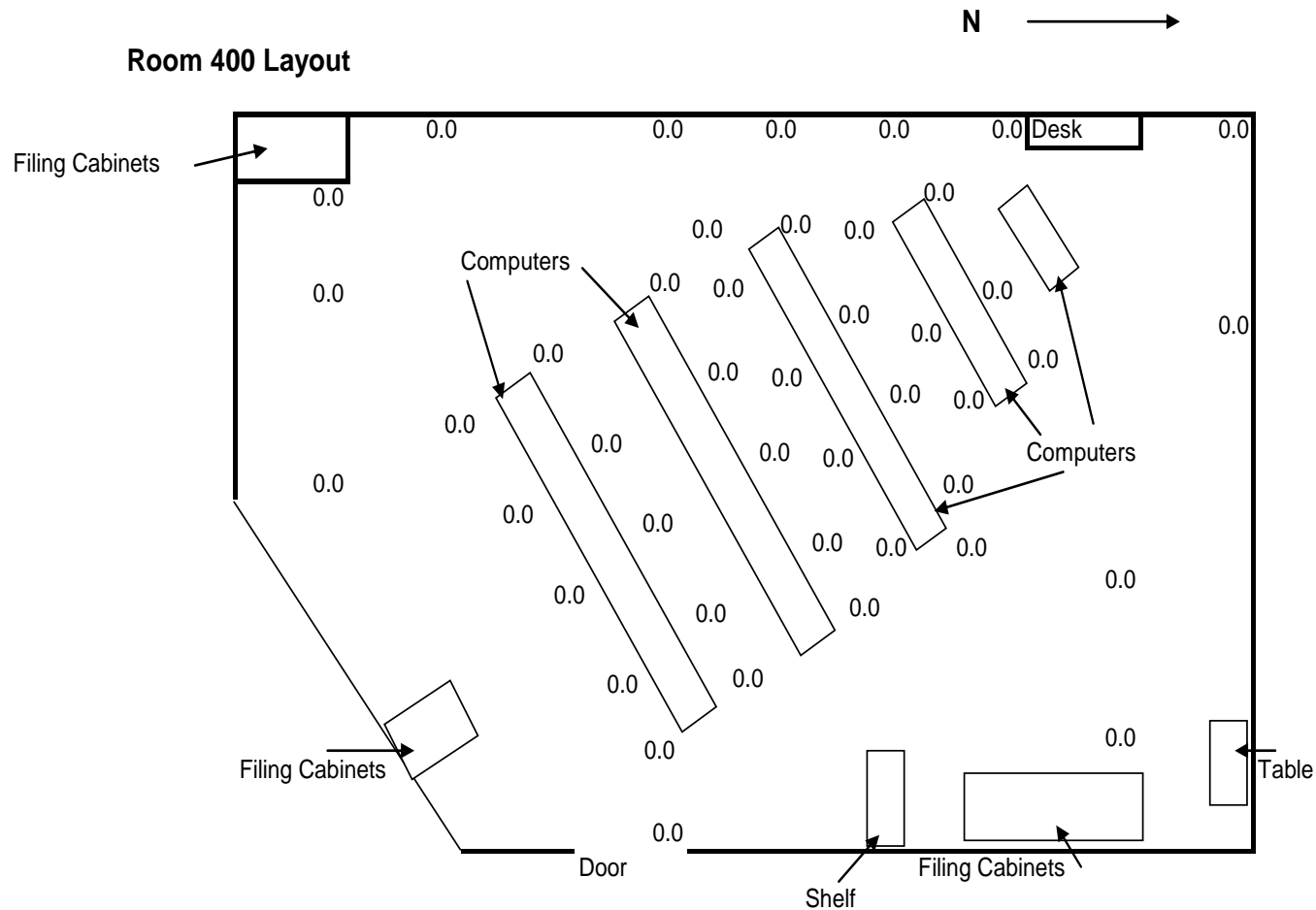

Legend

Concentrations
measured in
nanograms per
cubic meter

Concentrations
measured at floor
level

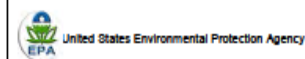
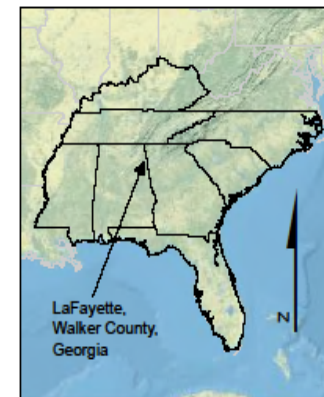

LAFAYETTE HIGH SCHOOL
MERCURY RELEASE
LAFAYETTE, WALKER
COUNTY, GEORGIA
TDD No. TNA-05-001-0120

FIGURE 10
ROOM 400 LAYOUT



Room 502 Layout

N →

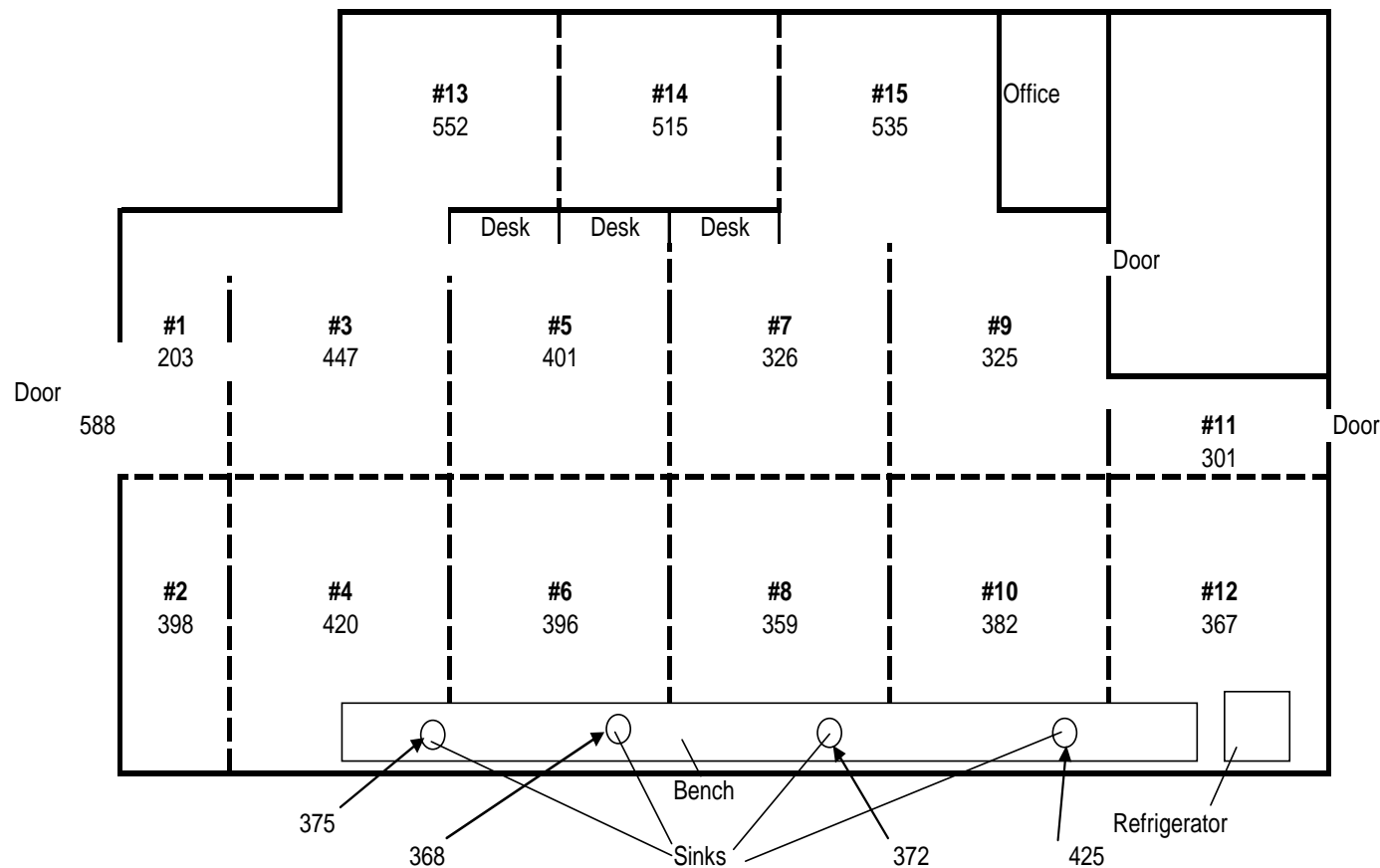

Legend

Concentrations
measured in
nanograms per
cubic meter

Concentrations
measured at floor
level

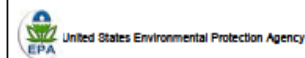
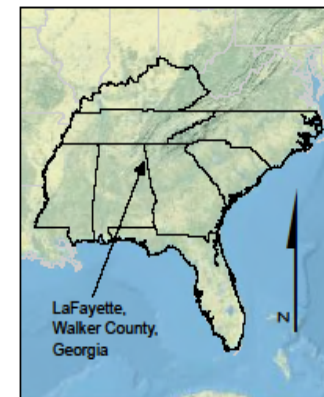

LAFAYETTE HIGH SCHOOL
MERCURY RELEASE
LAFAYETTE, WALKER
COUNTY, GEORGIA
TDD No. TNA-05-001-0120

FIGURE 11
ROOM 502 LAYOUT



Room 505 Layout

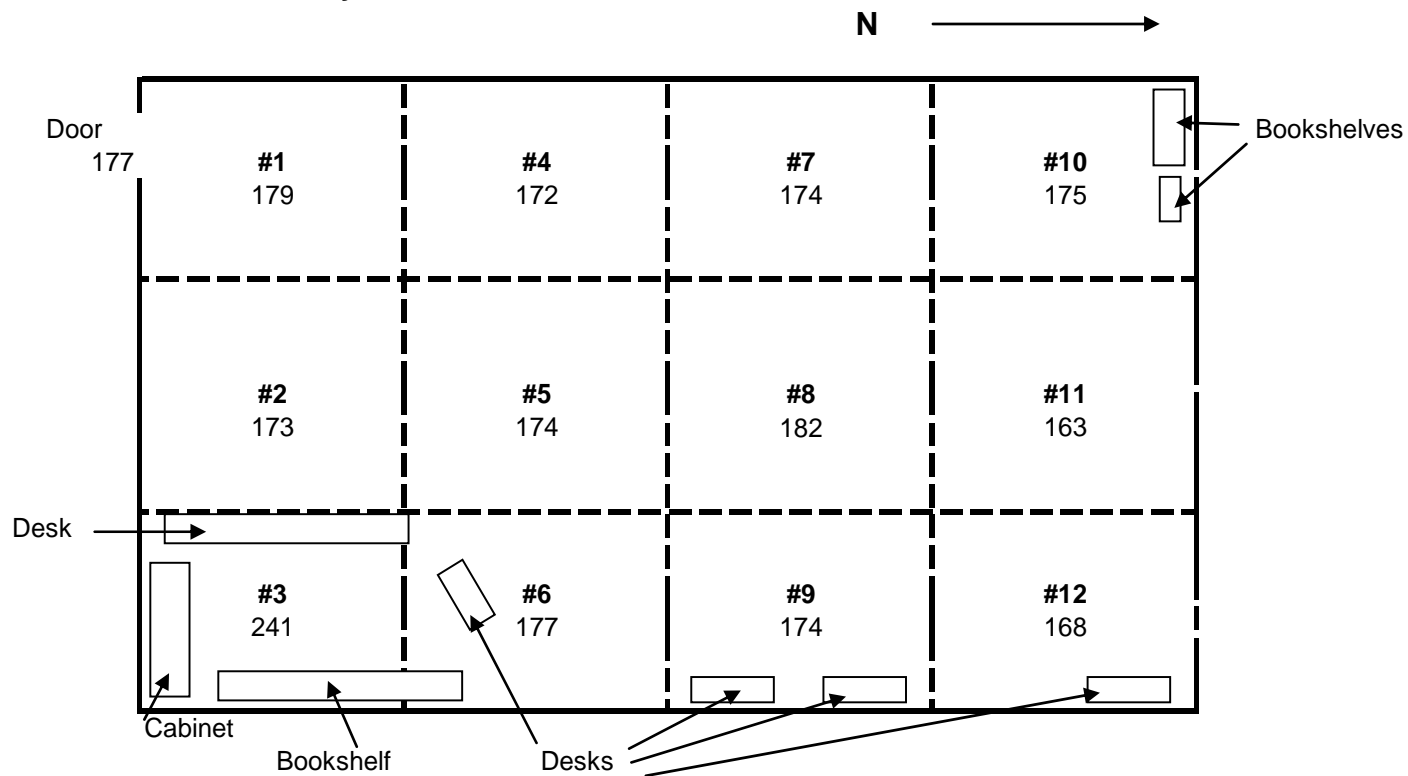

Legend

Concentrations
measured in
nanograms per
cubic meter

Concentrations
measured at floor
level

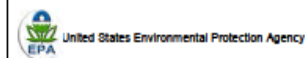
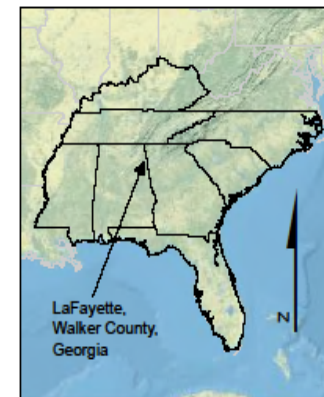

**LAFAYETTE HIGH SCHOOL
MERCURY RELEASE
LAFAYETTE, WALKER
COUNTY, GEORGIA
TDD No. TNA-05-001-0120**

**FIGURE 12
ROOM 505 LAYOUT**



Legend

**Concentrations
measured in
nanograms per
cubic meter**

Concentrations measured at floor level

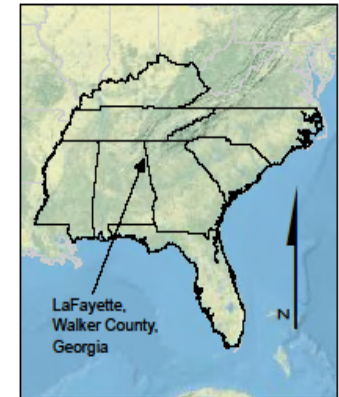

LAFAYETTE HIGH SCHOOL
MERCURY RELEASE
LAFAYETTE, WALKER
COUNTY, GEORGIA
TDD No. TNA-05-001-0120

FIGURE 13
ROOM 607 LAYOUT



ENGIS Workspace\LaFayette High School Hg ER #1295

Room 607 Layout

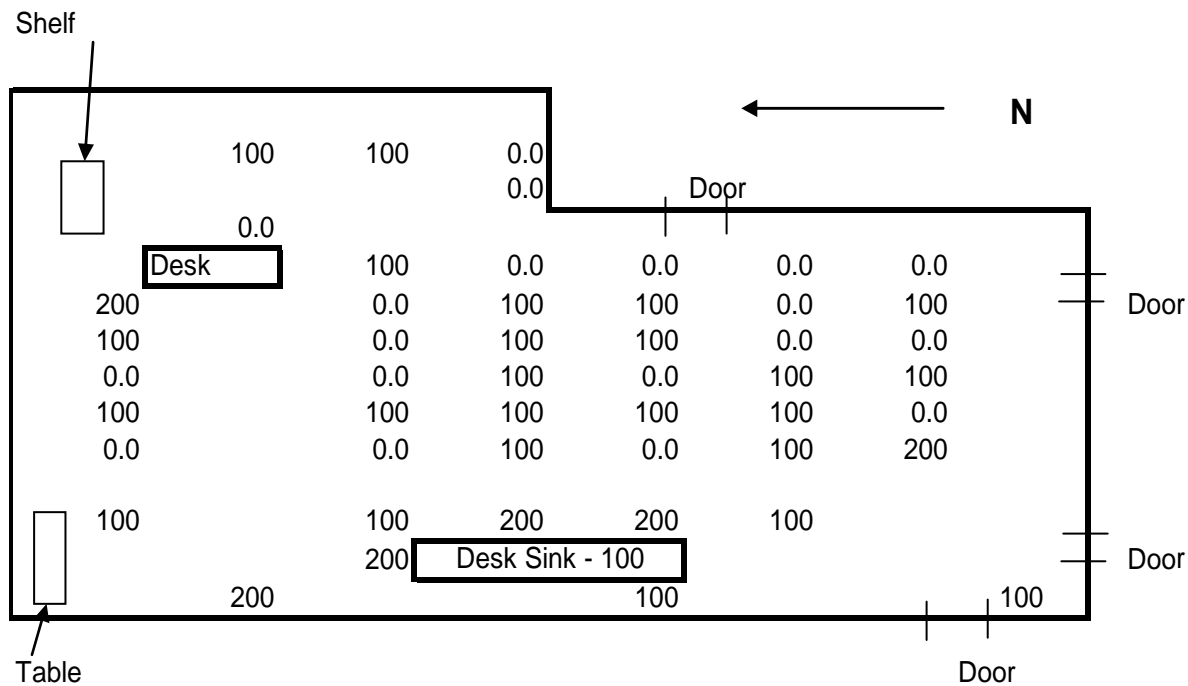

Room 708 Layout

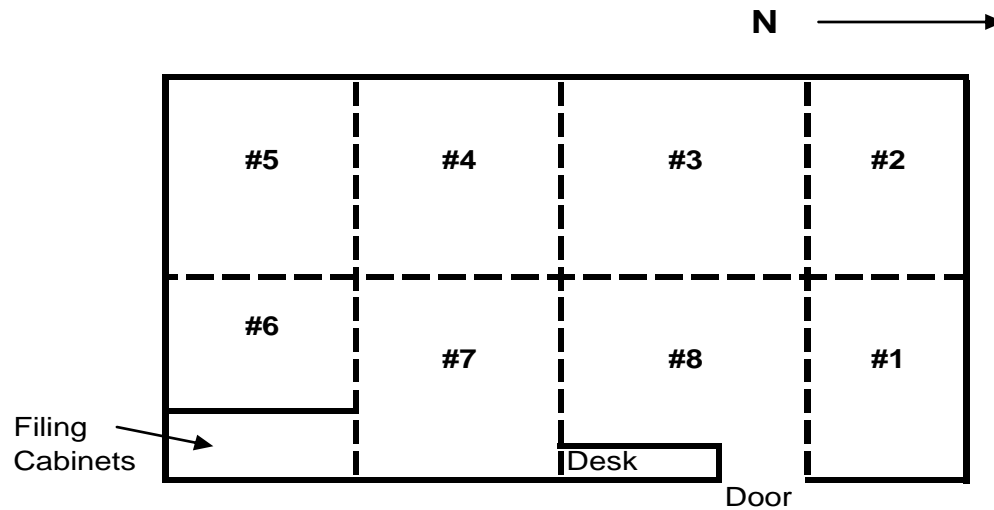

Grids

#1	106	#5	94
#2	112	#6	98
#3	95	#7	110
#4	92	#8	96

Legend

Concentrations
measured in
nanograms per
cubic meter

Concentrations
measured at floor
level

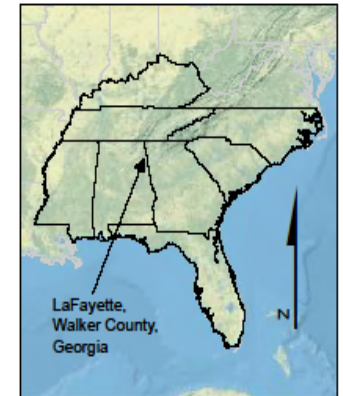

LAFAYETTE HIGH SCHOOL
MERCURY RELEASE
LAFAYETTE, WALKER
COUNTY, GEORGIA
TDD No. TNA-05-001-0120

FIGURE 14
ROOM 708 LAYOUT



Room 709 Layout

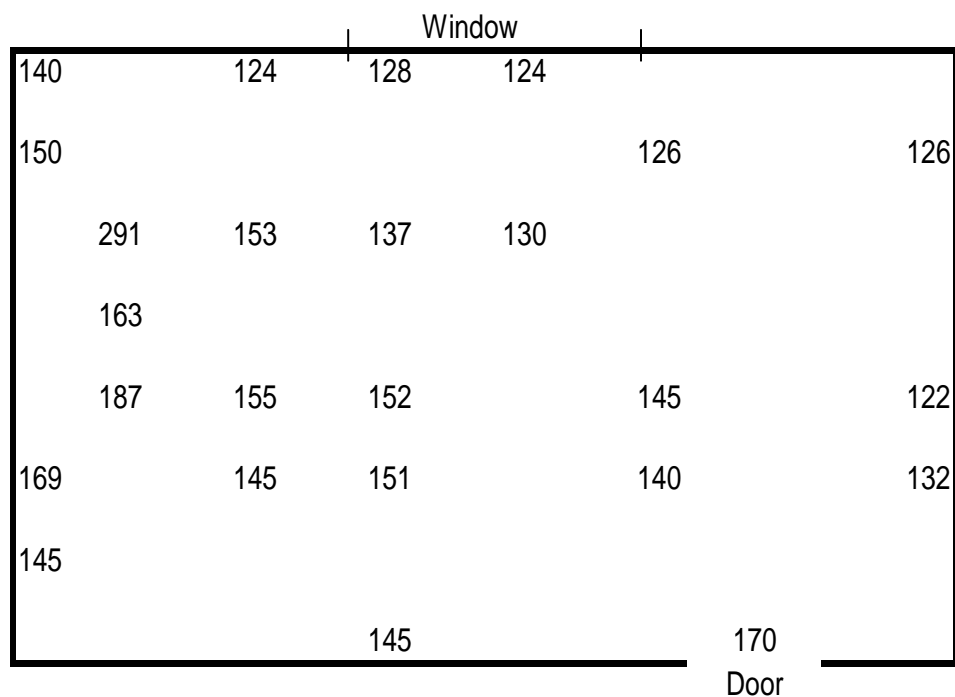

Legend

Concentrations
measured in
nanograms per
cubic meter

Concentrations
measured at floor
level

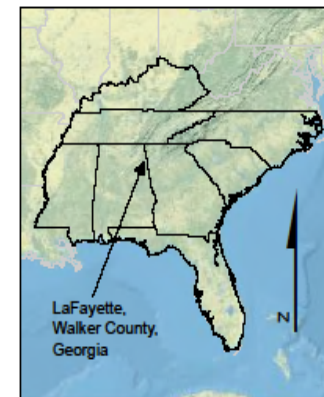

United States Environmental Protection Agency

**LAFAYETTE HIGH SCHOOL
MERCURY RELEASE
LAFAYETTE, WALKER
COUNTY, GEORGIA
TDD No. TNA-05-001-0120**

**FIGURE 15
ROOM 709 LAYOUT**



N

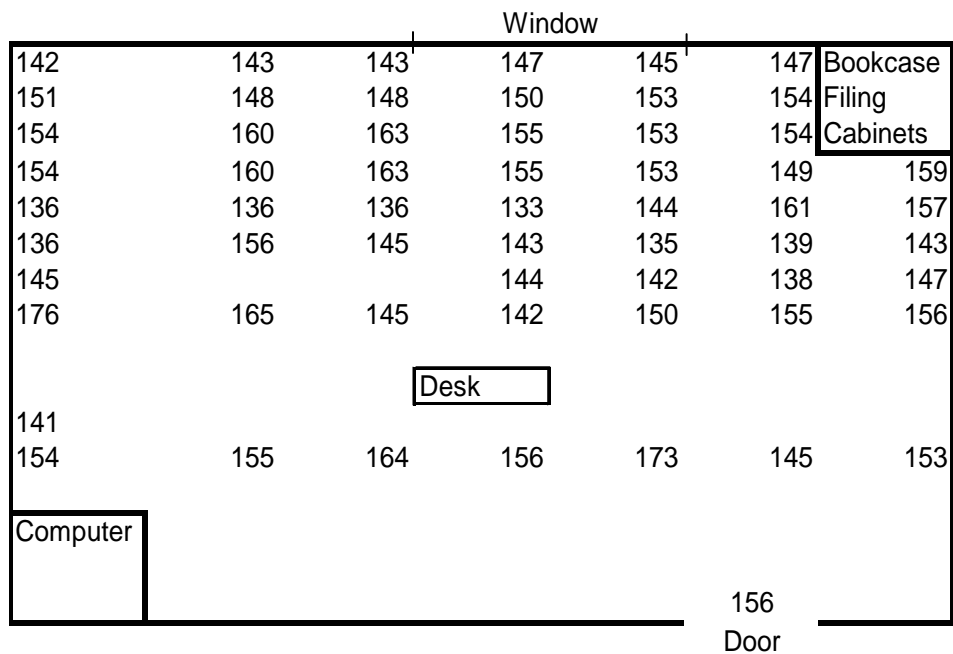

Legend

**Concentrations
measured in
nanograms per
cubic meter**

Concentrations measured at floor level

 United States Environmental Protection Agency

LAFAYETTE HIGH SCHOOL
MERCURY RELEASE
LAFAYETTE, WALKER
COUNTY, GEORGIA
TDD No. TNA-05-001-0120

FIGURE 16
ROOM 710 LAYOUT



Gym - Upper Level Layout

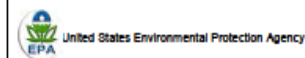
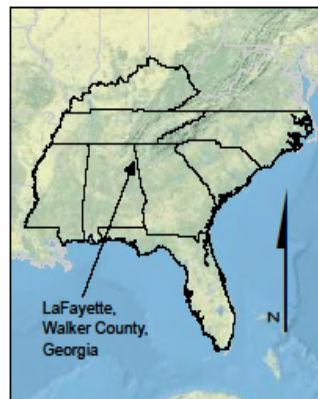
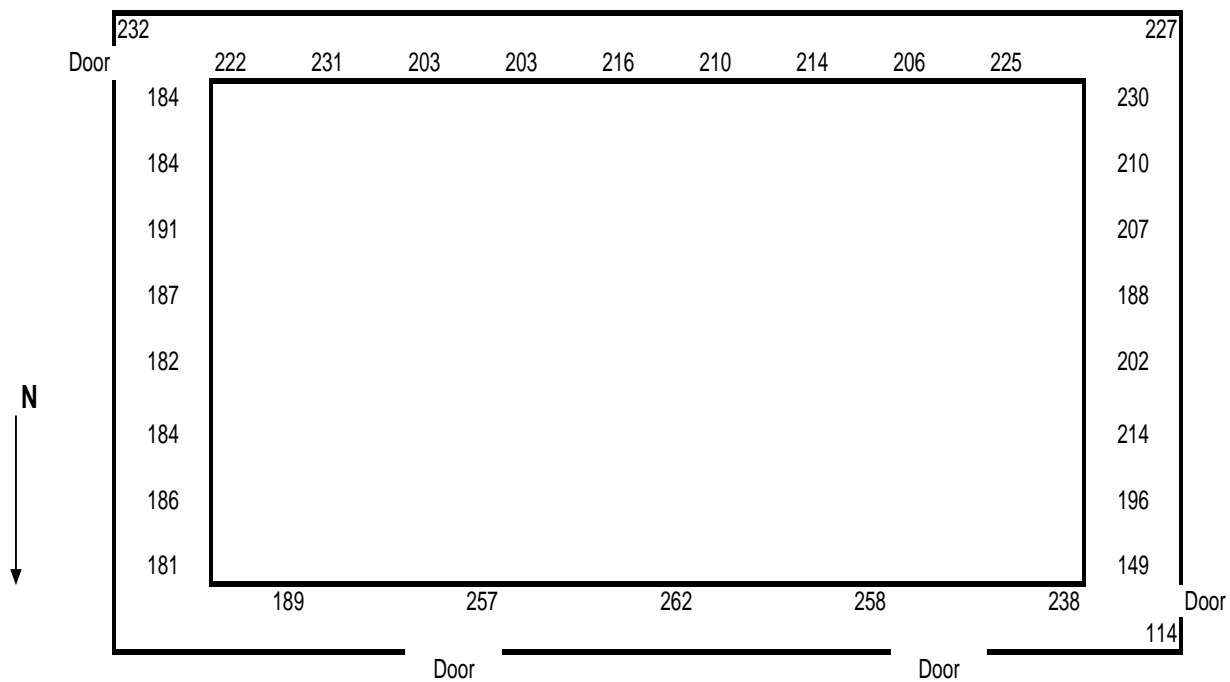

**LAFAYETTE HIGH SCHOOL
MERCURY RELEASE
LAFAYETTE, WALKER
COUNTY, GEORGIA
TDD No. TNA-05-001-0120**

**FIGURE 17
GYM – UPPER LEVEL
LAYOUT**



[illegible]

222	222
-----	-----

295	268
-----	-----

- 1) 231
- 2) 219
- 3) 230
- 4) 238

Garbage Can - 360

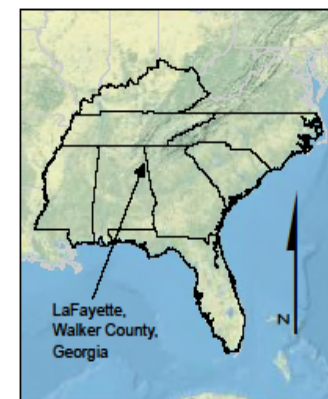

LAFAYETTE HIGH SCHOOL
MERCURY RELEASE
LAFAYETTE, WALKER
COUNTY, GEORGIA
TDD No. TNA-05-001-0120

**FIGURE 18
GYM – LOWER
LEVEL LAYOUT**



Auditorium Layout

STAGE

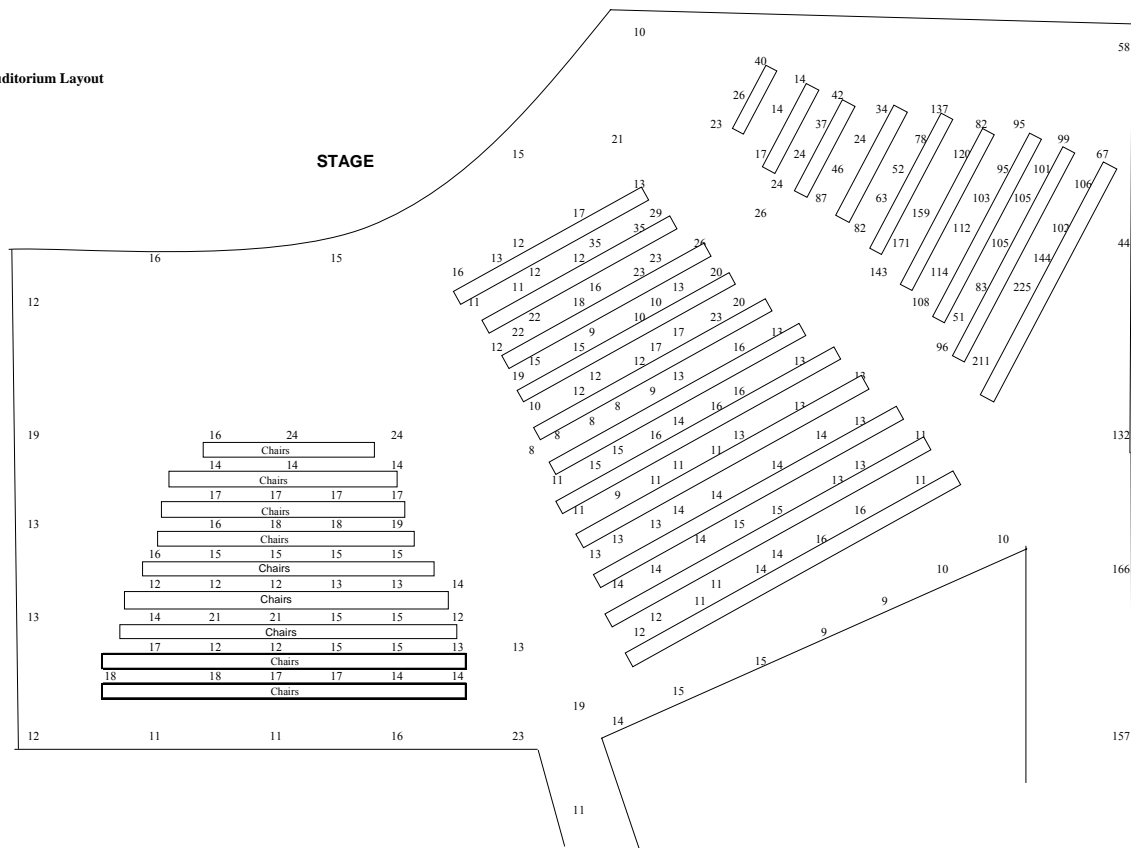

Legend

Concentrations
measured in
nanograms per
cubic meter

Concentrations
measured at floor
level



**LAFAYETTE HIGH SCHOOL
MERCURY RELEASE
LAFAYETTE, WALKER
COUNTY, GEORGIA
TDD No. TNA-05-001-0120**

**FIGURE 19
AUDITORIUM
LAYOUT**



Room 805 Layout

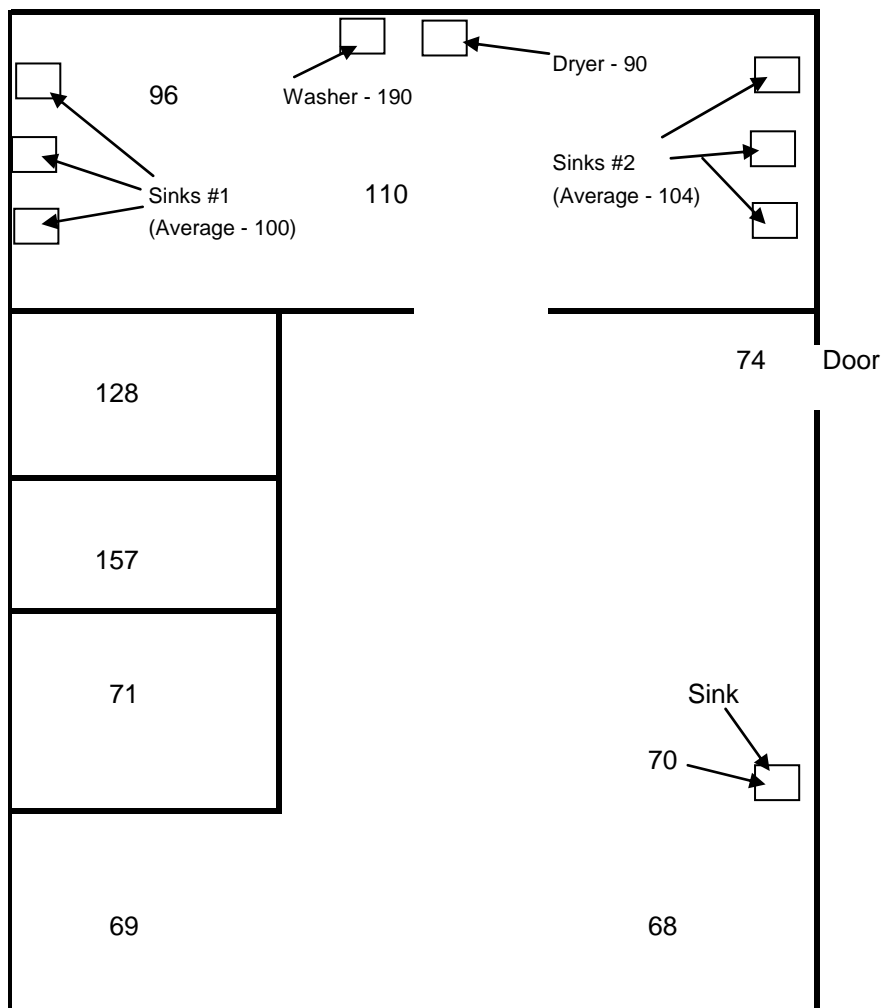

Legend

Concentrations measured in nanograms per cubic meter

Concentrations measured at floor level

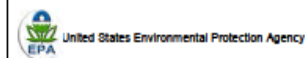
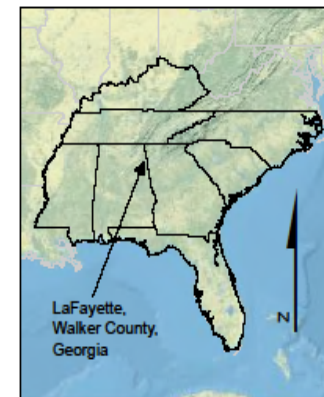

LAFAYETTE HIGH SCHOOL
MERCURY RELEASE
LAFAYETTE, WALKER
COUNTY, GEORGIA
TDD No. TNA-05-001-0120

FIGURE 20
ROOM 805 LAYOUT



Janitors Closet Layout - Administrative Offices

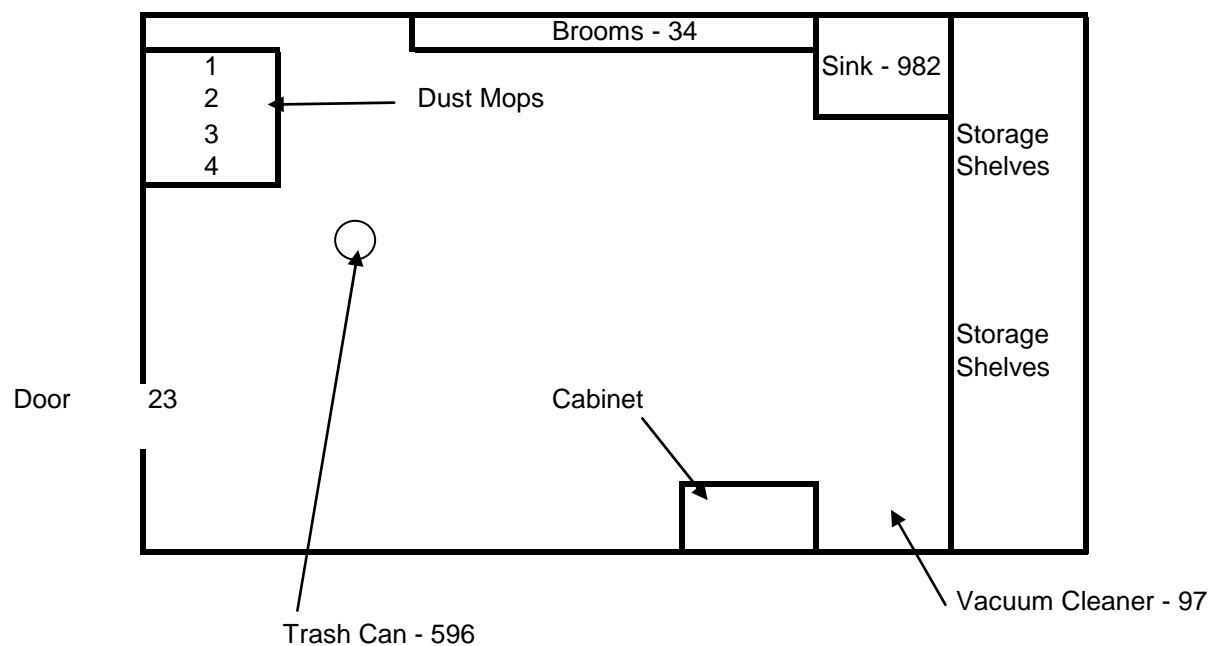

Dust Mops

- 1) 176
- 2) 34
- 3) 94
- 4) 43

Legend

Concentrations
measured in
nanograms per
cubic meter

Concentrations
measured at floor
level

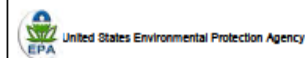
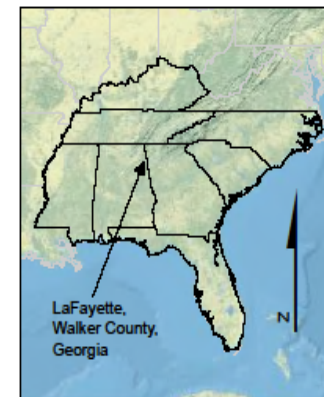

**LAFAYETTE HIGH SCHOOL
MERCURY RELEASE
LAFAYETTE, WALKER
COUNTY, GEORGIA
TDD No. TNA-05-001-0120**

**FIGURE 21
JANITORS CLOSET –
ADMINISTRATIVE
OFFICES LAYOUT**



Janitors Closet - 300 Wing Layout

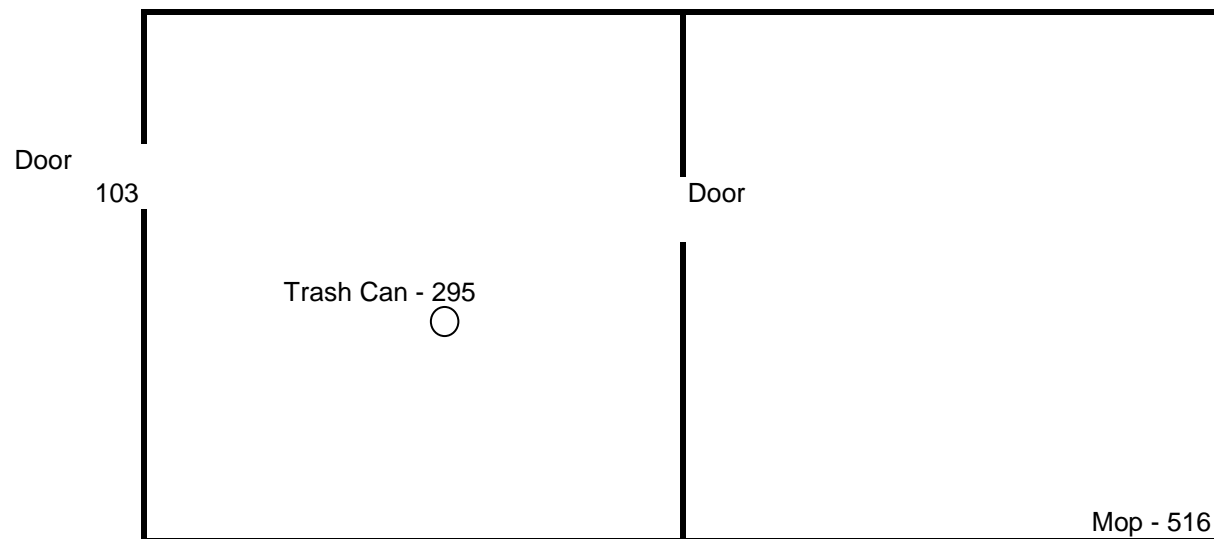

Mops		Dustpan - 454
1) 127	4) 516	Brooms
2) 168	5) 181	1) 114
3) 270	6) 140	2) 180

Legend

Concentrations
measured in
nanograms per
cubic meter

Concentrations
measured at floor
level

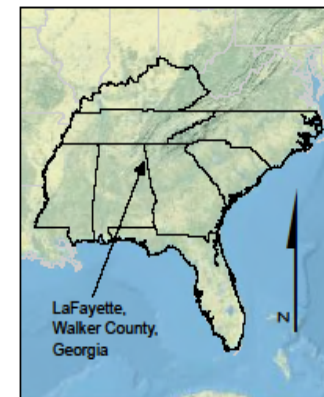

United States Environmental Protection Agency

LAFAYETTE HIGH SCHOOL
MERCURY RELEASE
LAFAYETTE, WALKER
COUNTY, GEORGIA
TDD No. TNA-05-001-0120

FIGURE 22
JANITORS CLOSET –
300 WING LAYOUT



Janitors Closet - 700 Wing

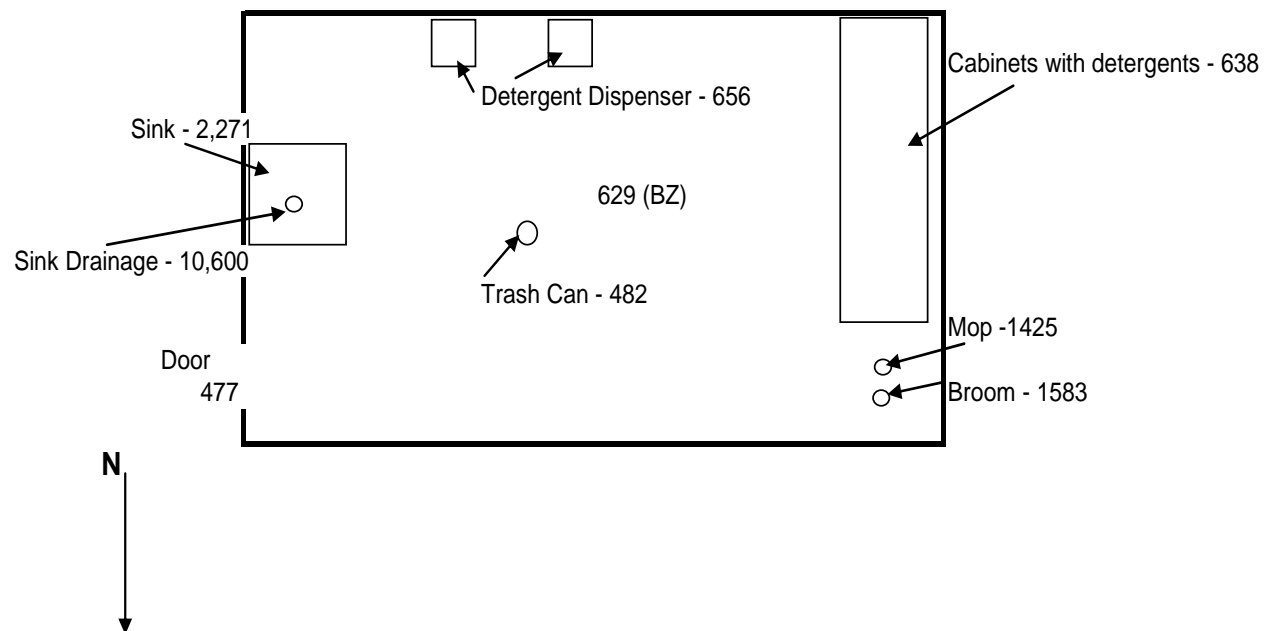

Legend

Concentrations
measured in
nanograms per
cubic meter

Concentrations
measured at floor
level

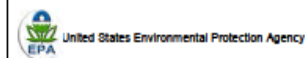
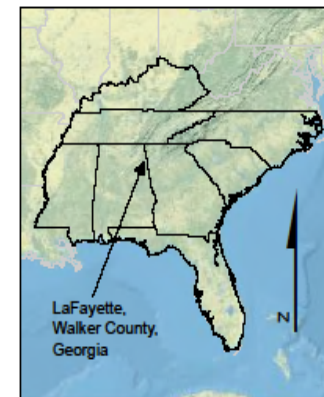

LAFAYETTE HIGH SCHOOL
MERCURY RELEASE
LAFAYETTE, WALKER
COUNTY, GEORGIA
TDD No. TNA-05-001-0120

FIGURE 23
JANITORS CLOSET –
700 WING LAYOUT



Janitors Closet Layout - Cafeteria

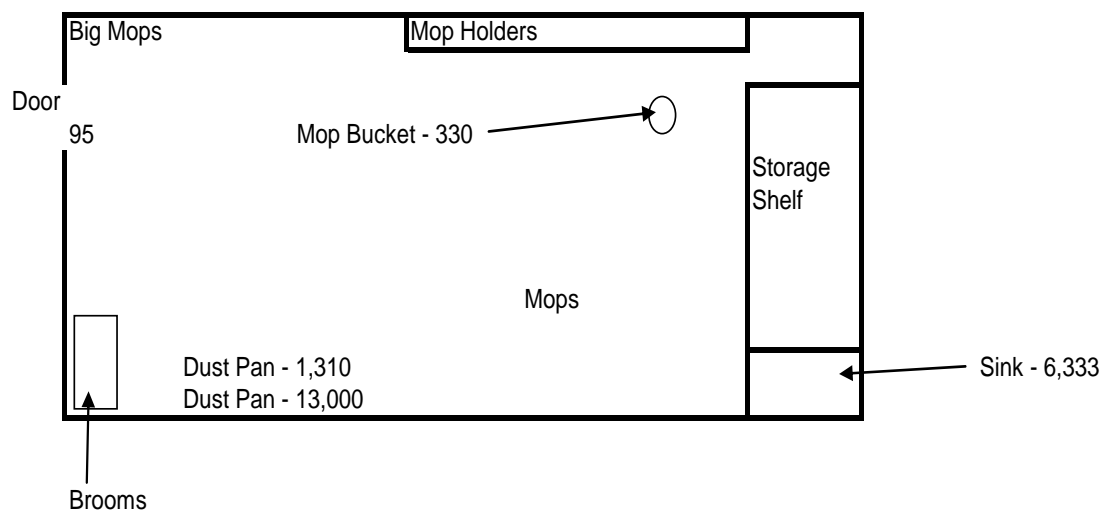

Brooms

- | | |
|--------|--------|
| 1) 253 | 4) 230 |
| 2) 258 | 5) 130 |
| 3) 182 | 6) 127 |

Mops

- | |
|----------|
| 1) 1,527 |
| 2) 2,324 |
| 3) 3,255 |

Legend

Concentrations
measured in
nanograms per
cubic meter

Concentrations
measured at floor
level

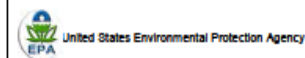
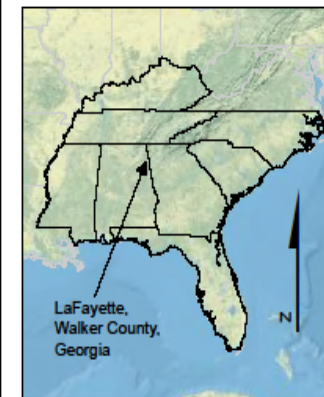

**LAFAYETTE HIGH SCHOOL
MERCURY RELEASE
LAFAYETTE, WALKER
COUNTY, GEORGIA
TDD No. TNA-05-001-0120**

**FIGURE 24
JANITORS CLOSET -
CAFETERIA LAYOUT**



Room 802 Layout

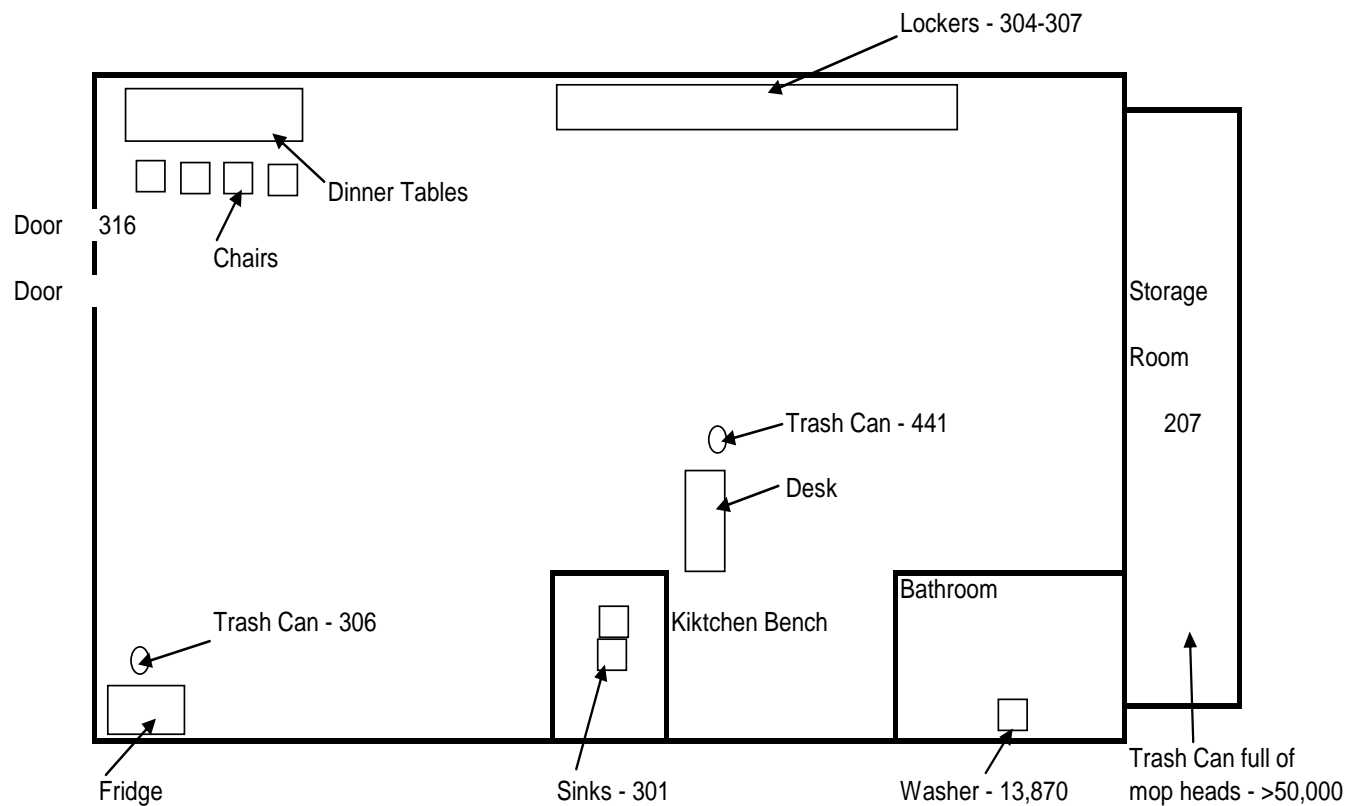

Legend

Concentrations
measured in
nanograms per
cubic meter

Concentrations
measured at floor
level

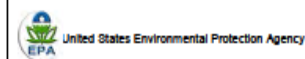
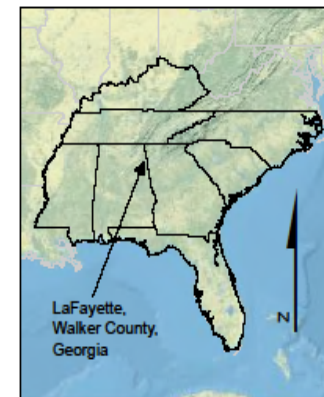

LAFAYETTE HIGH SCHOOL
MERCURY RELEASE
LAFAYETTE, WALKER
COUNTY, GEORGIA
TDD No. TNA-05-001-0120

FIGURE 25
ROOM 802 LAYOUT



Janitors Closet Layout - 600 Wing

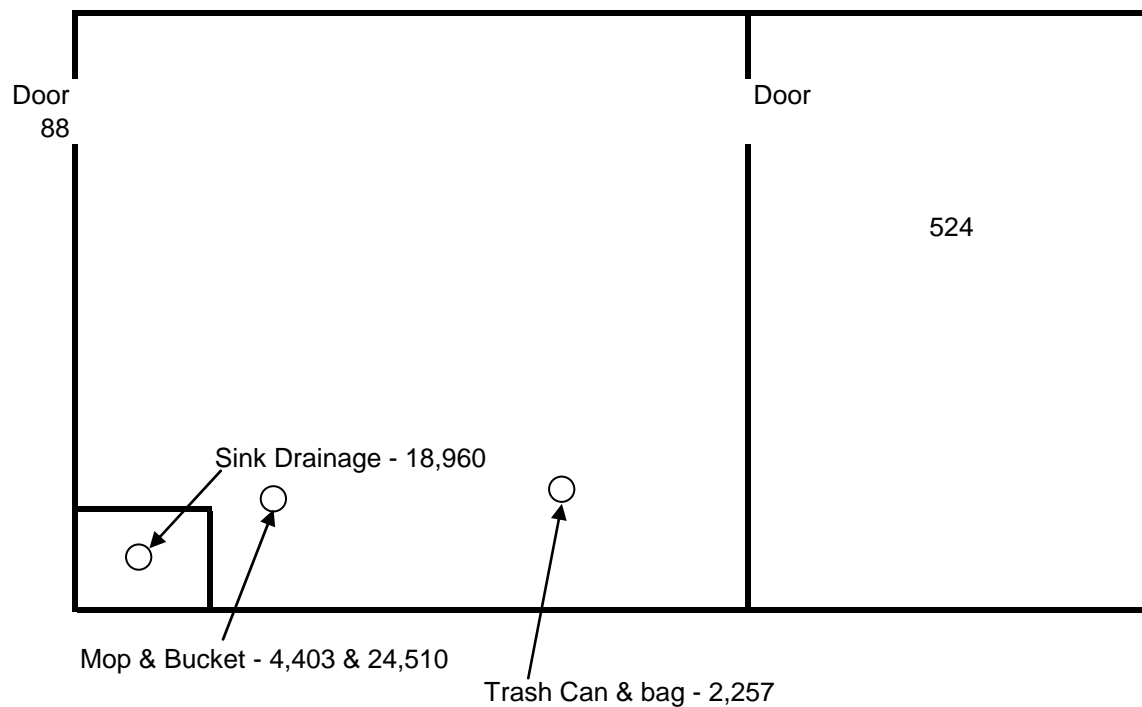

Legend

Concentrations
measured in
nanograms per
cubic meter

Concentrations
measured at floor
level

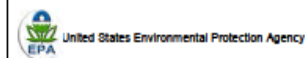
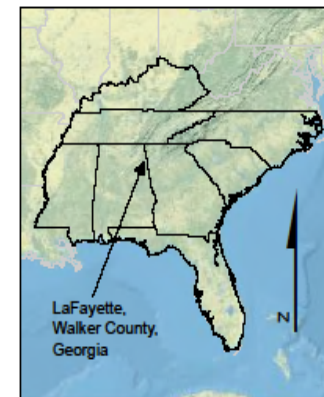

**LAFAYETTE HIGH SCHOOL
MERCURY RELEASE
LAFAYETTE, WALKER
COUNTY, GEORGIA
TDD No. TNA-05-001-0120**

**FIGURE 26
JANITORS CLOSET –
600 WING LAYOUT**



Janitors Closet - 400 Wing Layout

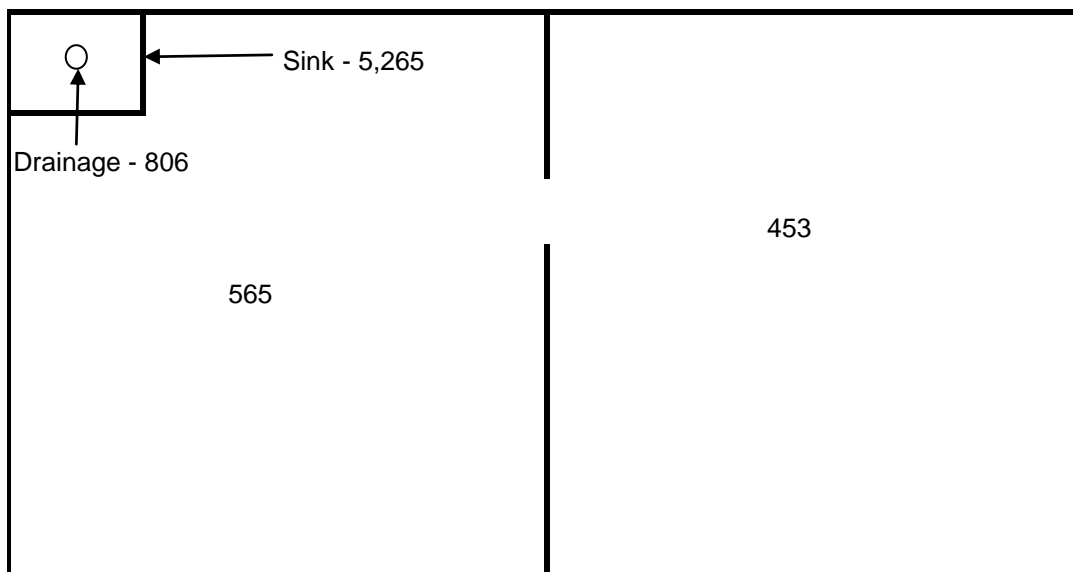

Broom - 263
 Small Dustpan - 254
 Big Dustpan - 1,042
 Trash Can - 1,182
 Mop Head #1 - 462
 Mop Head #2 - 840
 Mop Head #3 - 410

Bucket #1 - 302
 Bucket #2 - 769

Legend

Concentrations
 measured in
 nanograms per
 cubic meter

Concentrations
 measured at floor
 level

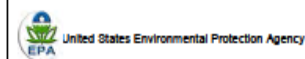
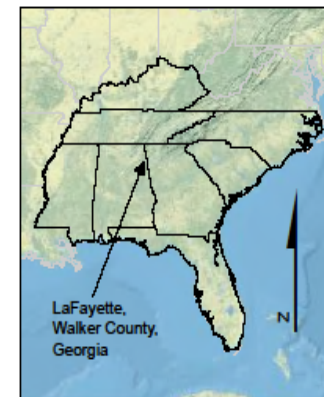

LAFAYETTE HIGH SCHOOL
MERCURY RELEASE
LAFAYETTE, WALKER
COUNTY, GEORGIA
 TDD No. TNA-05-001-0120

FIGURE 27
JANITORS CLOSET –
400 WING LAYOUT



Gym - Boys Locker Room Layout

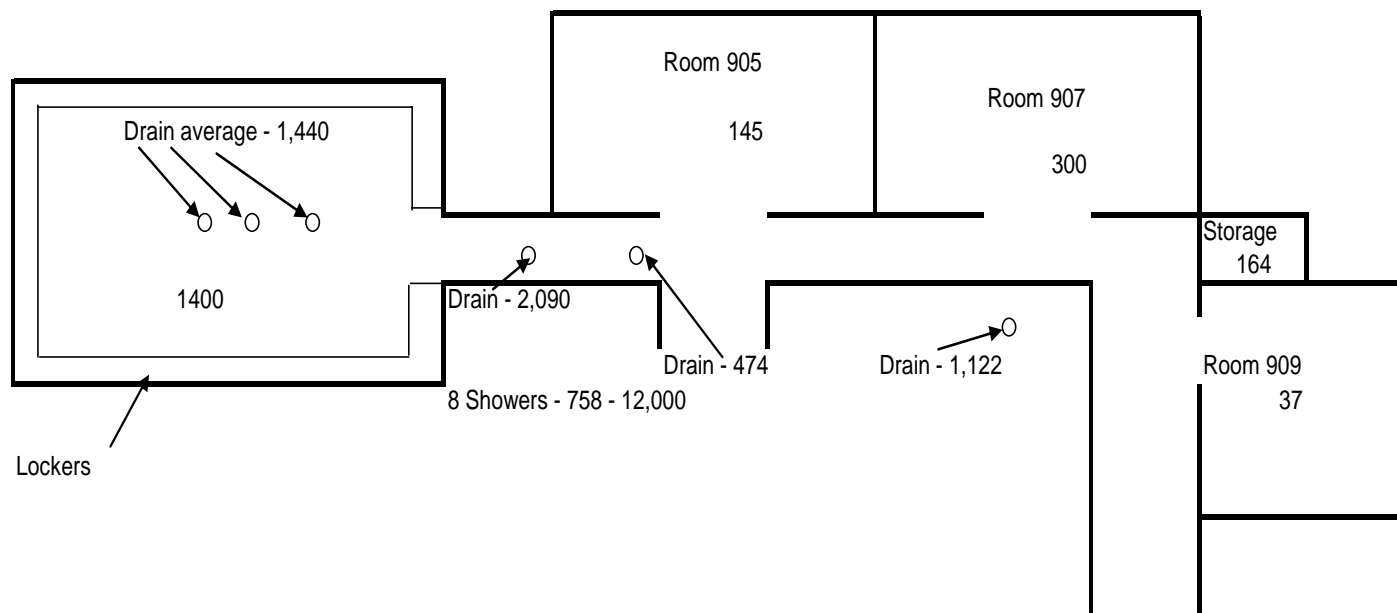

Legend

Concentrations
measured in
nanograms per
cubic meter

Concentrations
measured at floor
level

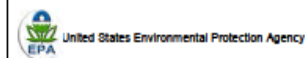
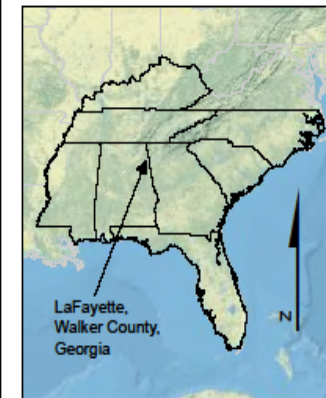

**LAFAYETTE HIGH SCHOOL
MERCURY RELEASE
LAFAYETTE, WALKER
COUNTY, GEORGIA
TDD No. TNA-05-001-0120**

**FIGURE 28
GYM - BOYS LOCKER
ROOM LAYOUT**



Room 930 - Weight Room Layout

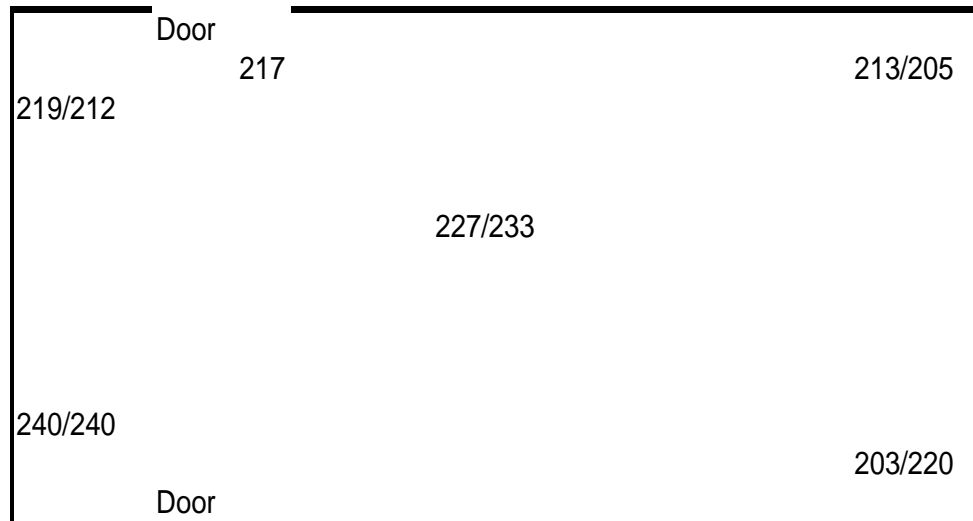

Legend

Concentrations
measured in
nanograms per
cubic meter

xx/xx - Breathing
Zone/Floor

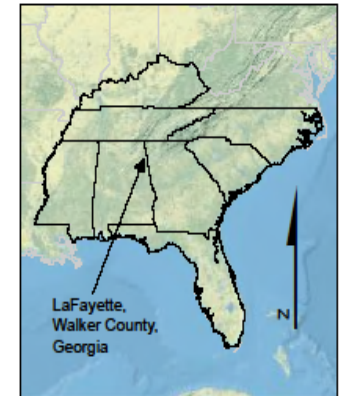

**LAFAYETTE HIGH SCHOOL
MERCURY RELEASE
LAFAYETTE, WALKER
COUNTY, GEORGIA
TDD No. TNA-05-001-0120**

**FIGURE 29
ROOM 930 LAYOUT**



Bus #33 Layout

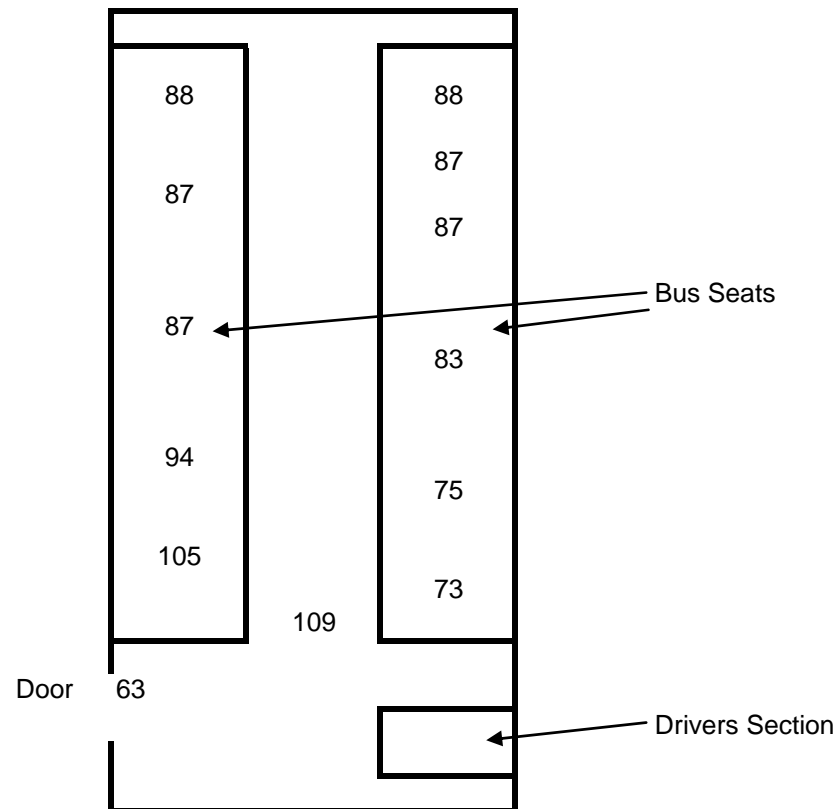

Legend

Concentrations
measured in
nanograms per
cubic meter

Concentrations
measured at floor
level

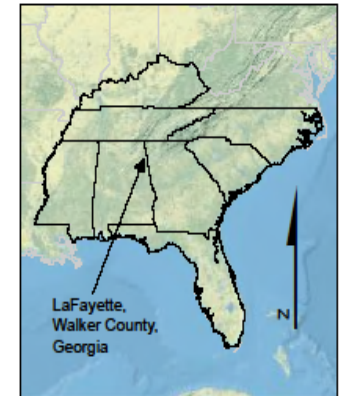

LAFAYETTE HIGH SCHOOL
MERCURY RELEASE
LAFAYETTE, WALKER
COUNTY, GEORGIA
TDD No. TNA-05-001-0120

**FIGURE 30
BUS #33 LAYOUT**



Bus #49 Layout

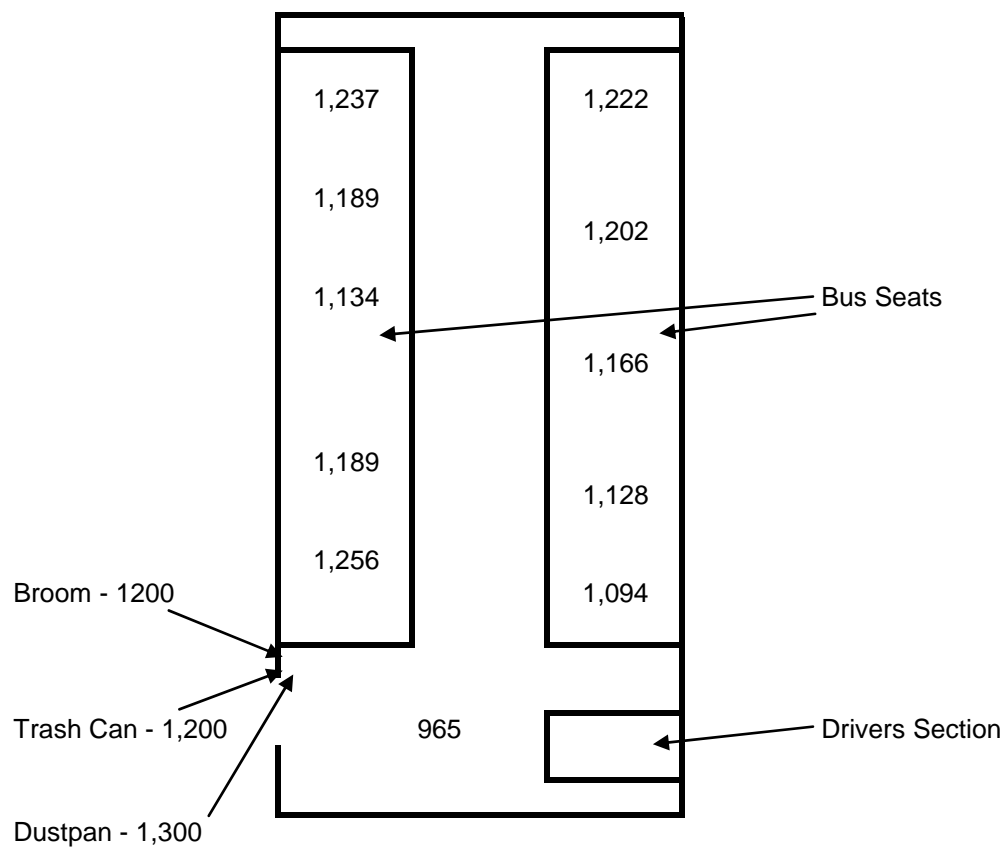

Legend

Concentrations measured in nanograms per cubic meter

Concentrations measured at floor level

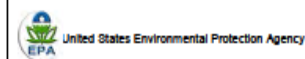
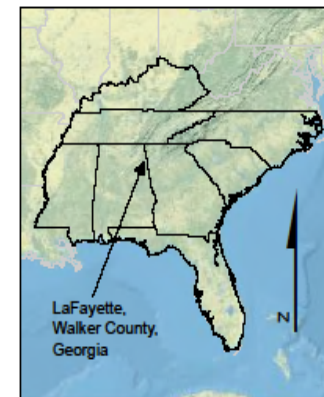

LAFAYETTE HIGH SCHOOL
MERCURY RELEASE
LAFAYETTE, WALKER
COUNTY, GEORGIA
TDD No. TNA-05-001-0120

FIGURE 31
BUS #49 LAYOUT



Bus #88 Layout

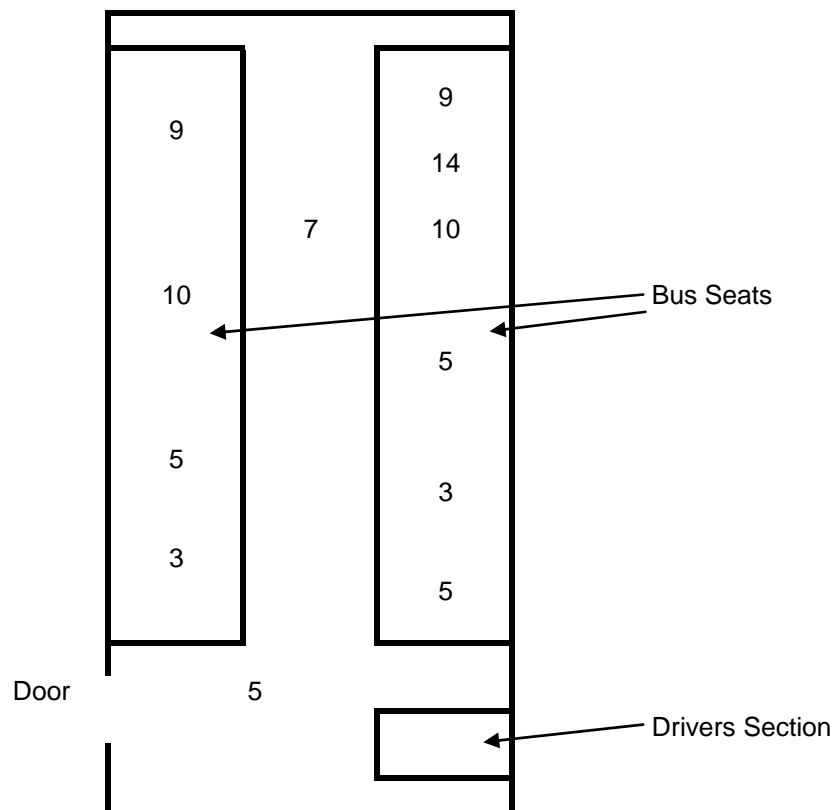

Legend

Concentrations
measured in
nanograms per
cubic meter

Concentrations
measured at floor
level

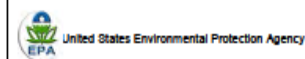
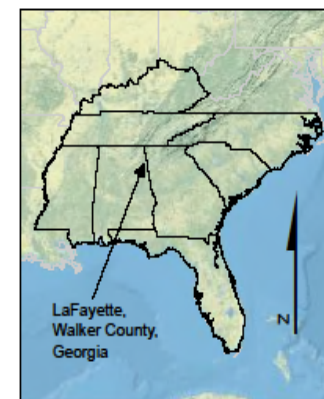

**LAFAYETTE HIGH SCHOOL
MERCURY RELEASE
LAFAYETTE, WALKER
COUNTY, GEORGIA
TDD No. TNA-05-001-0120**

**FIGURE 32
BUS #88 LAYOUT**



ATTACHMENT B
TABLES

TABLE 1
LAFAYETTE HIGH SCHOOL MERCURY RELEASE
TABLE OF MERCURY VAPOR SCREENING READINGS
ROOMS OF THE 100 WING

Room #	Section	Reading (ng/m ³)
106	1	60/61
	2	103/92
	3	69/68
107 - Mr. Browns Office	1	108
	2	118
108	1	133/133
110	1	119/119
116	1	106/109
117	1	170/162
	2	165/155
	3	144/140
118	1	88/88
	2	150/123
	3	99/93
	4	91/91
	5	90/90
	6	80/75
	7	97/122
	8	177/161
	9	160/190
	10	187/181
	11	119/120
	12	117/127
	13	107/104
	14	102/102
119	1	70
	2	78
	3	124
120	1	130/131
Principals Office	1	58
Theresa Whitten's Office	1	167

Notes:

ng/m³ = nanograms per cubic meter

##/## = Breathing Zone/Floor

= Floor

TABLE 2
LAFAYETTE HIGH SCHOOL MERCURY RELEASE
TABLE OF MERCURY VAPOR SCREENING READINGS
CLASSROOMS OF THE 200 WING

Room #	Section	Reading (ng/m ³)
200	1	108/147
	2	80/76
	3	76/77
	4	76/75
	5	75/75
201	1	232/109
	2	80/81
	3	74/73
	4	99/87
	5	97/84
203	1	170/167
	2	162/162
	3	158/160
	4	164/156
	5	153/155
	6	160/155
	7	159/159
	8	156/134
205	1	698/741
	2	671/689
	3	707/720
Electrical Room	1	171/205
Control Room	1	183/136
207	1	2,100/2,100
	2	1,876/1,862
	3	2,030/2,027
	4	2,164/2,143
	5	1,068/937
	6	1,990/2,004
	7	2,097/2,119
	8	3,000 - Trash Can
	9	738/506
	10	1022/943
	11	1,240/992
	12	331/202
	13	235
	14	181
	15	117
	16	120
	Back Door Rug	>50,000
	Vacuum	2,200
209	1	109/111
	2	111/111
	3	114/112
	4	113/113
	5	113/113
	6	131/135
	7	139/138
	8	Average 2 Sinks - 126
	9	Average 3 Sinks - 108
	10	120/125

TABLE 2
LAFAYETTE HIGH SCHOOL MERCURY RELEASE
TABLE OF MERCURY VAPOR SCREENING READINGS
CLASSROOMS OF THE 200 WING

200 Wing - Boys Bathroom	1	425/619
	2	754 (Floor Drain)
	3	424/494
	4	345 (Sink)
200 Wing - Girls Bathroom	1	355/361
	2	1,100 (Floor Drain)
	3	540/330
	4	432 (Sink)

Notes:

ng/m³ = nanograms per cubic meter

###/### = Breathing Zone/Floor

TABLE 3
LAFAYETTE HIGH SCHOOL MERCURY RELEASE
TABLE OF MERCURY VAPOR SCREENING READINGS
CLASSROOMS OF THE 300 WING

Room #	Section	Reading (ng/m ³)
301	1	81/44
	2	45/45
	3	47/47
302	1	52/52
	2	50/50
	3	52/51
	4	51/51
	5	51/53
303	1	165 (Sink Inside Bathroom)
	2	165/165
	3	170 (Sink Outside Bathroom)
	4	167/162
	5	165/164
	6	165/163
	7	163/164
	8	165/162
304	1	48/48
	2	50/49
	3	49/49
	4	50/48
	5	49/49
305	1	50/56
	2	52/51
	3	46/47
	4	47/46
	5	47/52
306	1	40/40
	2	44/47
	3	47/47
	4	47/46
	5	45/46
307	1	50/50
	2	50/50
	3	52/52
	4	51/51
	5	50/50
	6	40 (Sink)
	7	42/44
	8	43/42
	9	45/40
308	1	66/48
	2	38/39
309	1	35/35
	2	35/35
	3	34/34
	4	34/34
	5	33/33

TABLE 3
LAFAYETTE HIGH SCHOOL MERCURY RELEASE
TABLE OF MERCURY VAPOR SCREENING READINGS
CLASSROOMS OF THE 300 WING

310	1	59/61
	2	62/62
	3	66/66
	4	66/66
	5	66/68
312	1	34/34
	2	35/35
	3	34/34
	4	34/33
	5	33/33
314	1	38/37
	2	41/41
300 Wing - Boys Bathroom	1	251/285
	2	534 (Floor Drain)
	3	2,500 (Floor Drain)
	4	216/221
300 Wing - Girls Bathroom	1	214/1,000
	2	375 (Floor Drain)
	3	222/237
300 Wing Book Storage Room	1	40/40
	2	41/40

Notes:

ng/m³ = nanograms per cubic meter

##/## = Breathing Zone/Floor

TABLE 4
LAFAYETTE HIGH SCHOOL MERCURY RELEASE
TABLE OF MERCURY VAPOR SCREENING READINGS
CLASSROOMS OF THE 400 WING

Room #	Section	Reading (ng/m ³)
401	1	79/79
	2	80/80
	3	80/80
	4	81/81
	5	115/120
402	1	49/48
	2	48/48
	3	49/52
	4	55/53
	5	50/50
403	1	101 (Sink Inside Bathroom)
	2	104/101
	3	102 (Sink Outside Bathroom)
	4	106/108
	5	109/115
	6	120/109
	7	115/120
405	1	66/64
	2	59/60
	3	64/60
	4	59/50
	5	55/53
406	1	45/45
	2	45/46
	3	48/45
	4	46/45
	5	45/45
407	1	45/45
	2	45/43
	3	43/51
	4	46/43
	5	51/44
408	1	43/45
	2	57/57
	3	54/56
	4	56/55
	5	54/51
410	1	131/129
	2	145/142
	3	143/147
	4	160/172
	5	169/174
411	1	158/121
	2	124/109
	3	95/100
	4	89/88
	5	82/82
	6	92/103
	7	105/101

TABLE 4
LAFAYETTE HIGH SCHOOL MERCURY RELEASE
TABLE OF MERCURY VAPOR SCREENING READINGS
CLASSROOMS OF THE 400 WING

400 Wing - Boys Bathroom	1	415 (Floor Drain)
	2	212/262
	3	322/961
	Base Partition	1,200
	2 - Sinks	Average - 408
400 Wing - Girls Bathroom	1	640 (Floor Drain)
	2	493/522
	3	364/402
	2 - Sinks	Average - 513
400 Wing Book Storage Room	1	82/76
	2	84/85

Notes:

ng/m³ = nanograms per cubic meter
###/## = Breathing Zone/Floor

TABLE 5
LAFAYETTE HIGH SCHOOL MERCURY RELEASE
TABLE OF MERCURY VAPOR SCREENING READINGS
CLASSROOMS OF THE 500 WING

Room #	Section	Reading (ng/m ³)
500	1	179/189
	2	155/146
	3	119/118
	4	144/163
	5	166/162
	6	141/140
	7	149 (Sink)
	8	149/151
	9	155/154
	10	152/155
	11	159/155
	12	156/157
	13	163/148
501	1	109/113
	2	115/112
	3	112/109
	4	110/111
	5	115/113
502	1	498/485
	2	435/479
	3	691/685
	4	640/626
	5	394/379
	6	31/28
	7	232/326
	8	374 (Floor Drain)
	9	365/360
	10	180/186
	11	393/398
	12	393 - Average of 4 Sinks
503	1	45/45
	2	44/47
	3	46/45
	4	48/53
	5	55/52
504	1	73/61
	2	101/178
	3	56/68
	4	59/54
	5	58/57
	6	65 (Sink)
	7	58/61
	8	60 (Washer)
	9	65 (Dryer)
	10	70/61
	11	61 - Average of 3 Sinks

TABLE 5
LAFAYETTE HIGH SCHOOL MERCURY RELEASE
TABLE OF MERCURY VAPOR SCREENING READINGS
CLASSROOMS OF THE 500 WING

506	1	57/55
	2	56/58
	3	59/161
507	1	87/85
	2	84/91
	3	89/88
	4	86/91
	5	90/91
508	1	3/9
	2	6/9
	3	14 - Average 3 Sinks
500 Wing Storage Room	1	90/97
500 Wing Resource Room	1	39/18
509	1	5,800 (Sink)
	2	137/111 (Floor Drain)
	3	37 (Kitchen Sink)
	4	52 (Washer)
	5	41 (Dryer)
	6	45/42
	7	42/72
	8	74/73
	9	69/72
	10	57/60
	11	62/62

Notes:

ng/m³ = nanograms per cubic meter
##/## = Breathing Zone/Floor

TABLE 6
LAFAYETTE HIGH SCHOOL MERCURY RELEASE
TABLE OF MERCURY VAPOR SCREENING READINGS
CLASSROOMS OF THE 600 WING

Room #	Section	Reading (ng/m ³)
600	1	103/113 (Bathroom)
	2	138 (Sink - Bathroom)
	3	159 (Sink - Outside Bathroom)
	4	156/157
	5	163/160
	6	170/154
	7	180/176
	8	170/161
601	1	64/64
	2	65/65
	3	63/64
	4	64/61
	5	63/66
	6	51/57
	7	62/60
	8	60/60
	9	59/64
	10	66/59
	11	66/58
	12	58/58
	13	58/62
	14	64 (Sink)
	15	35/33
	16	42/39
602	1	106/167
	2	96/104
	3	100/103
	4	100/127
	5	97/104
603	1	71/70
	2	70 (Sink)
	3	106/109
	4	108/108
	5	108/111
	6	74/80
	7	111/115
606	1	84/85
	2	104/111 (Storage Closet)
	3	79/79
	4	80/92
	5	96/86
	6	92/88
	7	92 (Sink - Teachers Desk)

TABLE 6
LAFAYETTE HIGH SCHOOL MERCURY RELEASE
TABLE OF MERCURY VAPOR SCREENING READINGS
CLASSROOMS OF THE 600 WING

608	1	72/73
	2	73/74
	3	74/77
	4	77/74
	5	76/79
	6	82 (Desk Sink)
610	1	69/2,600 (Floor Drain)
	2	79 (Table Station Sink)
	3	78/77
	4	72 (Sink - Teachers Desk)
	5	813 (Table Station Sink)
	6	77/77
	7	80 (Sink)
	8	74 (Sink)
	9	74/83
611	1	84/118
	2	82/85
	3	79/86
	4	89/92
	5	93 (Sink - Teachers Desk)
	6	92/103
615	1	56/63
	2	56 (Sink)
	3	58 (Teachers Sink)
	4	60 (Sink)
	5	59 (Sink)
	6	58 (Sink)
	7	58 (Sink)
	8	58 (Sink)
	9	211 (Sink)
	10	61/107
	11	59/59
	12	55/85
	13	58/102

Notes:

ng/m³ = nanograms per cubic meter

###/### = Breathing Zone/Floor

TABLE 7
LAFAYETTE HIGH SCHOOL MERCURY RELEASE
TABLE OF MERCURY VAPOR SCREENING READINGS
CLASSROOMS OF THE 700 WING

Room #	Section	Reading (ng/m ³)
700	1	145/145
	2	144/142
	3	147/144
	4	153/149
	5	149/147
701	1	74/70
	2	68/69
	3	69/67
	4	69/72
	5	72/73
	6	16 (Sink)
	7	222 (Floor Drain)
	8	14/13
	9	13/13
	10	17-Nov
	11	19/13
	12	13/14
	13	58/61
	14	56/41
702	1	97/101 (Bathroom)
	2	109 (Sink Inside Bathroom)
	3	96 (Sink Outside Bathroom)
	4	97/97
	5	98/104
	6	94/94
	7	92/100
	8	95/103
703	1	57/60
	2	60/63
	3	79/67
	4	69/78
	5	77/72
704	1	111/115
	2	110/150
	3	107/109
	4	105/128
	5	118/166

TABLE 7
LAFAYETTE HIGH SCHOOL MERCURY RELEASE
TABLE OF MERCURY VAPOR SCREENING READINGS
CLASSROOMS OF THE 700 WING

705	1	68 (Sink)
	2	71/71
	3	65/79
	4	78/71
	5	72/70
	6	70/67
	7	74/74
706	1	78/78
	2	76/79
	3	77/77
	4	76/76
	5	92/92
611	1	84/118
	2	82/85
	3	79/86
	4	89/92
	5	93 (Sink - Teachers Desk)
	6	92/103
700 Wing Book Storage Room	1	44/48
	2	52/63
711	1	46/55
	2	54/48
	3	47/34
	4	39/35
	5	40/39

Notes:

ng/m³ = nanograms per cubic meter

##/## = Breathing Zone/Floor

TABLE 8
LAFAYETTE HIGH SCHOOL MERCURY RELEASE
TABLE OF MERCURY VAPOR SCREENING READINGS
LUNCH ROOM

Room #	Section	Reading (ng/m ³)
Lunch Room	1	162
	2	186
	3	165
	4	161
	5	156
	6	154
	7	153
	8	147
	9	150
	10	155
	11	148
	12	140
	13	149
	14	153
	15	152
	16	126

Notes:

ng/m³ = nanograms per cubic meter

= Floor

TABLE 9
LAFAYETTE HIGH SCHOOL MERCURY RESPONSE
TABLE OF WITNESSES

Name	Title	Address	Office Number	Cell Number
Karen Buerki	USEPA FOSC	61 Forsyth St SW Atlanta, GA 30303	404-562-8747	
Matthew Huyser	USEPA FOSC	61 Forsyth St SW Atlanta, GA 30303	404-562-8934	
Ryan Stubbs	OTIE (START contractors)	1220 Kennestone Circle, Marietta, GA 30066	678-355-5550	678-255-5544
Nairimer Berrios- Cartagena	OTIE (START contractors)	1220 Kennestone Circle, Marietta, GA 30066	678-355-5550	678-468-0160
Jerome Partap	OTIE (START contractors)	1220 Kennestone Circle, Marietta, GA 30066	678-355-5550	
Wayne Robinson	Walker County Schools Coordinator of Technology, Information Services and Science Education	409 Pond Springs Road, Chickamauga, GA 30707	706-375-8001	
Melissa W. Maths	Walker County Schools Superintendent	P.O. Box 291 South Duke Street, LaFayette, GA 30728	706-638-7949	
Chris Jones	Walker County Schools Coordinator of Administrative Services	298 Culberson Avenue, LaFayette, GA 30728	706-639-0168	423-827-7410
Heather Holloway	LaFayette High School Assostant Principal Career Technical Supervisor	100 Rambler Drive, LaFayette, GA 30728	706-639-3412	423-413-6691
Glen Brown	LaFayette High School Assistant Principal	100 Rambler Drive, LaFayette, GA 30728	706-639-3415	423-827-6229
Steven M. Mersch	CleanHarbors Environmental Services Director of Site Services	3300 Cummings Road, Chattanooga, TN 37419	423-825-4126	423-593-9307

ATTACHMENT C
PHOTOGRAPHIC LOG



Official Photograph No. 1

Site Name:	LaFayette High School Mercury Release	Date: November 13, 2010
Location:	LaFayette, Walker County, GA	TDD No: TNA-05-001-0120
Photographer:	Ryan Stubbs, START	
Subject:	Main entrance of the High School.	



Official Photograph No. 2

Site Name:	LaFayette High School Mercury Release	Date: November 13, 2010
Location:	LaFayette, Walker County, GA	TDD No: TNA-05-001-0120
Photographer:	Nairimer Berrios-Cartagena, START	
Subject:	Boy's bathroom located in the 700 Wing of the high school.	



Official Photograph No. 3

Site Name:	LaFayette High School Mercury Release	Date: November 13, 2010
Location:	LaFayette, Walker County, GA	TDD No: TNA-05-001-0120
Photographer:	Nairimer Berrios-Cartagena, START	
Subject:	Boys bathroom located in the 700 Wing of the high school.	



Official Photograph No. 4

Site Name:	LaFayette High School Mercury Release	Date: November 13, 2010
Location:	LaFayette, Walker County, GA	TDD No: TNA-05-001-0120
Photographer:	Nairimer Berrios-Cartagena, START	
Subject:	Boy's bathroom located in the 700 Wing of the high school.	



Official Photograph No. 5

Site Name:	LaFayette High School Mercury Release	Date: November 13, 2010
Location:	LaFayette, Walker County, GA	TDD No: TNA-05-001-0120
Photographer:	Nairimer Berrios-Cartagena, START	
Subject:	Janitor's closet located in the 700 Wing of the school.	



Official Photograph No. 6

Site Name:	LaFayette High School Mercury Release	Date: November 13, 2010
Location:	LaFayette, Walker County, GA	TDD No: TNA-05-001-0120
Photographer:	Nairimer Berrios-Cartagena, START	
Subject:	Janitor's closet located in the 700 Wing of the school.	



Official Photograph No. 7

Site Name:	LaFayette High School Mercury Release	Date: November 13, 2010
Location:	LaFayette, Walker County, GA	TDD No: TNA-05-001-0120
Photographer:	Ryan Stubbs, START	
Subject:	Classroom No.707; part of the rooms first screened as requested by the school administration.	



Official Photograph No. 8

Site Name:	LaFayette High School Mercury Release	Date: November 13, 2010
Location:	LaFayette, Walker County, GA	TDD No: TNA-05-001-0120
Photographer:	Ryan Stubbs, START	
Subject:	Classroom No.707; part of the rooms first screened as requested by the school administration.	



Official Photograph No. 9

Site Name:	LaFayette High School Mercury Release	Date: November 13, 2010
Location:	LaFayette, Walker County, GA	TDD No: TNA-05-001-0120
Photographer:	Nairimer Berrios-Cartagena, START	
Subject:	Classroom No.708; part of the rooms first screened as requested by the school administration.	



Official Photograph No. 10

Site Name:	LaFayette High School Mercury Release	Date: November 13, 2010
Location:	LaFayette, Walker County, GA	TDD No: TNA-05-001-0120
Photographer:	Nairimer Berrios-Cartagena, START	
Subject:	Classroom No.708; part of the rooms first screened as requested by the school administration.	



Official Photograph No. 11

Site Name:	LaFayette High School Mercury Release	Date: November 13, 2010
Location:	LaFayette, Walker County, GA	TDD No: TNA-05-001-0120
Photographer:	Ryan Stubbs, START	
Subject:	Classroom No.709; part of the rooms first screened as requested by the school administration.	



Official Photograph No. 12

Site Name:	LaFayette High School Mercury Release	Date: November 13, 2010
Location:	LaFayette, Walker County, GA	TDD No: TNA-05-001-0120
Photographer:	Ryan Stubbs, START	
Subject:	Classroom No.709; part of the rooms first screened as requested by the school administration.	



Official Photograph No. 13

Site Name: LaFayette High School Mercury Release **Date:** November 13, 2010
Location: LaFayette, Walker County, GA **TDD No:** TNA-05-001-0120
Photographer: Ryan Stubbs, START
Subject: Classroom No.710; part of the rooms first screened as requested by the school administration.



Official Photograph No. 14

Site Name: LaFayette High School Mercury Release **Date:** November 13, 2010
Location: LaFayette, Walker County, GA **TDD No:** TNA-05-001-0120
Photographer: Ryan Stubbs, START
Subject: Classroom No.710; part of the rooms first screened as requested by the school administration.



Official Photograph No. 15

Site Name: LaFayette High School Mercury Release **Date:** November 13, 2010
Location: LaFayette, Walker County, GA **TDD No:** TNA-05-001-0120
Photographer: Nairimer Berrios-Cartagena, START
Subject: Classroom No.713; part of the rooms first screened as requested by the school administration.

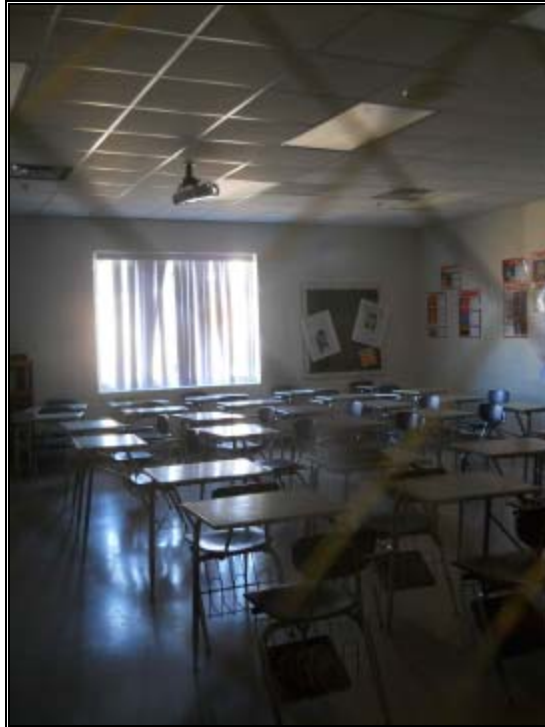

Official Photograph No. 16

Site Name: LaFayette High School Mercury Release **Date:** November 13, 2010
Location: LaFayette, Walker County, GA **TDD No:** TNA-05-001-0120
Photographer: Nairimer Berrios-Cartagena, START
Subject: Classroom No.713; part of the rooms first screened as requested by the school administration.



Official Photograph No. 17

Site Name:	LaFayette High School Mercury Release	Date: November 13, 2010
Location:	LaFayette, Walker County, GA	TDD No: TNA-05-001-0120
Photographer:	Ryan Stubbs, START	
Subject:	Classroom No.604 (Science Classroom); part of the rooms first screened as requested by the school administration.	



Official Photograph No. 18

Site Name:	LaFayette High School Mercury Release	Date: November 13, 2010
Location:	LaFayette, Walker County, GA	TDD No: TNA-05-001-0120
Photographer:	Ryan Stubbs, START	
Subject:	Classroom No.604 (Science Classroom); part of the rooms first screened as requested by the school administration.	



Official Photograph No. 19

Site Name:	LaFayette High School Mercury Release	Date: November 13, 2010
Location:	LaFayette, Walker County, GA	TDD No: TNA-05-001-0120
Photographer:	Ryan Stubbs, START	
Subject:	Classroom No.604 (Science Classroom's chemical storage closet); part of the rooms first screened as requested by the school administration.	



Official Photograph No. 20

Site Name:	LaFayette High School Mercury Release	Date: November 13, 2010
Location:	LaFayette, Walker County, GA	TDD No: TNA-05-001-0120
Photographer:	Ryan Stubbs, START	
Subject:	Classroom No.605, part of the 600 Wing.	



Official Photograph No. 21

Site Name:	LaFayette High School Mercury Release	Date:	November 13, 2010
Location:	LaFayette, Walker County, GA	TDD No:	TNA-05-001-0120
Photographer:	Ryan Stubbs, START		
Subject:	Classroom No.605, part of the 600 Wing.		



Official Photograph No. 22

Site Name:	LaFayette High School Mercury Release	Date:	November 13, 2010
Location:	LaFayette, Walker County, GA	TDD No:	TNA-05-001-0120
Photographer:	Ryan Stubbs, START		
Subject:	Classroom No.607, part of the 600 Wing.		



Official Photograph No. 23

Site Name:	LaFayette High School Mercury Release	Date: November 13, 2010
Location:	LaFayette, Walker County, GA	TDD No: TNA-05-001-0120
Photographer:	Ryan Stubbs, START	
Subject:	Classroom No.607, part of the 600 Wing.	



Official Photograph No. 24

Site Name:	LaFayette High School Mercury Release	Date: November 13, 2010
Location:	LaFayette, Walker County, GA	TDD No: TNA-05-001-0120
Photographer:	Ryan Stubbs, START	
Subject:	Classroom No.502, part of the 500 Wing.	



Official Photograph No. 25

Site Name:	LaFayette High School Mercury Release	Date: November 13, 2010
Location:	LaFayette, Walker County, GA	TDD No: TNA-05-001-0120
Photographer:	Ryan Stubbs, START	
Subject:	Classroom No.502, part of the 500 Wing.	



Official Photograph No. 26

Site Name:	LaFayette High School Mercury Release	Date: November 13, 2010
Location:	LaFayette, Walker County, GA	TDD No: TNA-05-001-0120
Photographer:	Ryan Stubbs, START	
Subject:	Classroom No.505, part of the 500 Wing.	



Official Photograph No. 27

Site Name: LaFayette High School Mercury Release
Location: LaFayette, Walker County, GA
Photographer: Ryan Stubbs, START
Subject: Classroom No.505, part of the 500 Wing.

Date: November 13, 2010
TDD No: TNA-05-001-0120



Official Photograph No. 28

Site Name: LaFayette High School Mercury Release
Location: LaFayette, Walker County, GA
Photographer: Ryan Stubbs, START
Subject: Classroom No.400, part of the 400 Wing.

Date: November 13, 2010
TDD No: TNA-05-001-0120



Official Photograph No. 29

Site Name:	LaFayette High School Mercury Release	Date: November 13, 2010
Location:	LaFayette, Walker County, GA	TDD No: TNA-05-001-0120
Photographer:	Ryan Stubbs, START	
Subject:	Classroom No.400, part of the 400 Wing.	



Official Photograph No. 30

Site Name:	LaFayette High School Mercury Release	Date: November 13, 2010
Location:	LaFayette, Walker County, GA	TDD No: TNA-05-001-0120
Photographer:	Nairimer Berríos-Cartagena, START	
Subject:	Bagged items after the school administration conducted clean-up procedures.	



Official Photograph No. 31

Site Name:	LaFayette High School Mercury Release	Date: November 13, 2010
Location:	LaFayette, Walker County, GA	TDD No: TNA-05-001-0120
Photographer:	Nairimer Berrios-Cartagena, START	
Subject:	Bagged items after the school administration conducted clean-up procedures.	



Official Photograph No. 32

Site Name:	LaFayette High School Mercury Release	Date: November 13, 2010
Location:	LaFayette, Walker County, GA	TDD No: TNA-05-001-0120
Photographer:	Nairimer Berrios-Cartagena, START	
Subject:	Bagged items after the school administration conducted clean-up procedures.	



Official Photograph No. 33

Site Name:	LaFayette High School Mercury Release	Date: November 13, 2010
Location:	LaFayette, Walker County, GA	TDD No: TNA-05-001-0120
Photographer:	Nairimer Berrios-Cartagena, START	
Subject:	Bagged items after the school administration conducted clean-up procedures.	



Official Photograph No. 34

Site Name:	LaFayette High School Mercury Release	Date: November 13, 2010
Location:	LaFayette, Walker County, GA	TDD No: TNA-05-001-0120
Photographer:	Nairimer Berrios-Cartagena, START	
Subject:	Bagged items after the school administration conducted clean-up procedures; ready for proper disposal.	



Official Photograph No. 35

Site Name:	LaFayette High School Mercury Release	Date: November 13, 2010
Location:	LaFayette, Walker County, GA	TDD No: TNA-05-001-0120
Photographer:	Nairimer Berrios-Cartagena, START	
Subject:	Gymnasium.	



Official Photograph No. 36

Site Name:	LaFayette High School Mercury Release	Date: November 13, 2010
Location:	LaFayette, Walker County, GA	TDD No: TNA-05-001-0120
Photographer:	Nairimer Berrios-Cartagena, START	
Subject:	Mobile Unit No.2, where mercury vapors readings were confirmed up to >100 $\mu\text{g}/\text{m}^3$.	



Official Photograph No. 37

Site Name: LaFayette High School Mercury Release **Date:** November 13, 2010
Location: LaFayette, Walker County, GA **TDD No:** TNA-05-001-0120
Photographer: Nairimer Berrios-Cartagena, START
Subject: Mobile Unit No.2, where mercury vapors readings were confirmed up to >100 $\mu\text{g}/\text{m}^3$.

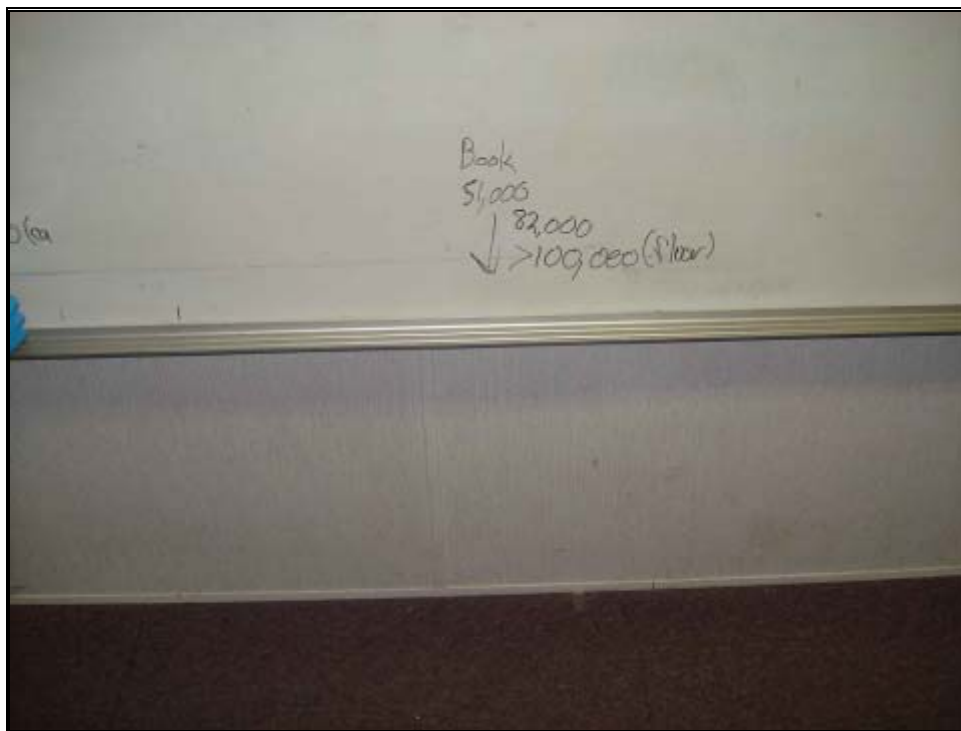

Official Photograph No. 38

Site Name: LaFayette High School Mercury Release **Date:** November 13, 2010
Location: LaFayette, Walker County, GA **TDD No:** TNA-05-001-0120
Photographer: Nairimer Berrios-Cartagena, START
Subject: Mobile Unit No.2, where mercury vapors readings were confirmed up to >100 $\mu\text{g}/\text{m}^3$.



Official Photograph No. 39

Site Name: LaFayette High School Mercury Release **Date:** November 13, 2010
Location: LaFayette, Walker County, GA **TDD No:** TNA-05-001-0120
Photographer: Nairimer Berrios-Cartagena, START
Subject: Mobile Unit No.2, where mercury vapors readings were confirmed up to 22 $\mu\text{g}/\text{m}^3$.



Official Photograph No. 40

Site Name: LaFayette High School Mercury Release **Date:** November 14, 2010
Location: LaFayette, Walker County, GA **TDD No:** TNA-05-001-0120
Photographer: Ryan Stubbs, START
Subject: Lockers located in the hallway between 600 and 700 wing.



Official Photograph No. 41

Site Name: LaFayette High School Mercury Release
Location: LaFayette, Walker County, GA
Photographer: Ryan Stubbs, START
Subject: Classroom No.607, part of the 600 Wing.

Date: November 14, 2010
TDD No: TNA-05-001-0120



Official Photograph No. 42

Site Name: LaFayette High School Mercury Release
Location: LaFayette, Walker County, GA
Photographer: Ryan Stubbs, START
Subject: Classroom No.607, part of the 600 Wing.

Date: November 14, 2010
TDD No: TNA-05-001-0120



Official Photograph No. 43

Site Name: LaFayette High School Mercury Release
Location: LaFayette, Walker County, GA
Photographer: Ryan Stubbs, START
Subject: Classroom No.609, part of the 600 Wing.

Date: November 14, 2010
TDD No: TNA-05-001-0120



Official Photograph No. 44

Site Name: LaFayette High School Mercury Release
Location: LaFayette, Walker County, GA
Photographer: Ryan Stubbs, START
Subject: Classroom No.609, part of the 600 Wing.

Date: November 14, 2010
TDD No: TNA-05-001-0120



Official Photograph No. 45

Site Name:	LaFayette High School Mercury Release	Date: November 14, 2010
Location:	LaFayette, Walker County, GA	TDD No: TNA-05-001-0120
Photographer:	Ryan Stubbs, START	
Subject:	Classroom No.611, part of the 600 Wing.	



Official Photograph No. 46

Site Name:	LaFayette High School Mercury Release	Date: November 14, 2010
Location:	LaFayette, Walker County, GA	TDD No: TNA-05-001-0120
Photographer:	Ryan Stubbs, START	
Subject:	Classroom No.611, part of the 600 Wing.	



Official Photograph No. 47

Site Name: LaFayette High School Mercury Release
Location: LaFayette, Walker County, GA
Photographer: Ryan Stubbs, START
Subject: Classroom No.606, part of the 600 Wing.

Date: November 14, 2010
TDD No: TNA-05-001-0120



Official Photograph No. 48

Site Name: LaFayette High School Mercury Release
Location: LaFayette, Walker County, GA
Photographer: Ryan Stubbs, START
Subject: Classroom No.611, part of the 600 Wing.

Date: November 14, 2010
TDD No: TNA-05-001-0120



Official Photograph No. 49

Site Name: LaFayette High School Mercury Release
Location: LaFayette, Walker County, GA
Photographer: Ryan Stubbs, START
Subject: Classroom No.602, part of the 600 Wing.

Date: November 14, 2010
TDD No: TNA-05-001-0120



Official Photograph No. 50

Site Name: LaFayette High School Mercury Release
Location: LaFayette, Walker County, GA
Photographer: Ryan Stubbs, START
Subject: Classroom No.602, part of the 600 Wing.

Date: November 14, 2010
TDD No: TNA-05-001-0120



Official Photograph No. 51

Site Name:	LaFayette High School Mercury Release	Date: November 14, 2010
Location:	LaFayette, Walker County, GA	TDD No: TNA-05-001-0120
Photographer:	Ryan Stubbs, START	
Subject:	Classroom No.600, part of the 600 Wing.	



Official Photograph No. 52

Site Name:	LaFayette High School Mercury Release	Date: November 14, 2010
Location:	LaFayette, Walker County, GA	TDD No: TNA-05-001-0120
Photographer:	Ryan Stubbs, START	
Subject:	Classroom No.600, part of the 600 Wing.	



Official Photograph No. 53

Site Name:	LaFayette High School Mercury Release	Date: November 14, 2010
Location:	LaFayette, Walker County, GA	TDD No: TNA-05-001-0120
Photographer:	Ryan Stubbs, START	
Subject:	Classroom No.603, part of the 600 Wing.	



Official Photograph No. 54

Site Name:	LaFayette High School Mercury Release	Date: November 14, 2010
Location:	LaFayette, Walker County, GA	TDD No: TNA-05-001-0120
Photographer:	Ryan Stubbs, START	
Subject:	Classroom No.603, part of the 600 Wing.	

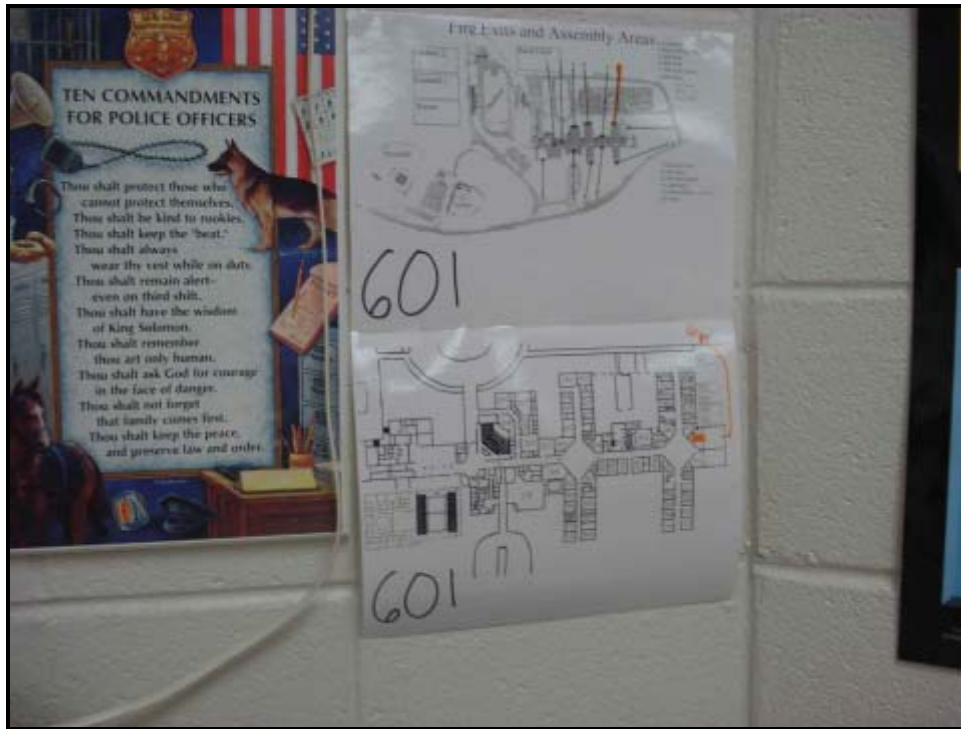

Official Photograph No. 55

Site Name:	LaFayette High School Mercury Release	Date: November 14, 2010
Location:	LaFayette, Walker County, GA	TDD No: TNA-05-001-0120
Photographer:	Ryan Stubbs, START	
Subject:	Classroom No.601, part of the 600 Wing.	



Official Photograph No. 56

Site Name:	LaFayette High School Mercury Release	Date: November 14, 2010
Location:	LaFayette, Walker County, GA	TDD No: TNA-05-001-0120
Photographer:	Ryan Stubbs, START	
Subject:	Classroom No.601, part of the 600 Wing.	



Official Photograph No. 57

Site Name:	LaFayette High School Mercury Release	Date: November 14, 2010
Location:	LaFayette, Walker County, GA	TDD No: TNA-05-001-0120
Photographer:	Ryan Stubbs, START	
Subject:	Classroom No.701, part of the 700 Wing.	



Official Photograph No. 58

Site Name:	LaFayette High School Mercury Release	Date: November 14, 2010
Location:	LaFayette, Walker County, GA	TDD No: TNA-05-001-0120
Photographer:	Ryan Stubbs, START	
Subject:	Classroom No.701, part of the 700 Wing.	

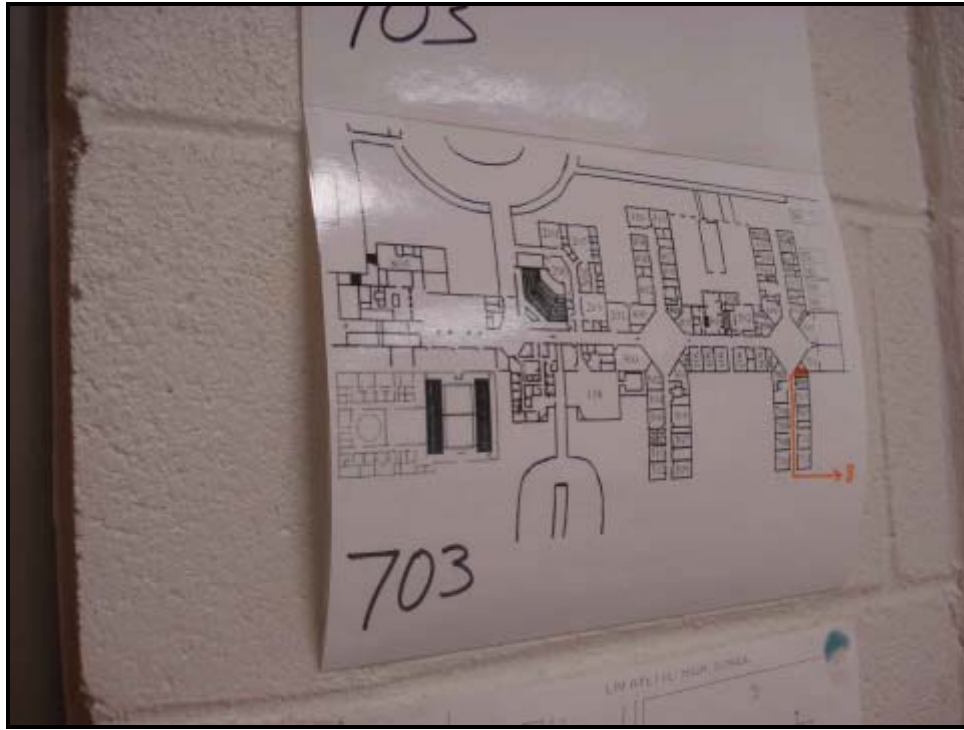

Official Photograph No. 59

Site Name:	LaFayette High School Mercury Release	Date: November 14, 2010
Location:	LaFayette, Walker County, GA	TDD No: TNA-05-001-0120
Photographer:	Ryan Stubbs, START	
Subject:	Classroom No.703, part of the 700 Wing.	



Official Photograph No. 60

Site Name:	LaFayette High School Mercury Release	Date: November 14, 2010
Location:	LaFayette, Walker County, GA	TDD No: TNA-05-001-0120
Photographer:	Ryan Stubbs, START	
Subject:	Classroom No.703, part of the 700 Wing.	



Official Photograph No. 61

Site Name:	LaFayette High School Mercury Release	Date: November 14, 2010
Location:	LaFayette, Walker County, GA	TDD No: TNA-05-001-0120
Photographer:	Ryan Stubbs, START	
Subject:	Classroom No.702, part of the 700 Wing.	



Official Photograph No. 62

Site Name:	LaFayette High School Mercury Release	Date: November 14, 2010
Location:	LaFayette, Walker County, GA	TDD No: TNA-05-001-0120
Photographer:	Ryan Stubbs, START	
Subject:	Classroom No.702, part of the 700 Wing.	



Official Photograph No. 63

Site Name:	LaFayette High School Mercury Release	Date: November 14, 2010
Location:	LaFayette, Walker County, GA	TDD No: TNA-05-001-0120
Photographer:	Ryan Stubbs, START	
Subject:	Classroom No.705, part of the 700 Wing.	



Official Photograph No. 64

Site Name:	LaFayette High School Mercury Release	Date: November 14, 2010
Location:	LaFayette, Walker County, GA	TDD No: TNA-05-001-0120
Photographer:	Ryan Stubbs, START	
Subject:	Classroom No.705, part of the 700 Wing.	



Official Photograph No. 65

Site Name:	LaFayette High School Mercury Release	Date: November 14, 2010
Location:	LaFayette, Walker County, GA	TDD No: TNA-05-001-0120
Photographer:	Ryan Stubbs, START	
Subject:	Classroom No.704, part of the 700 Wing.	



Official Photograph No. 66

Site Name:	LaFayette High School Mercury Release	Date: November 14, 2010
Location:	LaFayette, Walker County, GA	TDD No: TNA-05-001-0120
Photographer:	Ryan Stubbs, START	
Subject:	Classroom No.704, part of the 700 Wing.	



Official Photograph No. 67

Site Name: LaFayette High School Mercury Release
Location: LaFayette, Walker County, GA
Photographer: Ryan Stubbs, START
Subject: Classroom No.706, part of the 700 Wing.

Date: November 14, 2010
TDD No: TNA-05-001-0120



Official Photograph No. 68

Site Name: LaFayette High School Mercury Release
Location: LaFayette, Walker County, GA
Photographer: Ryan Stubbs, START
Subject: Classroom No.706, part of the 700 Wing.

Date: November 14, 2010
TDD No: TNA-05-001-0120



Official Photograph No. 69

Site Name:	LaFayette High School Mercury Release	Date: November 14, 2010
Location:	LaFayette, Walker County, GA	TDD No: TNA-05-001-0120
Photographer:	Ryan Stubbs, START	
Subject:	Classroom No.711, part of the 700 Wing.	

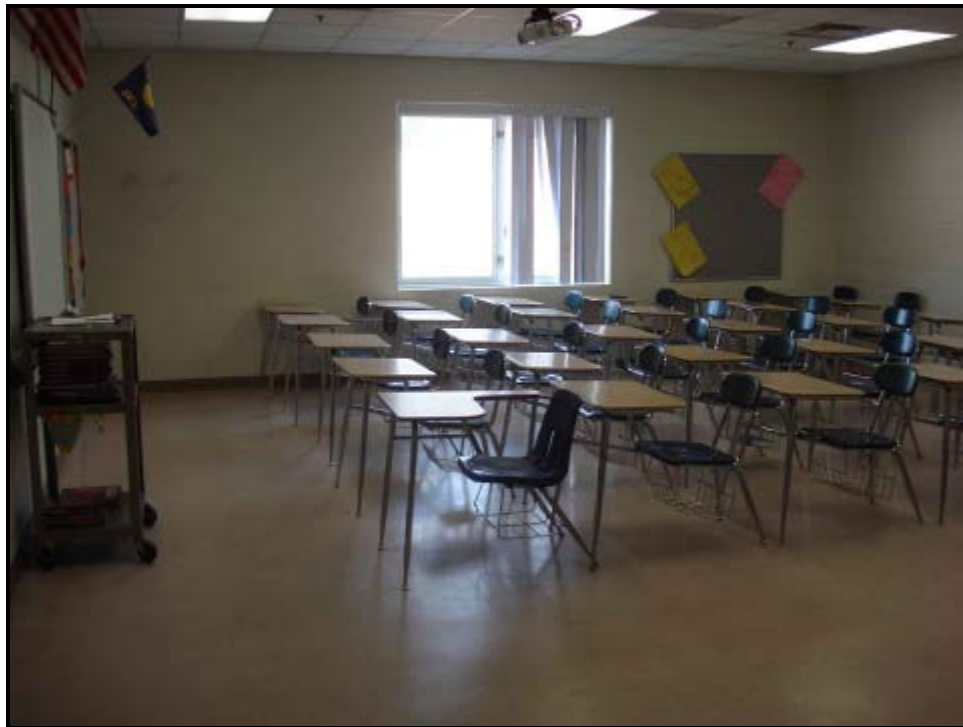

Official Photograph No. 70

Site Name:	LaFayette High School Mercury Release	Date: November 14, 2010
Location:	LaFayette, Walker County, GA	TDD No: TNA-05-001-0120
Photographer:	Ryan Stubbs, START	
Subject:	Classroom No.711, part of the 700 Wing.	



Official Photograph No. 71

Site Name:	LaFayette High School Mercury Release	Date: November 14, 2010
Location:	LaFayette, Walker County, GA	TDD No: TNA-05-001-0120
Photographer:	Ryan Stubbs, START	
Subject:	Classroom No.700, part of the 700 Wing.	



Official Photograph No. 72

Site Name:	LaFayette High School Mercury Release	Date: November 14, 2010
Location:	LaFayette, Walker County, GA	TDD No: TNA-05-001-0120
Photographer:	Ryan Stubbs, START	
Subject:	Classroom No.700, part of the 700 Wing.	



Official Photograph No. 73

Site Name:	LaFayette High School Mercury Release	Date: November 14, 2010
Location:	LaFayette, Walker County, GA	TDD No: TNA-05-001-0120
Photographer:	Ryan Stubbs, START	
Subject:	Classroom No.509, part of the 500 Hallway.	



Official Photograph No. 74

Site Name:	LaFayette High School Mercury Release	Date: November 14, 2010
Location:	LaFayette, Walker County, GA	TDD No: TNA-05-001-0120
Photographer:	Ryan Stubbs, START	
Subject:	Classroom No.509, part of the 500 Hallway.	



Official Photograph No. 75

Site Name:	LaFayette High School Mercury Release	Date: November 14, 2010
Location:	LaFayette, Walker County, GA	TDD No: TNA-05-001-0120
Photographer:	Ryan Stubbs, START	
Subject:	Classroom No.507, part of the 500 Hallway.	



Official Photograph No. 76

Site Name:	LaFayette High School Mercury Release	Date: November 14, 2010
Location:	LaFayette, Walker County, GA	TDD No: TNA-05-001-0120
Photographer:	Ryan Stubbs, START	
Subject:	Classroom No.507, part of the 500 Hallway.	



Official Photograph No. 77

Site Name:	LaFayette High School Mercury Release	Date: November 14, 2010
Location:	LaFayette, Walker County, GA	TDD No: TNA-05-001-0120
Photographer:	Ryan Stubbs, START	
Subject:	Classroom No.503, part of the 500 Hallway.	



Official Photograph No. 78

Site Name:	LaFayette High School Mercury Release	Date: November 14, 2010
Location:	LaFayette, Walker County, GA	TDD No: TNA-05-001-0120
Photographer:	Ryan Stubbs, START	
Subject:	Classroom No.503, part of the 500 Hallway.	



Official Photograph No. 79

Site Name:	LaFayette High School Mercury Release	Date: November 14, 2010
Location:	LaFayette, Walker County, GA	TDD No: TNA-05-001-0120
Photographer:	Ryan Stubbs, START	
Subject:	Classroom No.501, part of the 500 Hallway.	



Official Photograph No. 80

Site Name:	LaFayette High School Mercury Release	Date: November 14, 2010
Location:	LaFayette, Walker County, GA	TDD No: TNA-05-001-0120
Photographer:	Ryan Stubbs, START	
Subject:	Classroom No.501, part of the 500 Hallway.	



Official Photograph No. 81

Site Name:	LaFayette High School Mercury Release	Date: November 14, 2010
Location:	LaFayette, Walker County, GA	TDD No: TNA-05-001-0120
Photographer:	Ryan Stubbs, START	
Subject:	Classroom No.500, part of the 500 Hallway.	



Official Photograph No. 82

Site Name:	LaFayette High School Mercury Release	Date: November 14, 2010
Location:	LaFayette, Walker County, GA	TDD No: TNA-05-001-0120
Photographer:	Ryan Stubbs, START	
Subject:	Classroom No.500, part of the 500 Hallway.	



Official Photograph No. 83

Site Name: LaFayette High School Mercury Release **Date:** November 14, 2010
Location: LaFayette, Walker County, GA **TDD No:** TNA-05-001-0120
Photographer: Ryan Stubbs, START
Subject: Classroom No.502, part of the 500 Hallway.



Official Photograph No. 84

Site Name: LaFayette High School Mercury Release **Date:** November 14, 2010
Location: LaFayette, Walker County, GA **TDD No:** TNA-05-001-0120
Photographer: Ryan Stubbs, START
Subject: Classroom No.502, part of the 500 Hallway.



Official Photograph No. 85

Site Name:	LaFayette High School Mercury Release	Date: November 14, 2010
Location:	LaFayette, Walker County, GA	TDD No: TNA-05-001-0120
Photographer:	Ryan Stubbs, START	
Subject:	Auditorium	



Official Photograph No. 86

Site Name:	LaFayette High School Mercury Release	Date: November 14, 2010
Location:	LaFayette, Walker County, GA	TDD No: TNA-05-001-0120
Photographer:	Ryan Stubbs, START	
Subject:	Classroom No.403, part of the 400 Wing.	



Official Photograph No. 87

Site Name:	LaFayette High School Mercury Release	Date: November 14, 2010
Location:	LaFayette, Walker County, GA	TDD No: TNA-05-001-0120
Photographer:	Ryan Stubbs, START	
Subject:	Classroom No.403, part of the 400 Wing.	



Official Photograph No. 88

Site Name:	LaFayette High School Mercury Release	Date: November 14, 2010
Location:	LaFayette, Walker County, GA	TDD No: TNA-05-001-0120
Photographer:	Ryan Stubbs, START	
Subject:	Classroom No.401, part of the 400 Wing.	

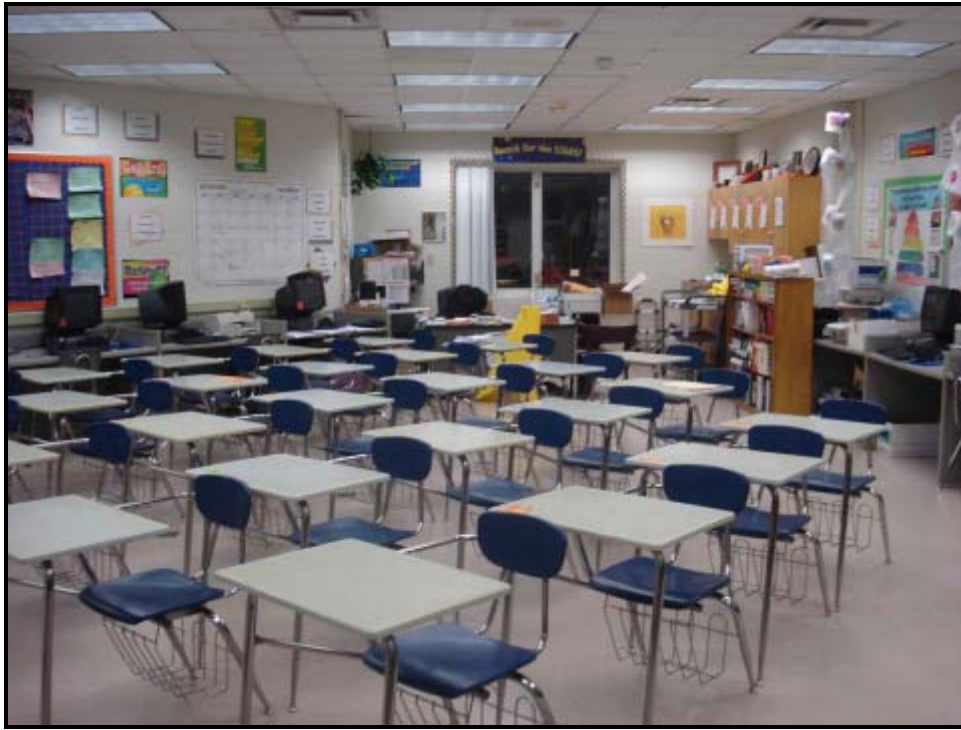

Official Photograph No. 89

Site Name:	LaFayette High School Mercury Release	Date: November 14, 2010
Location:	LaFayette, Walker County, GA	TDD No: TNA-05-001-0120
Photographer:	Ryan Stubbs, START	
Subject:	Classroom No.401, part of the 400 Wing.	



Official Photograph No. 90

Site Name:	LaFayette High School Mercury Release	Date: November 14, 2010
Location:	LaFayette, Walker County, GA	TDD No: TNA-05-001-0120
Photographer:	Ryan Stubbs, START	
Subject:	Girls bathroom, part of the 400 Wing.	



Official Photograph No. 91

Site Name:	LaFayette High School Mercury Release	Date: November 14, 2010
Location:	LaFayette, Walker County, GA	TDD No: TNA-05-001-0120
Photographer:	Ryan Stubbs, START	
Subject:	Girls bathroom, part of the 400 Wing.	



Official Photograph No. 92

Site Name:	LaFayette High School Mercury Release	Date: November 14, 2010
Location:	LaFayette, Walker County, GA	TDD No: TNA-05-001-0120
Photographer:	Ryan Stubbs, START	
Subject:	Classroom No.405, part of the 400 Wing.	



Official Photograph No. 93

Site Name:	LaFayette High School Mercury Release	Date: November 14, 2010
Location:	LaFayette, Walker County, GA	TDD No: TNA-05-001-0120
Photographer:	Ryan Stubbs, START	
Subject:	Classroom No.407, part of the 400 Wing.	



Official Photograph No. 94

Site Name:	LaFayette High School Mercury Release	Date: November 14, 2010
Location:	LaFayette, Walker County, GA	TDD No: TNA-05-001-0120
Photographer:	Ryan Stubbs, START	
Subject:	Classroom No.408, part of the 400 Wing.	



Official Photograph No. 95

Site Name:	LaFayette High School Mercury Release	Date: November 14, 2010
Location:	LaFayette, Walker County, GA	TDD No: TNA-05-001-0120
Photographer:	Ryan Stubbs, START	
Subject:	Classroom No.406, part of the 400 Wing.	

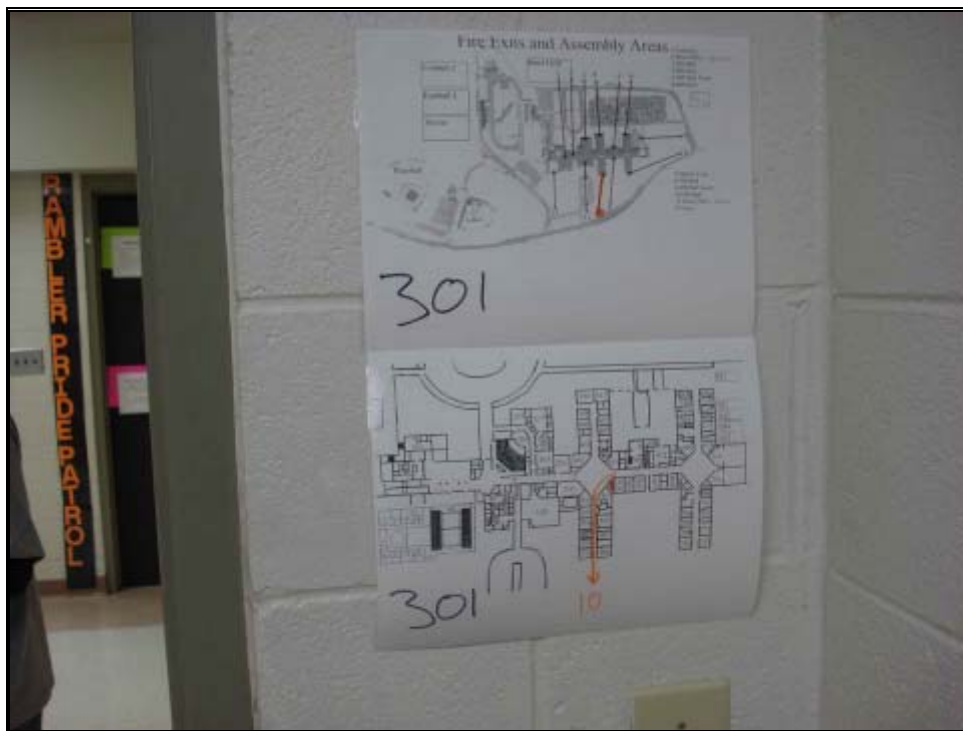

Official Photograph No. 96

Site Name:	LaFayette High School Mercury Release	Date: November 14, 2010
Location:	LaFayette, Walker County, GA	TDD No: TNA-05-001-0120
Photographer:	Ryan Stubbs, START	
Subject:	Classroom No.301, part of the 300 Wing.	



Official Photograph No. 97

Site Name: LaFayette High School Mercury Release
Location: LaFayette, Walker County, GA
Photographer: Ryan Stubbs, START
Subject: Classroom No.301, part of the 300 Wing.

Date: November 14, 2010
TDD No: TNA-05-001-0120



Official Photograph No. 98

Site Name: LaFayette High School Mercury Release
Location: LaFayette, Walker County, GA
Photographer: Ryan Stubbs, START
Subject: Janitor's closet at the administrative offices.

Date: November 14, 2010
TDD No: TNA-05-001-0120



Official Photograph No. 99

Site Name: LaFayette High School Mercury Release
Location: LaFayette, Walker County, GA
Photographer: Ryan Stubbs, START
Subject: Janitor's closet at the Cafeteria.

Date: November 14, 2010
TDD No: TNA-05-001-0120



Official Photograph No. 100

Site Name: LaFayette High School Mercury Release
Location: LaFayette, Walker County, GA
Photographer: Ryan Stubbs, START
Subject: Janitor's administrative and storage office.

Date: November 14, 2010
TDD No: TNA-05-001-0120



Official Photograph No. 101

Site Name:	LaFayette High School Mercury Release	Date: November 14, 2010
Location:	LaFayette, Walker County, GA	TDD No: TNA-05-001-0120
Photographer:	Ryan Stubbs, START	
Subject:	Janitor's administrative and storage office. Bathroom and laundry area.	



Official Photograph No. 102

Site Name:	LaFayette High School Mercury Release	Date: November 14, 2010
Location:	LaFayette, Walker County, GA	TDD No: TNA-05-001-0120
Photographer:	Ryan Stubbs, START	
Subject:	Janitor's administrative and storage office. Main storage area.	



Official Photograph No. 103

Site Name:	LaFayette High School Mercury Release	Date: November 14, 2010
Location:	LaFayette, Walker County, GA	TDD No: TNA-05-001-0120
Photographer:	Ryan Stubbs, START	
Subject:	Janitor's closet at the 600 Wing.	



Official Photograph No. 104

Site Name:	LaFayette High School Mercury Release	Date: November 14, 2010
Location:	LaFayette, Walker County, GA	TDD No: TNA-05-001-0120
Photographer:	Ryan Stubbs, START	
Subject:	Janitor's closet at the 400 Wing.	



Official Photograph No. 105

Site Name:	LaFayette High School Mercury Release	Date: November 14, 2010
Location:	LaFayette, Walker County, GA	TDD No: TNA-05-001-0120
Photographer:	Ryan Stubbs, START	
Subject:	Janitor's closet at the 300 Wing.	



Official Photograph No. 106

Site Name:	LaFayette High School Mercury Release	Date: November 14, 2010
Location:	LaFayette, Walker County, GA	TDD No: TNA-05-001-0120
Photographer:	Ryan Stubbs, START	
Subject:	Boy's lockers room behind the gymnasium.	



Official Photograph No. 107

Site Name:	LaFayette High School Mercury Release	Date: November 14, 2010
Location:	LaFayette, Walker County, GA	TDD No: TNA-05-001-0120
Photographer:	Ryan Stubbs, START	
Subject:	Boy's lockers room behind the gymnasium.	



Official Photograph No. 108

Site Name:	LaFayette High School Mercury Release	Date: November 14, 2010
Location:	LaFayette, Walker County, GA	TDD No: TNA-05-001-0120
Photographer:	Ryan Stubbs, START	
Subject:	Boy's lockers room shower area.	



Official Photograph No. 109

Site Name:	LaFayette High School Mercury Release	Date: November 14, 2010
Location:	LaFayette, Walker County, GA	TDD No: TNA-05-001-0120
Photographer:	Ryan Stubbs, START	
Subject:	Room No.905 at the Boy's lockers room area.	



Official Photograph No. 110

Site Name:	LaFayette High School Mercury Release	Date: November 14, 2010
Location:	LaFayette, Walker County, GA	TDD No: TNA-05-001-0120
Photographer:	Ryan Stubbs, START	
Subject:	Room No.907 at the Boy's lockers room area.	



Official Photograph No. 111

Site Name: LaFayette High School Mercury Release **Date:** November 15, 2010
Location: LaFayette, Walker County, GA **TDD No:** TNA-05-001-0120
Photographer: Ryan Stubbs, START
Subject: Room No.930: weight room between the boys and girls locker rooms.



Official Photograph No. 112

Site Name: LaFayette High School Mercury Release **Date:** November 15, 2010
Location: LaFayette, Walker County, GA **TDD No:** TNA-05-001-0120
Photographer: Ryan Stubbs, START
Subject: Room No.930: weight room between the boys and girls locker rooms.



Official Photograph No. 113

Site Name:	LaFayette High School Mercury Release	Date: November 15, 2010
Location:	LaFayette, Walker County, GA	TDD No: TNA-05-001-0120
Photographer:	Ryan Stubbs, START	
Subject:	Girls locker room behind the gymnasium.	



Official Photograph No. 114

Site Name:	LaFayette High School Mercury Release	Date: November 15, 2010
Location:	LaFayette, Walker County, GA	TDD No: TNA-05-001-0120
Photographer:	Ryan Stubbs, START	
Subject:	Girls lockers room behind the gymnasium.	



Official Photograph No. 115

Site Name:	LaFayette High School Mercury Release	Date: November 15, 2010
Location:	LaFayette, Walker County, GA	TDD No: TNA-05-001-0120
Photographer:	Ryan Stubbs, START	
Subject:	Girls lockers room shower area behind the gymnasium.	

ATTACHMENT D
LOGBOOK NOTES

LaFayette High School
Hg ER
TDD: TNA-05-001-0120



"Rite in the Rain"®

ALL-WEATHER

UNIVERSAL

No. 371

"Rite in the Rain"
ALL-WEATHER WRITING PAPER



Name _____

Address _____

Phone _____

Project LaFayette HS Hg Release
Ryan Stubbs - OTIE
Nairimer Berrios-Catagena - OTIE
Jerome Partap - OTIE
Matt Hoyer - EPA
Karen Buerki - EPA

Clear Vinyl Protective Slipcovers (Item No. 30) are available for this style of notebook.
 Helps protect your notebook from wear & tear. Contact your dealer or the J. L. Darling Corporation.

CONTENTS

PAGE	REFERENCE	DATE
228	Log notes for ERU	RS 11/13/2010
47+48	Business cards	RS 11/16/2010

11/13/2010 La Fayette Hg ER
 0600 START- Stubbs, Berrios and Partap at OTIE loading out. RS
 0650 START departing office. RS
 0820 START arrived at LaFayette High School in LaFayette, GA.
 weather: sunny & 41°F
 0845 Meet with OSC-Huyser and school administrators.
 On 10/21/2010, zinc used for initial clean up in the Room 707 English Room, Boy's Bathroom and patio in the 700 Hall.
~~604RS~~ Girls bathroom, 604 and 605, mobile #1, #3 & #5.
 Mobile #2 250,000 nanos
 - 9 McClemore
 - Hot spot 8,000 + 12,000
 - 1104B Chestnut
 - 1,000 - 1,200 nanos
 - 9474 Shinbone Valley
 - Cleared by OSC-Huyser
 - Comprehensive screen in Room 707 + Boy's Bathroom and Mobile #2

Scale: 1 square=

N. Stubbs

11/13/2010 La Fayette Hg ER

One student had blood tested and found 47 with no units listed.

0945 Meeting with school admin finished. START warmed up Lymexs and baseline tested them to begin screening. START Stubbs & Partap screened together and START Berrios was working solo. RS

1023 START Stubbs & Partap screening Room 707. Refer to diagram stapled to this page. Highest mercury vapor readings were found at floor level near the back wall and back corner of the room. Highest reading was 19,000 nanograms per cubic meter (ng/m³). RS

1058 Note from OSC-Huyser. The patio outside the lunchroom read up to 19,000 ng/m³.

N. Stubbs

Scale: 1 square=

4 11/13/2010 LaFayette HS ER

1058 Patio was treated by School admin with zinc and sulfur prior to EPA + START being on site. OSC-Huyser decided just to have the patio pressure washed and the residual will discharge into the grass. RS

1135 START Stubbs + Partop finished screening Room 707.

1138 START Screening Room 709. Refer to stapled diagram. Highest reading was 187 ng/m^3 . RS

1154 START finished screening room 709. RS

1215 START finished screening Room 710. All readings below 176 ng/m^3 . See diagram for all readings.

1232 START screening Room 605. See stapled diagram for all readings. All readings below 32.4 ng/m^3 .

Scale: 1 square =

11. Stubbs

LaFayette HS Hg Release 11/13/10

1300 START finished screening Room 605. RS

1445 START screening Room 400. See stapled diagram. No reading over 0.0 ng/m^3 .

1515 START finished in Room 400.

~~1520 START began screening upper~~ RS

— START screened Room 604 storage room. See stapled diagram. Highest reading was 924 ng/m^3 . RS

— START screened room 607. See stapled diagram. Highest reading was 0.3 ng/m^3 .

— Room 400 (Computer Room)
— Highest reading 0.1 ng/m^3 .
See attached sketch.

1520 Screened upper level of Gym. Had to leave to assist others.

1645 Continued screening the upper level of the gym. Highest reading was 265 ng/m^3 . See attached diagram.

1720 Completed upper level gym.

11. Stubbs 12/28/10

6 11/13/10 LaFayette HS Hg

1725 START began screening lower level of gym. Highest reading was 272 ng/m^3 . See attached diagram. Gym dust mop was 1700 ng/m^3 and mop was doubled bag and will be disposed of. ~ RS

Later note: at 0830 All START met with school officials: Chris Jones, Elaine Womack, Heather Holloway, Melissa Mathis, Wayne Robinson and OSC - Huyser. ~ RS

- START Berrios screening Boy's Bathroom and got up to 2799 ng/m^3 in the sink area. This was in the 600 wing. The highest reading was 10,330 ng/m^3 at the floor drain. See attached diagram.

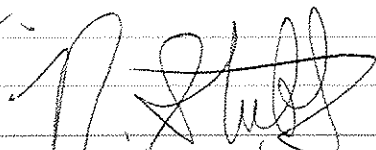
12/28/10

Scale: 1 square=_____

11/13/10 LaFayette HS Hg

- START Berrios screened Junior's closet (near class room # 705). Highest reading at sink drainage at 10,600 ng/m^3 . See attached diagram.
- Screened # 708 + highest reading was 118 ng/m^3 . See attached diagram.
- Screened # 713 + highest reading was 165 ng/m^3 . See attached diagram.
- Screened # 604 and highest reading was 12,000 ng/m^3 from the sink in the teacher's desk. See attached diagram.
- Screened # 502 and highest reading was 588 ng/m^3 . See attached diagram.
- Screened # 505 and highest reading was 241 ng/m^3 . See attached diagrams.

 12/28/10

Scale: 1 square=_____

11/13/10 LaFayette HS Hg

Latnote: at 1552 START Partap & Berrios began screening bag containing used Hg cleanup materials and equipment. Bags were numbered (12 bags total)

Bags:

- AS
- Bag #1 - $> 50,000 \text{ ng/m}^3$
(vacuum cleaner hose)
 - #2 - trash from cleanup - 27,750
 - #3 - Rug-plastic - 19,340
 - #4 - Sulfur (ziplock bag) - 5000
 - #5 - Glass jar/liquid material w/mercury: grass $\approx 40,000$
triple bagged AS
 - #6 - Mercury hazardous; mercury metal; thermometers; Ambert mercury $\approx 10,000$
 - #7 - Wipes, sulfur w/ Hg beads ≈ 5200
 - #8 - Backpack (student) - 750,000
 - #9 - Map - 14,685
 - #10 - Maps - 21,315
 - #11 - Shoes - 11,410
 - #12 - Socks - 28,240
- 12/28/10

Scale: 1 square =

11/13/10 LaFayette HS Hg

Latnote: at 1615 START spoke with OSC-Huyser about high Hg readings from bagged items and items need to be contained and secure pending removal by school contractor (Clean Harbors).

Latnote: at 1630 START spoke with Asst. V.P. (Heather) regarding source container; she indicated using trash can from Room 700 Jantors closet.

Latnote: at 1650 Began to drum Haz waste used to contain mercury spill. AS

Latnote: at 1720 START Stubbs & Partap screened Mobile Unit #2. At doorway it was $5,000 \text{ ng/m}^3$. Highest readings were found on the floor under the chalkboard tray up to $> 100,000 \text{ ng/m}^3$. See attached diagram.

12/28/10

Scale: 1 square =

11/13/10 LaFayette HS Hg

Latnote: At 1930, OSC-Huyser turned heat on and shut windows at 909 Mclemore Street. PS

Latnote: 2030 START completed Screening Mobile Unit #2. Turned heat up to 90°F and shut windows. PS

Latnote: At 2100 Briefed OSC-Buerki as she is taking over for OSC-Huyser. Also met with school superintendent and 2 operations managers from School. Discussed logistics for activities tomorrow.

Latnote: At 2245, START Stubbs screened Mobile Unit #2, after ~3 hours of heating with windows closed. Reading of 17,000 $\mu\text{g}/\text{m}^3$ breathing zone at the entrance.

Latnote: At 2300, All START and OSC-Buerki departed the school and headed to 909 Mclemore Street. R. Stubbs 12/28/10

Scale: 1 square =

11/14/10 LaFayette HS Hg

0900 START arrived at school.

0939 START Berrios + OSC-Buerki Screening Janitor's Closet at School Main admin. office. Sink drainage had the highest reading at 982 $\mu\text{g}/\text{m}^3$. See attached diagram.

1005 Screened Janitor's closet at Cafeteria. Highest reading was from a dust pan at 13,000 $\mu\text{g}/\text{m}^3$. See attached diagram. Drain was 6,332.

1037 Screened Room 802. Highest reading was in the bathroom at 1,244 $\mu\text{g}/\text{m}^3$. See attached diagram. Washer in bathroom was up to 13,870 with mops in place and 5,640 with mops removed. Trash can full of mop heads in storage room were >50,000 $\mu\text{g}/\text{m}^3$.

1224 Screened Janitor's closet in 600 wing. Mop bucket up to 24,510. See attached diagram.

R. Stubbs 12/28/10

Scale: 1 square =

11/14/10 LaFayette HS Hq

1302 START Berrios + OSC-Buerki screened Janitor's closet of 300 wing. Highest reading was from a dust pan at 454 ng/m^3 . See attached diagram. RS

1321 START screened Janitor's closet at 400 wing. Highest reading was in sink at $5,265 \text{ ng/m}^3$. See attached diagram. RS

2315 START arrived back at the school. RS

2333 START Partap + Stubbs found contamination at the band room. Just entering the double doors Lymex was reading around $2,000 \text{ ng/m}^3$. Rug at back door (leads to patio) was $> 50,000$. Rug was then double bagged and placed at Mobile Unit #2.

2351 START Berrios + OSC-Buerki screened Boys lockers area in Gym.

Scale: 1 square = _____

R. Stubbs 12/29/10

11/14/10 LaFayette HS Hq

2351 Shower drains in the Boy's locker room had the highest readings up to $4,200 \text{ ng/m}^3$. See attached diagram.

11/15/10

0029: Screened Room 930 (weight room). Avg. in breathing zone (BZ) was 217 ng/m^3 . See attached diagram. RS

0044: Screened Girls lockers; avg BZ was 384 ng/m^3 . Janitor's closet in Gym had an ambient of 1500 ng/m^3 . mop bucket was $22,900$ and bagged it; wash basin was $750,000$ and second mop bucket was $6,500$.

0120 START EPA + Glenn-Ast. Principal discussed logistics for next school day. START presented a summary of the data of rooms that need

R. Stubbs 12/29/10

Scale: 1 square = _____

11/15/10 LaFayette HS Hg

0120 to be locked during the week. ~~~~~ RS

0215 START took care of relocation of trash bags that needed to be placed at Mobile Unit #2.

0300 START finished activities for now. EPA + START will be at the 1000 hrs meeting at school with ATSDR.

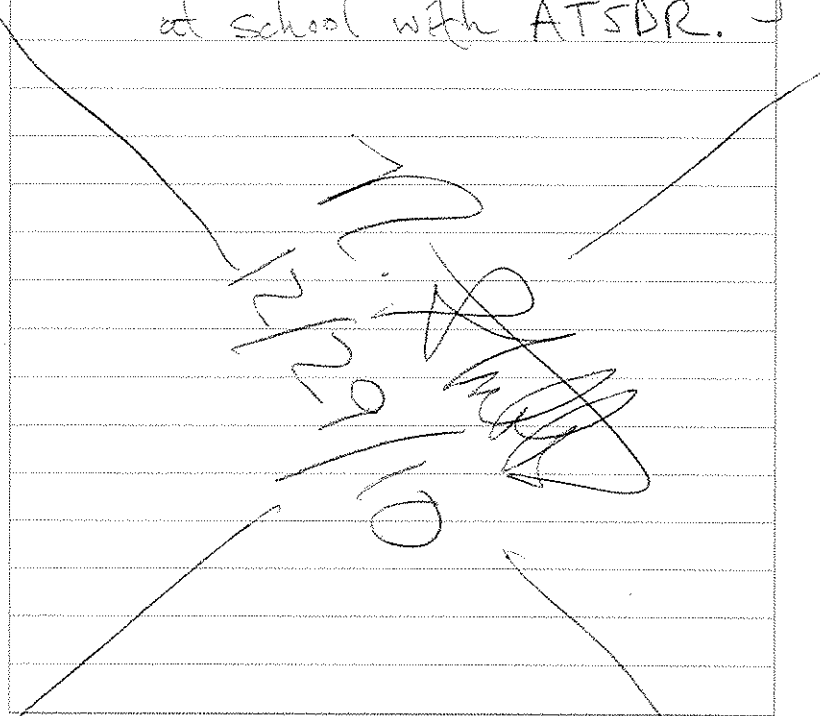

Scale: 1 square=_____

11/14/10 LaFayette HS Hg

0900 Prepare for daily events; held discussions with OSC Buerki; we will concentrate on completing the screening of the school before going to 909 McLenore Street.

0915 Calibrated Lumexs; all cal data in each unit's cal logbook. ~~~~~ RS

1000 START Stubbs and Partap screened Locker #325 and read 200 ng/m^3 .

1005 Screened Locker #326 at 75 ng/m^3 . ~~~~~ RS

1010 Screened wheels of cart we were using and read 60 ng/m^3 . Rescreened Room 607 area in front of teacher's desk. Highest reading was 226 ng/m^3 .

1054 Began screening Room 609.

1058 Completed Room 609.

1100 Screened Room 615 (Lab).

~~12/29/10~~

12/29/10

Scale: 1 square=_____

11/14/10 LaFayette HS Hg

- 1100 Screened Room 615 and highest reading was 211 ng/m^3 in a sink. See attached diagram.
- 1115 START Stubbs & Partap screened Room 611. Highest reading was 118 ng/m^3 . RS
- 1119 Screened Room 608. Highest reading was 82 ng/m^3 .
- 1124 Screened Room 610. Highest reading was 2600 ng/m^3 at a floor drain in back corner of room. See attached diagram. RS
- 1134 Screened Room 606. Highest reading was 111 ng/m^3 .
- 1142 Screened Room 602. Highest reading was 167 ng/m^3 . See attached diagram. RS
- 1149 Screened Room 600. Highest reading was 180 ng/m^3 . RS
- 1203 Screened Room 603. Highest reading was 115 ng/m^3 . RS
- 1226 Screened Room 601. Highest reading was 66 ng/m^3 .

Scale: 1 square =

N. Stubbs

12/29/10

11/14/10 LaFayette HS Hg

- 1238 START Stubbs & Partap screened Room 701. Highest reading was 222 ng/m^3 in floor drain.
- 1258 Screened Room 703. Highest reading was 79 ng/m^3 . RS
- 1306 Screened Room 702. Highest reading was 109 ng/m^3 . RS
- 1311 Screened Room 705. Highest reading was 79 ng/m^3 . RS
- 1319 Screened Room 704. Highest reading was 166 ng/m^3 . RS
- 1330 Screened Room 706. Highest reading was 92 ng/m^3 . RS
- 1339 Screened book storage room. Highest reading was 82 ng/m^3 .
- 1343 Screened Room 711. Highest reading was 153 ng/m^3 . RS
- 1513 Begin Room 700. Highest reading was 149 ng/m^3 . RS
- 1517 Screened Room 509. Highest reading in sink at $5,800 \text{ ng/m}^3$. All other readings below 137 ng/m^3 . RS

N. Stubbs

12/29/10

Scale: 1 square =

11/14/10 Lafayette HS Hg

- 1526 START Stubbs + Partop
Screened Room 507. — NS
Highest reading was 91 ng/m³. — NS
- 1531 Screened Room 503. Highest
reading was 55 ng/m³. — NS
- 1535 Screened Room 501. Highest
reading was 115 ng/m³. — NS
- 1548 Screened Room 500. Highest
reading was 189 ng/m³. — NS
- 1557 Screened Storage Room +
highest reading was 97 ng/m³.
- 1559 Screened Resource Room. — NS
Highest reading was 39 ng/m³.
- 1601 Screened Room 502. Highest
reading was 691 ng/m³. — NS
- 1610 Screened Room 508. Highest
reading was 14 ng/m³. — NS
- 1625 Screened Room 504. Highest
reading was 178 ng/m³. — NS
- 1631 Screened Room 506. Highest
reading was 61 ng/m³. — NS
- 1638 Screened auditorium and
highest reading was 225 ng/m³.
See attached diagram.

Scale: 1 square =

N. Stubbs 12/29/10

11/14/10 Lafayette HS Hg

- 1750 Screened Room 403. Highest
reading was 115 ng/m³.
- 1756 Screened Room 401. Highest
reading was 81 ng/m³.
- 1800 Screened Girls Bathroom
in 400 Wing. Highest
reading was 1206 ng/m³ at
the base of a toilet partition.
See attached diagram.
- 1806 Screened Boys bathroom in the
400 Wing. Highest reading
was 461 ng/m³. — NS
- 1816 Screened 400 Wing Storage
Room. Highest reading was
85 ng/m³. — NS
- 1819 Screened Room 405. Highest
reading was 66 ng/m³.
- 1823 Screened Room 407. Highest
reading was 51 ng/m³.
- 1838 Screened Room 410. Highest
reading was 174 ng/m³.
- 1840 Screened Room 411. Highest
reading was 158 ng/m³.

N. Stubbs 12/29/10

Scale: 1 square =

11/14/10 LaFayette HS Hq

1843 START Stubbs + Partap
Screened Room 408.

Highest reading was 57 ng/m^3 .

1852 Screened Room 406. Highest
reading was 48 ng/m^3 .

1900 Screened Room 402. Highest
reading was 53 ng/m^3 . RS

1930 A teacher pointed out to
START a bottle of HCL with
crystals on the lid. We
recommended Clean Harbors
remove it. RS

2010 Screened Room 301. Highest
reading was 81 ng/m^3 .

2013 Screened Room 303. Highest
reading was 170 ng/m^3 .

2024 Screened Girls bathroom
on 300 Wing. Highest reading
was 375 ng/m^3 . RS

2029 Screened 300 Wing Boy's
bathroom. Highest reading was
 2500 ng/m^3 at the floor drain.

2211 Screened Room 305. Highest
reading was 56 ng/m^3 .

Scale: 1 square =

RS 12/30/10

11/14/10 LaFayette HS Hq

2217 START Stubbs and Partap
Screened Book Storage Room
on 300 Wing. Highest reading
was 41 ng/m^3 . RS

2219 Screened Room 307. Highest
reading was 52 ng/m^3 .

2225 Screened Room 309. Highest
reading was 35 ng/m^3 .

2227 Screened room 312. Highest
reading was 35 ng/m^3 .

2230 Screened Room 310. Highest
reading was 68 ng/m^3 .

2232 Screened Room 308. Highest
reading was 46 ng/m^3 .

2234 Screened Room 314. Highest
reading was 41 ng/m^3 .

2236 Screened Room 306. Highest
reading was 47 ng/m^3 .

2238 Screened Room 304. Highest
reading was 50 ng/m^3 .

2240 Screened Room 302. Highest
reading was 53 ng/m^3 .

2247 Screened Electrical Room.
Highest reading was 205 ng/m^3 .

12.11/03/11 Scale: 1 square =

- 11/14/10 Lafayette HS Hg
- 2248 START Stubbs + Partap Screened Boys Restroom in 200 Wing. Highest reading was 754 ng/m^3 at a floor drain. RS
- 2253 Screened Girls Restroom in 200 Wing. Highest reading was $1,100 \text{ ng/m}^3$ at the floor drain. RS
- 2255 Screened Room 200. Highest reading was 108 ng/m^3 .
- 2301 Screened Room 209. Highest reading was 139 ng/m^3 .
- 2307 Screened Room 207. Vacuum was $2,200 \text{ ng/m}^3$. Trash can was $3,000 \text{ ng/m}^3$. Readings ranged from 120 up to 2164 ng/m^3 throughout the room. RS
- 2353 Screened Room 205. Highest reading was 720 ng/m^3 .
- 2256 Screened Room 203. Highest was 170 ng/m^3 . RS

N. Stubbs 01/03/11

Scale: 1 square =

- 11/15/10 Lafayette HS Hg
- 0002 START Stubbs + Partap Screened control room. Highest reading 183 ng/m^3 . RS
- 0004 Screened Room 201. Highest 232 ng/m^3 . RS
- 0016 Screened Room 118. Highest was 190 ng/m^3 . RS
- 0021 Screened 117. Highest reading was 170 ng/m^3 . RS
- 0023 Screened Room 116. Highest reading was 109 ng/m^3 .
- 0027 Screened Room 120. Highest reading was 131 ng/m^3 .
- 0029 Screened Room 106. Highest reading was 103 ng/m^3 .
- 0037 Screened Room 110. Highest reading was 119 ng/m^3 .
- 0042 Screened Lunch Room. Highest reading was 186 ng/m^3 . See attached diagram. RS
- 0050 Screened Room 805. Highest reading was 190 ng/m^3 in the washer. See attached diagram.

N. Stubbs 01/03/11

Scale: 1 square =

11/15/10 LaFayette HS Hg

0102 START Stubbs & Partap screened Room 119. Highest reading was 124 $\mu\text{g}/\text{m}^3$ RS

0112 Screened Principal's office. Reading was 58 $\mu\text{g}/\text{m}^3$.

0114 Screened Theresa Whitten's office in front of safe and got 167 $\mu\text{g}/\text{m}^3$. RS

0116 Screened Mr. Brown's office (#107) and highest reading was 118 $\mu\text{g}/\text{m}^3$. RS

0120 START, EPA & Glenn met. See pages 13 & 14.

01/03/11

Scale: 1 square = _____

11/15/10 LaFayette HS Hg

1045 START Partap attended meeting with school board members and ATSDR - Bob Safay. Bob indicated if someone has concern of exposure they should be tested.

1150 Mobile #2; possible to clean with solution and remove carpet. Objections with Clean Harbors to remove source. Any items at school will be addressed by Clean Harbors. Remove source then turn heat on and sample.

1243 Meeting completed RS

1435 START Stubbs & Partap on the way to Bus Yard with Chris Jones & EPA to screen buses. RS

1500 Arrived at County Bus Yard. Screened Bus #88. Highest reading was 14 $\mu\text{g}/\text{m}^3$. RS
Screened Bus #49. Highest reading was 6,500 in little trash can near front door. 11/03/11

Scale: 1 square = _____

11/15/10 LaFayette HS Hg

1520 Complete screening Bus # 49.
Removed trash can. ~ RS

1535 Open all windows. ~ RS

1600 Closed all windows. ~ RS

1615 Screened at front door and
got 3,000 ng/m³. Screened
near where the emergency
flares were located and
got 750,000 ng/m³. Bus
will have to be cleaned.1621 Screened Bus #33. Highest
reading was 109 ng/m³.
See attached diagram. ~ RS1702 Rescreened Band Room
(Room 207). Initial Entry
to Room was 1,600 ng/m³.
All readings above 1,200 ng/m³.
See attached diagram.1720 Completed rescreen; Admin
aware of situation.1725 Added haz trash to Mobile
Unit #2. ~ RS1730 Left school to screen
residence at 4577 Hwy 337.

Scale: 1 square =

N. Stubbs 01/03/11

11/15/10 LaFayette HS Hg

1800 START Stubbs & Partap and
OSC-Buerki screened ~ RS
residence at 4577 Hwy
337. House Temp was 73°F.
Highest reading was 282 ng/m³
on the toy house in
girl's bedroom. See attached
diagram. ~ RS

1816 Completed screen. ~ RS

1843 Arrived at 2280 Hwy, residence
of Tracy Gaddard and son
Jon Gaddard. Highest reading
was 600 ng/m³ on Jon's
right sandal. Every other
reading was below 18 ng/m³.
See attached diagram.1900 START headed back to 909
McLennan Street.01/03/11
N. Stubbs

Scale: 1 square =

11/16/10 LaFayette HS Hg
 1220 START Stubbs + Parfep arrived
 at 220 Oak Street with
 EPA to screen residence.
 Daughter of woman from
 909 McLemore St lives here.
 Highest reading was 69 ng/m^3 .
 House temp was 76°F .
 See attached diagram.
 1242 Completed screening. — RS
 1245 Left 220 Oak Street and
 head back to 909 McLemore
 Street. — RS

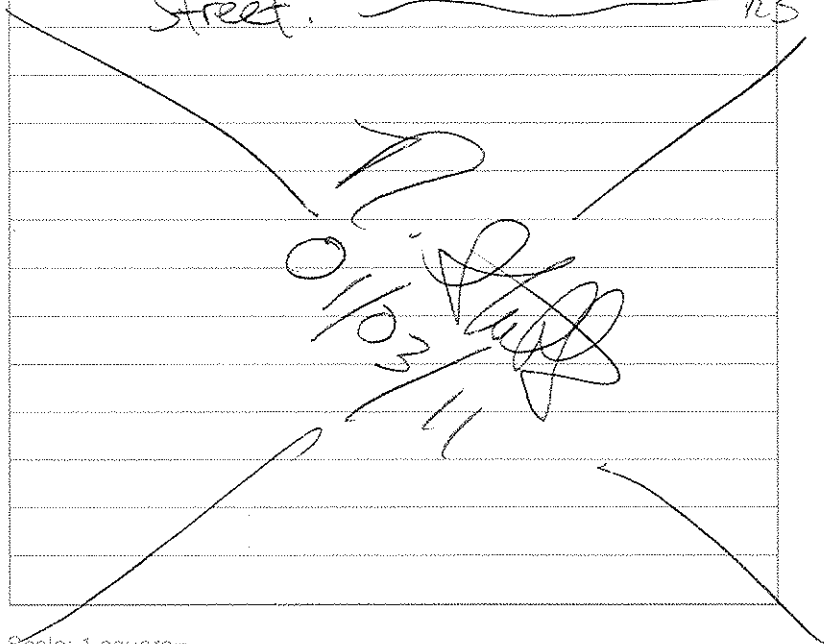

Scale: 1 square=_____

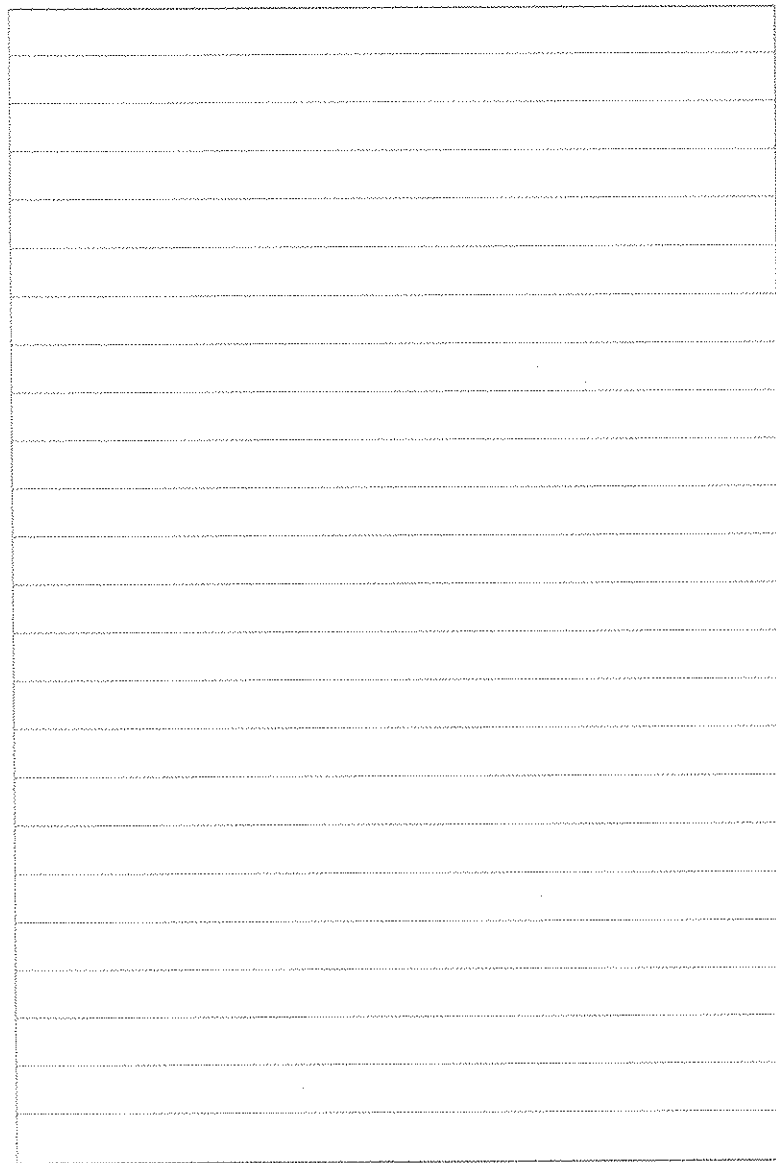

Scale: 1 square=_____