

Appendix A

Figures

Figure 1 – Site Location Map

Figure 2 – Site and Sample Location Map

Figure 3 – PCB and TCE Sample Results Map

Figure 3A – Lead Sample Results Map

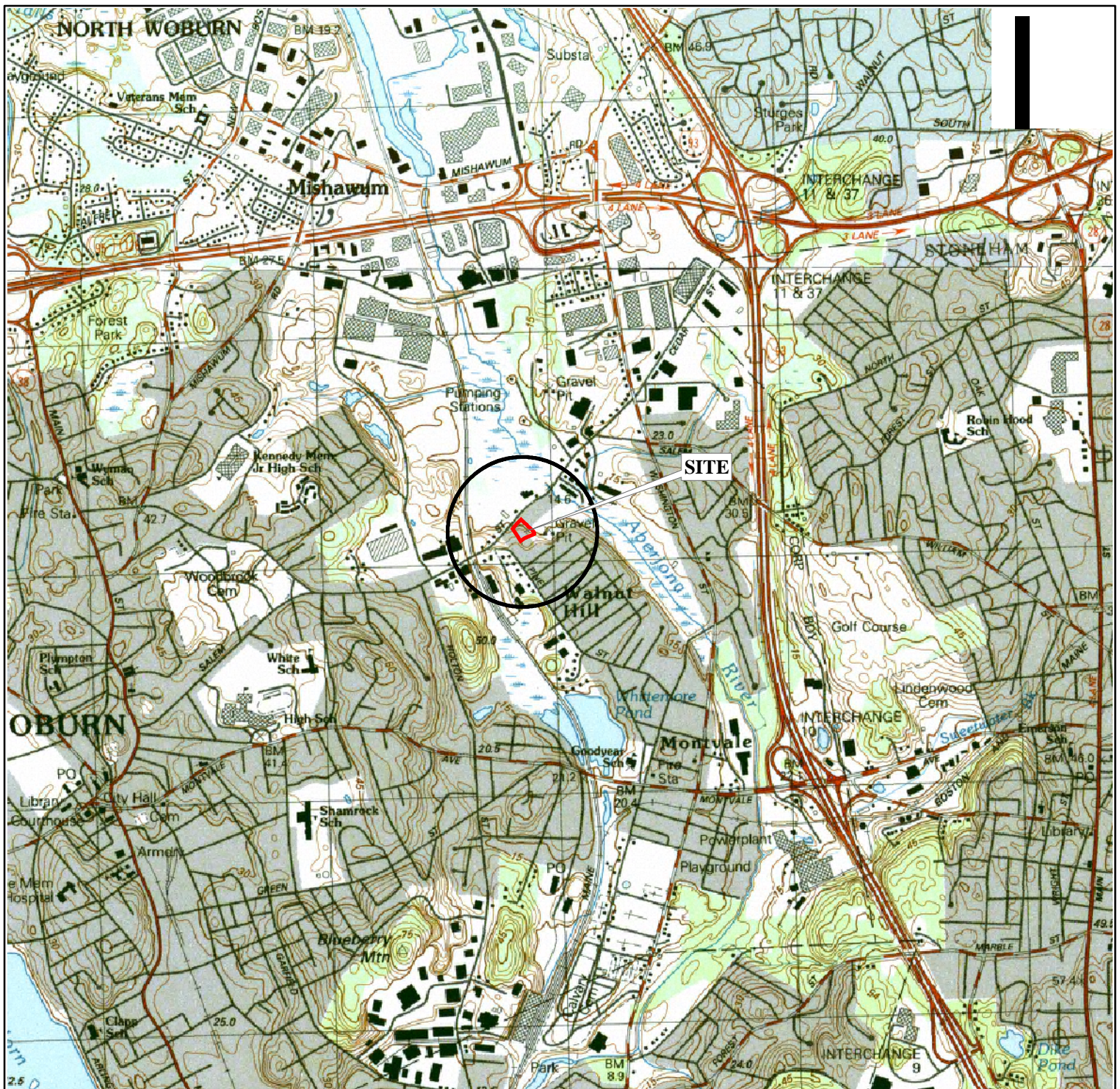

BASE MAP IS A PORTION OF THE FOLLOWING DIGITAL ORTHOGRAPHIC QUARTER QUADRANGLES:
 MassGIS Tiles Q229910.SID, Q229914.SID, Q229918.SID, 233910.SID, Q233914.SID, Q237910.SID, and Q237914.SID.
 Downloaded 10/11/2006.

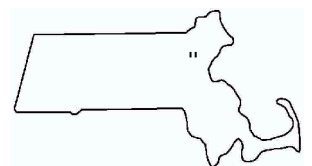
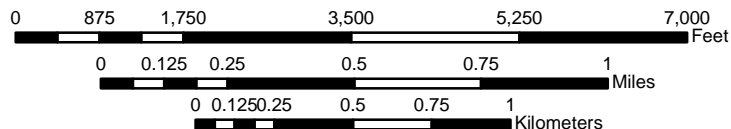

QUADRANGLE LOCATION

SITE LOCATION MAP

MURPHY PROPERTY
 263 SALEM STREET
 WOBURN, MASSACHUSETTS



REGION I SUPERFUND TECHNICAL ASSESSMENT AND RESPONSE TEAM

TDD NUMBER:
 06-07-0008

CREATED BY:
 D. MUZRALL

CREATED ON:
 10/11/2006

FILE LOCATION:

E:\MA_GIS\Murphy_Property_MXDS\Figure 1.MXD

FIGURE 1



SITE AND SAMPLE LOCATION MAP

MURPHY PROPERTY
263 SALEM STREET
WOBURN, MASSACHUSETTS



REGION I SUPERFUND TECHNICAL ASSESSMENT AND RESPONSE TEAM

TDD NUMBER: 06-07-0008	CREATED BY: D. MUZRALL	CREATED ON: 8/29/2006
FILE LOCATION: E:\MA_GIS\Murphy_Property\MXDS\ Figure 2 - Site Map.MXD		FIGURE 2



<div><div>Legend</div><div><div><div>●</div>Soil Sample</div><div><div>■</div>Tank Sample</div></div><div>Polychlorinated biphenyls (PCBs) results are for Total PCBs (aroclers 1254 and 1260), and are displayed in milligrams per Kilogram (mg/Kg). PCB results listed as "0" are non-detects.</div><div>Trichloroethylene (TCE) results are displayed in micrograms per Kilogram (ug/Kg). TCE results are listed only if detected.</div></div>	<div><div>PCB and TCE</div><div>SAMPLE RESULTS MAP</div><div>MURPHY PROPERTY</div><div>263 SALEM STREET</div><div>WOBURN, MASSACHUSETTS</div></div>	<div><div><div>WESTON</div><div>SOLUTIONS</div><div>Restoring Resource Efficiency</div></div><div>REGION I SUPERFUND TECHNICAL ASSESSMENT AND RESPONSE TEAM</div><table><tr><td>TDD NUMBER:<div>06-07-0008</div></td><td>CREATED BY:<div>D. MUZRALL</div></td><td>CREATED ON:<div>10/9/2006</div></td></tr><tr><td colspan="2">FILE LOCATION:<div>E:\MA_GIS\MurphyProperty_MXDs\Figure 3 - Sample Results Map - PCBs-TCE.MXD</div></td><td>FIGURE 3</td></tr></table></div>	TDD NUMBER: <div>06-07-0008</div>	CREATED BY: <div>D. MUZRALL</div>	CREATED ON: <div>10/9/2006</div>	FILE LOCATION: <div>E:\MA_GIS\MurphyProperty_MXDs\Figure 3 - Sample Results Map - PCBs-TCE.MXD</div>		FIGURE 3
TDD NUMBER: <div>06-07-0008</div>	CREATED BY: <div>D. MUZRALL</div>	CREATED ON: <div>10/9/2006</div>						
FILE LOCATION: <div>E:\MA_GIS\MurphyProperty_MXDs\Figure 3 - Sample Results Map - PCBs-TCE.MXD</div>		FIGURE 3						



<div><div>Legend</div><div><div><div><div></div></div><div>Soil Sample</div></div><div><div></div></div><div>Tank Sample</div></div><div><div></div></div><div>Approx. Property Boundary</div></div> <div>All lead results are displayed in milligrams per Kilogram (mg/Kg).</div>	<div><div>LEAD SAMPLE RESULTS MAP</div><div>MURPHY PROPERTY 263 SALEM STREET WOBURN, MASSACHUSETTS</div></div>	<div><div><div><div>WESTON</div><div>SOLUTIONS</div><div>Restoring Resource Efficiency</div></div></div><div><div>REGION I SUPERFUND TECHNICAL ASSESSMENT AND RESPONSE TEAM</div><div><div><div><div>TOD NUMBER:</div><div>06-07-0008</div></div><div><div>CREATED BY:</div><div>D. MUZRALL</div></div><div><div>CREATED ON:</div><div>10/9/2006</div></div></div><div><div><div>FILE LOCATION:</div><div>E:\MA_GIS\MurphyProperty\MXD\Figure 3 - Sample Results Map - Lead.MXD</div></div><div><div>FIGURE 3A</div></div></div></div></div></div>		
--	--	--	--	--